



Known for excellence.
Built on trust.

GEOTECHNICAL
ENVIRONMENTAL
ECOLOGICAL
WATER
CONSTRUCTION
MANAGEMENT

188 Valley Street
Suite 300
Providence, RI 02909
T: 401.421.4140
F: 401.751.8613
www.gza.com

Via E-Mail and U.S. Mail

February 7, 2020
File No. 03.0033554.61

Ms. Crystal Charbonneau
Rhode Island Department of Environmental Management (RIDEM)
Office of Water Resources
235 Promenade Street
Providence, Rhode Island 02908

Re: Notice of Termination (NOT) – WQC No. 16-115 and RIPDES RIR101439
Dike Access Road
121 Terminal Road
Providence, Rhode Island

Dear Ms. Charbonneau:

On behalf of The Narragansett Electric Company d/b/a National Grid (National Grid), GZA GeoEnvironmental, Inc. (GZA) is pleased to present to the Rhode Island Department of Environmental Management (RIDEM) Office of Water Resources (OWR) the attached Notice of Termination (NOT) for the Dike Access Road Project (WQC No. 16-115 and RIPDES RIR101439) located at 121 Terminal Road in Providence, Rhode Island (herein referred to as the "Site"). This Notice of Termination (NOT) is being submitted in accordance with the requirements of the Water Quality Certification (WQC) and the Rhode Island Pollutant Discharge Elimination System (RIPDES) Construction General Permit (CGP) prepared by GZA dated June 29, 2016 and approved by RIDEM in a letter dated August 29, 2016. This NOT is subject to the limitations presented in Attachment A. Final site stabilization was achieved on June 7, 2019. Final construction documentation was completed on January 9, 2020.

GZA performed full time field oversight and quality assurance/quality control (QA/QC) for permit compliance during construction of the stormwater management system and associated Site improvements. Except as noted herein and in the attached, the stormwater management system, which consists of a water quality treatment system, was installed in accordance with the stormwater management plan and associated design drawings approved by RIDEM on August 29, 2016.

Construction as-built plans are presented as Attachment B. The construction as-built plans were prepared by Tauper Land Survey Inc. The final surface cover and stormwater system are depicted on the attached GZA Plan Set.

The signed Notice of Termination Form is provided in Attachment C. We note the drainage to the stormwater system was minimally altered from the original design by adding asphalt curbs to promote drainage to the treatment system.

Note that in accordance with WQC No. 16-115 and RIPDES RIR101439, National Grid is following the Operations and Maintenance Plan dated August 11, 2016 prepared as part of permitting for the Dike Access Road Project.



DEVIATIONS FROM THE RIDEM-APPROVED WQC

The following modifications were made to the RIDEM-approved stormwater management plan and are shown on the construction as-built plans provided in Attachment B:

1. The access road was equipped with two asphalt berms to direct runoff to the deep sump catch basin.

Should you have any questions or comments regarding the information presented herein, please do not hesitate to contact either of the undersigned or William Howard (National Grid) at (401) 784-7490.

Very truly yours,
GZA GEOENVIRONMENTAL, INC.

A handwritten signature in black ink, appearing to read 'S. Haupt'.

Sara Haupt, P.E.^(RI)
Assistant Project Manager

A handwritten signature in blue ink, appearing to read 'Igor Runge'.

Igor Runge, Ph.D.
Consultant Reviewer

A handwritten signature in blue ink, appearing to read 'M. Kilpatrick'.

Margaret Kilpatrick, P.E.^(RI)
Associate Principal

Attachments:

Attachment A – Limitations
Attachment B – Stamped As-Built Plans and GZA Site Plans
Attachment C – Notice of Termination Form

CC: William Howard, National Grid

j:\env\33554.61.sn\reports\wqc not\33554.6 wqc not final.docx



ATTACHMENT A

LIMITATIONS

GEOHYDROLOGICAL LIMITATIONS

1. This *Letter* has been prepared on behalf of and for the exclusive use of National Grid, solely for use in documenting the conditions observed at the property located at 642 Allens Avenue/121 Terminal Road in Providence, Rhode Island ("Site"). This letter and the findings contained herein shall not, in whole or in part, be disseminated or conveyed to any other party, nor used by any other party in whole or in part, without the prior written consent of GZA or National Grid.
2. GZA's work was performed in accordance with generally accepted practices of other consultants undertaking similar studies at the same time and in the same geographical area, and GZA observed that degree of care and skill generally exercised by other consultants under similar circumstances and conditions. GZA's findings and conclusions must be considered not as scientific certainties, but rather as our professional opinion concerning the significance of the limited data gathered during the course of the study. No other warranty, express or implied is made. Specifically, GZA does not and cannot represent that the Site contains no hazardous material, oil, or other latent condition beyond that observed by GZA during the performance of our Site investigations.
3. The observations described in this report were made under the conditions stated therein. The conclusions presented in the report were based upon services performed and observations made by GZA.



ATTACHMENT B

STAMPED AS-BUILT PLANS AND GZA SITE PLANS

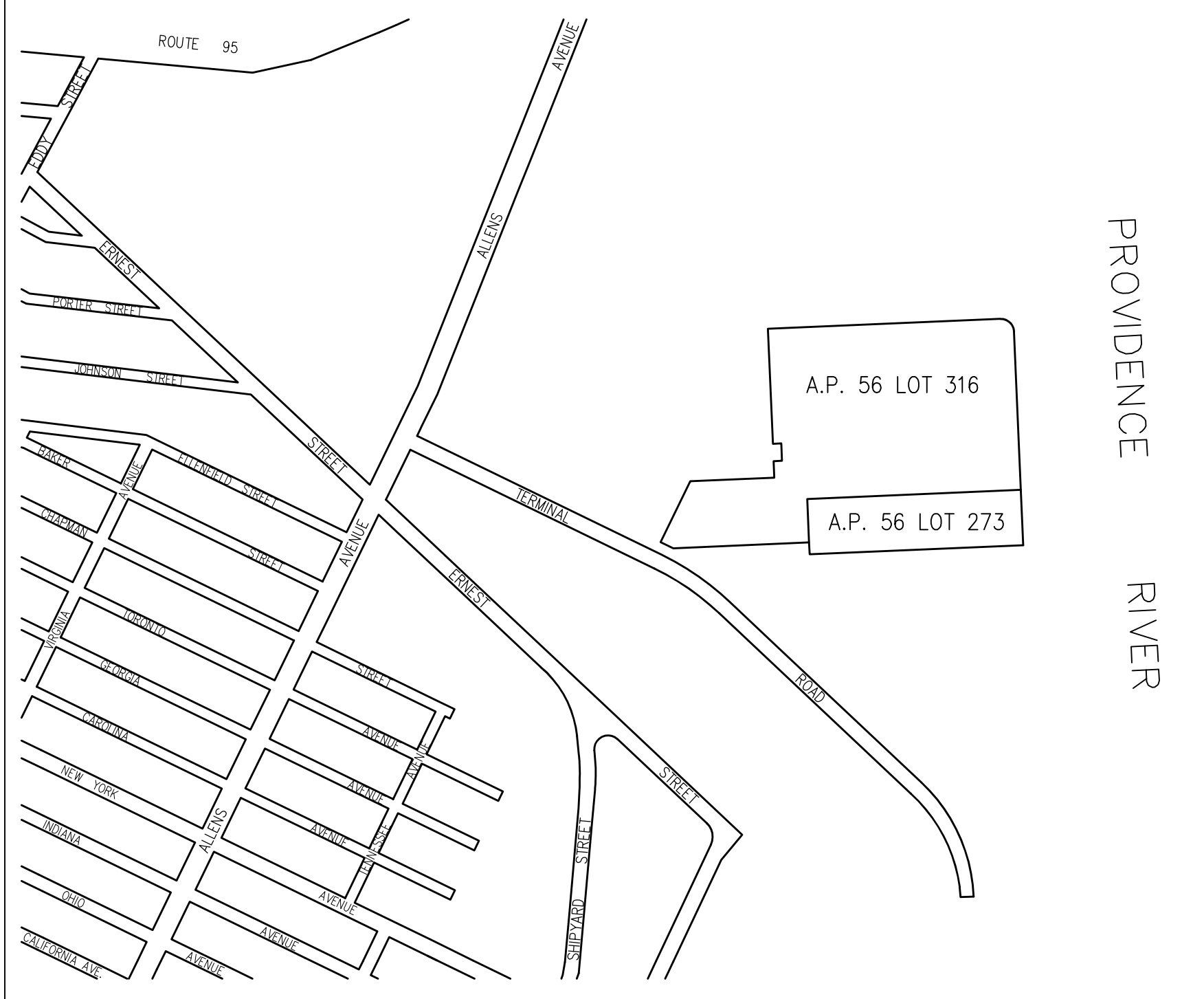

LOCUS MAP
SCALE: 1"=500'

- LEGEND**
- IRON PIPE FOUND
 - DRILL HOLE FOUND
 - STONE OR CONCRETE MONUMENTS
 - SEWER MANHOLE
 - DRAIN MANHOLE
 - ELECTRIC MANHOLE
 - TELEPHONE MANHOLE
 - UNIDENTIFIED MANHOLE
 - CATCH BASIN
 - CLEANOUT
 - MONITORING WELL
 - ANCHOR
 - UTILITY POLE
 - WATER GATE VALVE
 - WATER SHUT OFF
 - HYDRANT
 - BENCHMARK
 - GAS VALVE
 - SIGN
 - LIGHT POLE / LAMP POST
 - SPOT LIGHT
 - FLAG POLE
 - MAILBOX (MBX)
 - BOLLARD
 - SHRUBS, BUSHES, ETC.
 - DECIDUOUS TREE
 - CONIFEROUS TREE
 - WETLAND FLAG
 - BOULDER
 - VERTICAL GRANITE CURBING
 - CONCRETE CURBING
 - CAPE COD BERM (BITUMINOUS)
 - BITUMINOUS CURBING (GENERIC)
 - SLOPED GRANITE CURBING
 - ELECTRIC LINE
 - SEWER LINE
 - DRAIN LINE
 - WATER LINE
 - GAS LINE
 - TELEPHONE WIRE
 - CABLE TELEVISION
 - CONTROL WIRE
 - SITE LIGHTING
 - CCTV/SECURITY
 - UNKNOWN
 - END OF INFORMATION
 - STONE WALL
 - EDGE OF PAVEMENT
 - FENCING (AS NOTED)
 - GUARD RAILING (AS NOTED)
 - TREE LINE
 - EDGE OF LANDSCAPING

A.P. 56 LOT 316
712,830± SQ. FT.
16.36432± ACRES

NOW OR FORMERLY
THE NARRAGANSETT ELECTRIC COMPANY
Bk. 8243 Pg. 243
ASSESSORS PLAT 56 LOT 316
A.P. 56 LOT 316
N/F THE NARRAGANSETT
ELECTRIC COMPANY
BOOK 8243 PAGE 243
BOOK 470 PAGE 224
SEE 1168/429
SEE LEASE 1168/418

NOW OR FORMERLY
THE NARRAGANSETT ELECTRIC COMPANY
Bk. 8243 Pg. 243
ASSESSORS PLAT 56 LOT 316

LEASE LINE TAKEN FROM PLAN ENTITLED
"National Grid LNG Terminal Road LNG Facility"
prepared by VHS Vantage Hogen Brustin, Inc. &
dated March 10, 2014.

A.P. 56 LOT 273
N/F THE NARRAGANSETT
ELECTRIC COMPANY
BOOK 8243 PAGE 243
BOOK 470 PAGE 224
SEE LEASE 1105/239
SEE CONVEYANCE OF BUILDINGS,
STRUCTURES & IMPROVEMENTS 9133/168

A.P. 56 LOT 273
170,099± SQ. FT.
3.90495± ACRES

NOW OR FORMERLY
HOLCIM US INC.
Bk. 9133 Pg. 168
ASSESSORS PLAT 56 LOT 273

PLAN NOTES:

- 1.) THIS PLAN DEPICTS ONLY THOSE FEATURES THAT WERE VISUALLY APPARENT AT THE TIME OF THE SURVEY. THE ABSENCE OF SUBSURFACE STRUCTURES, UTILITIES, ETC. IS NOT INTENDED OR IMPLIED.
- 2.) PRIOR TO ANY EXCAVATION, THE CONTRACTOR SHALL CONTACT DIG-SAFE AT 1-888-344-7233 AND OBTAIN A DIG-SAFE NUMBER AT LEAST 72 HOURS PRIOR TO INITIATING WORK.
- 3.) HORIZONTAL DATUM IS RHODE ISLAND STATE PLANE NAD83.

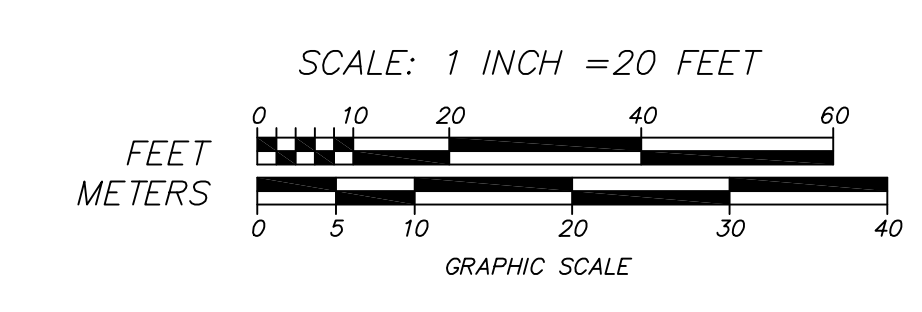

THIS SURVEY HAS BEEN CONDUCTED AND THE PLAN HAS BEEN PREPARED PURSUANT TO SECTION 9 OF THE RULES AND REGULATIONS ADOPTED BY THE RHODE ISLAND BOARD OF REGISTRATION FOR PROFESSIONAL LAND SURVEYORS ON NOVEMBER 25, 2015.
LIMITED CONTENT BOUNDARY SURVEY (CLASS II)
TOPOGRAPHIC SURVEY (CLASS III)
NOT A VALID ORIGINAL DOCUMENT UNLESS EMBOSSED WITH RAISED IMPRESSION OR STAMPED WITH BLACK INK SEAL



JAMEL L. SARDELLI
12-30-2019
DATE

EXISTING CONDITIONS
PLAN OF LAND FOR
NATIONAL GRID LNG FACILITY
39 TERMINAL ROAD
PROVIDENCE, RI
02907

TAUPPER LAND SURVEY INC.
710 MAIN STREET, OXFORD, MA 01537
TEL: 508-867-2286 FAX: 508-234-7723

Prepared For:
The Narragansett
Electric Company
d/b/a/nationalgrid

NO.	DATE	VERSION DESCRIPTION	SHEET
1			1
2			2
3			3
4			4
5			5
6			6
7			7

11 20,337± SQ. FT.
0.46688± ACRES

810.00' S 42°27'08" E
482.59'
900.00' S 42°27'08" E
CLOSURE LINE

PART OF A.P. 56 LOT 5
N/F THE NARRAGANSETT
ELECTRIC COMPANY
BOOK 8243 PAGE 243
BOOK 470 PAGE 224

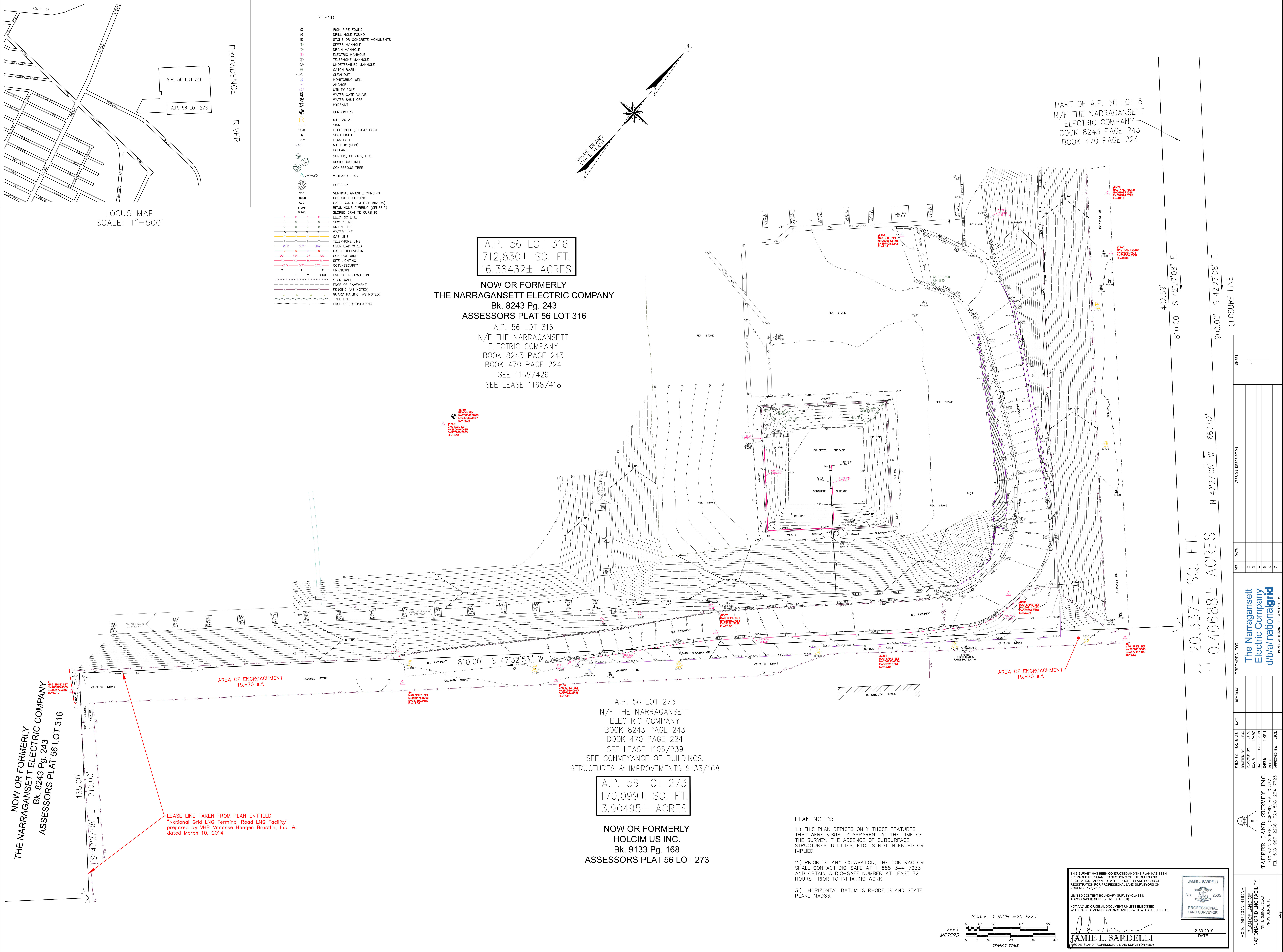

NATIONAL GRID

DIKE ACCESS ROAD PERMIT CLOSEOUT

642 ALLENS AVENUE PROVIDENCE, RHODE ISLAND

FEBRUARY 2020

PREPARED FOR:

[nationalgrid](http://nationalgrid.com)

PREPARED BY:

GZA GEOENVIRONMENTAL, INC.
188 VALLEY STREET, SUITE 300
PROVIDENCE, RHODE ISLAND 02909

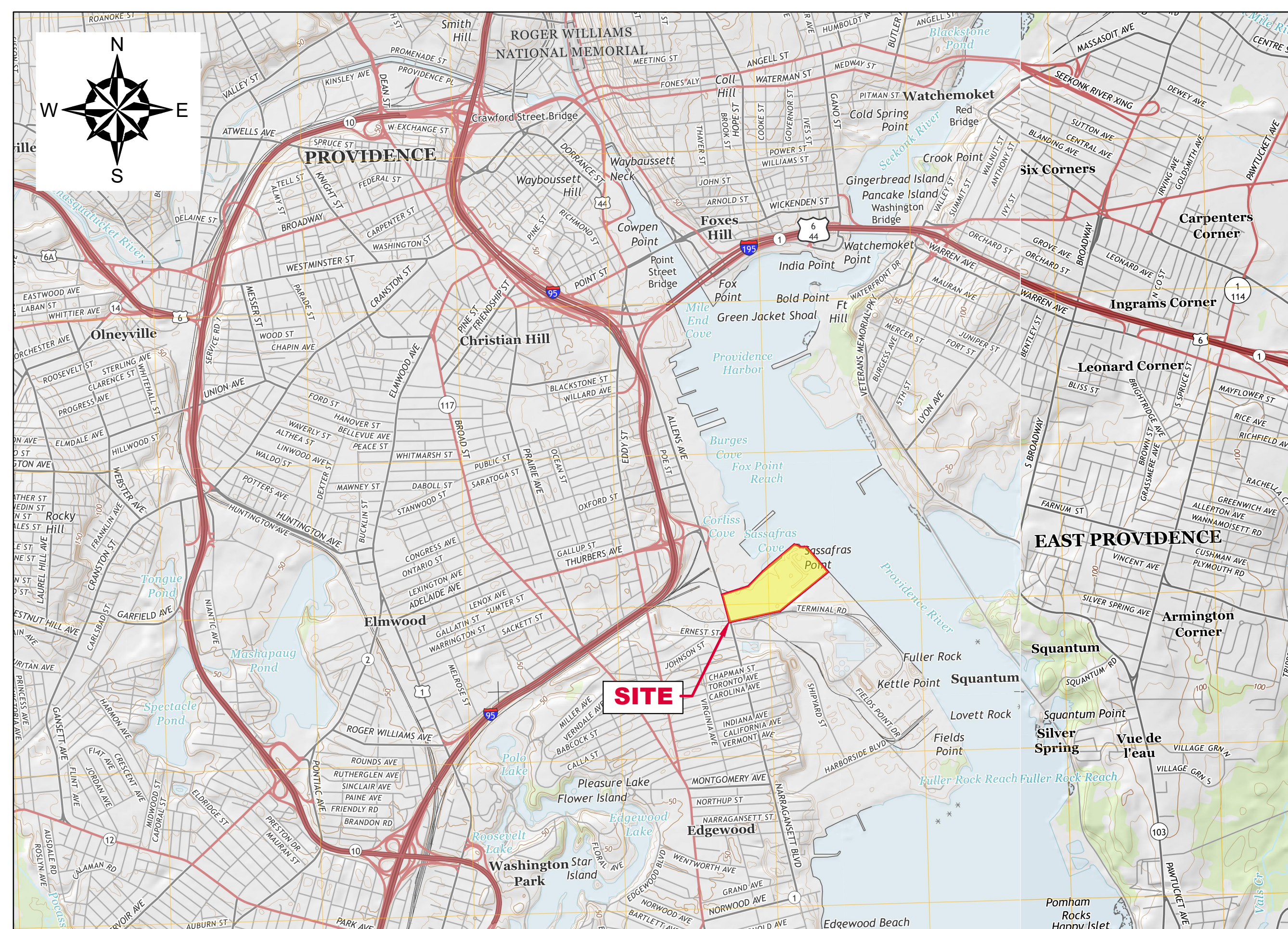

LOCUS MAP

SOURCE: USGSSTORE.GOV

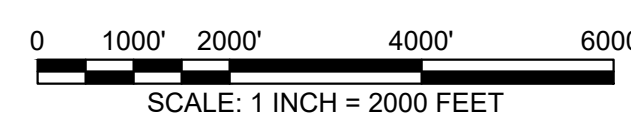

INDEX OF DRAWINGS	
SHEET #	TITLE
1	COVER SHEET, LOCUS AND INDEX TO DRAWINGS
2	OVERALL AERIAL
3	PRE-CONSTRUCTION SITE PLAN
4	EXPLORATION LOCATION PLAN
5	REMEDIAL CAP FINAL GRADING PLAN
6	INSTALLED UTILITIES AND STORMWATER MANAGEMENT PLAN
7	REMEDIAL CAP DETAILS

FOR PERMITTING ONLY

THE INFORMATION SHOWN ON THE DRAWING IS SOLELY FOR USE BY NATIONAL GRID OR THE NATIONAL GRID'S DESIGNATED REPRESENTATIVE FOR THE SPECIFIC PROJECT AND LOCATION IDENTIFIED ON THE DRAWING. THE DRAWING SHALL NOT BE TRANSFERRED, REUSED, COPIED, OR ALTERED IN ANY MANNER FOR USE AT ANY OTHER LOCATION OR FOR ANY OTHER PURPOSE WITHOUT THE PRIOR WRITTEN CONSENT OF GZA AND NATIONAL GRID. ANY TRANSFER, REUSE, OR MODIFICATION TO THE DRAWING BY OTHERS, WITHOUT THE PRIOR WRITTEN EXPRESS CONSENT OF GZA AND NATIONAL GRID, WILL BE AT THE USER'S SOLE RISK AND WITHOUT ANY RISK OR LIABILITY TO GZA AND NATIONAL GRID.

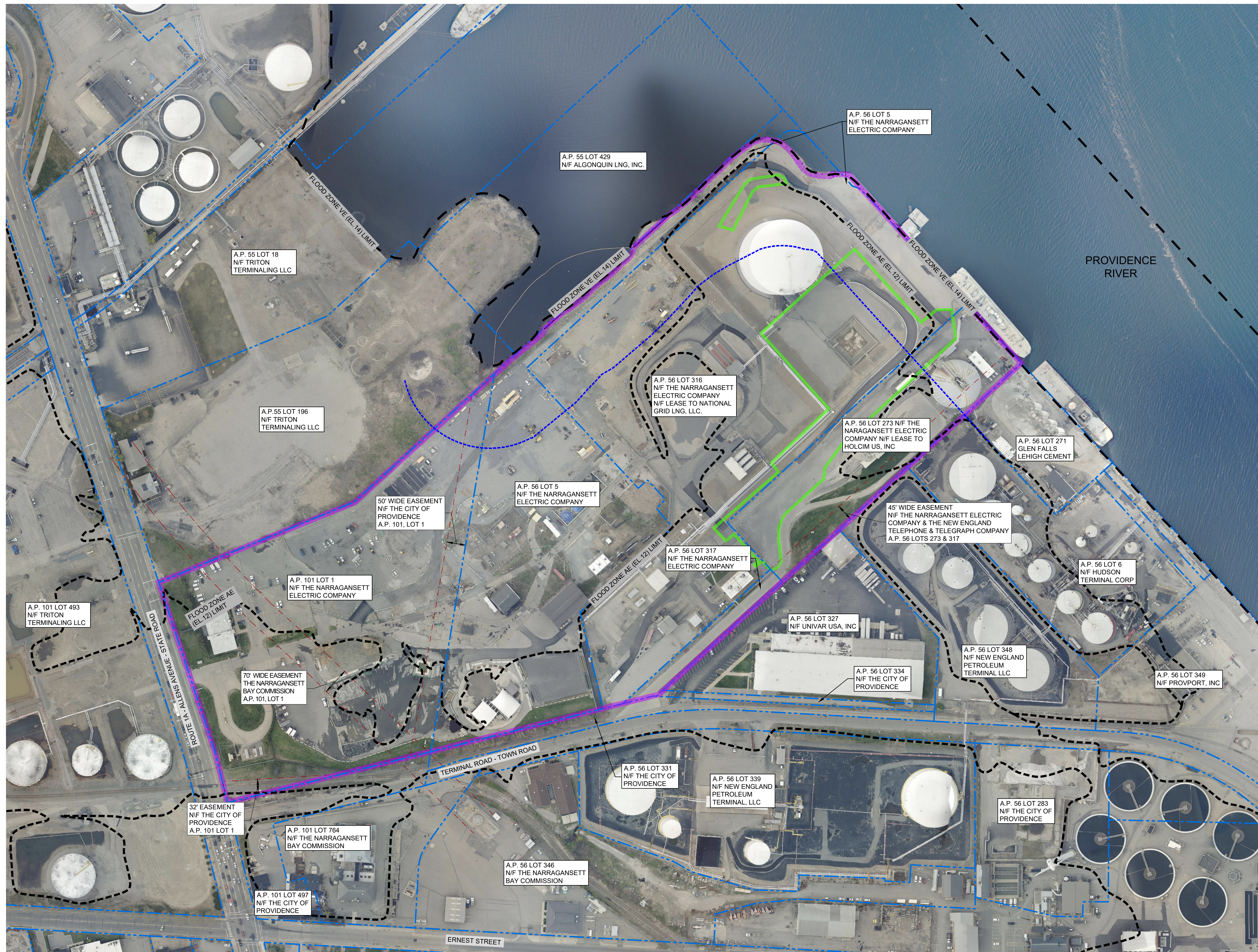

- LEGEND:**
- PROPERTY LINES
 - 642 ALLENS AVENUE FORMER MGP SITE
 - CRMC 200-FOOT JURISDICTIONAL LINE
 - STRA AREA
 - EASEMENT AREA
 - FLOOD ZONE VE (EL. 14) LIMIT
 - FLOOD ZONE AE (EL. 12) LIMIT

- REFERENCE NOTES:**
1. BASE MAP DEVELOPED FROM RHODE ISLAND'S RIGIS AERIAL IMAGERY PUBLISHED IN APRIL 2019.
 2. PROPERTY LINES AND LOT INFORMATION ESTABLISHED FROM INFORMATION PROVIDED ON A DRAWING ENTITLED "EXISTING CONDITIONS PLAN," PROJECT TITLE "NATIONAL GRID LNG TERMINAL ROAD LNG FACILITY" DATED MARCH 10, 2014, ORIGINAL SCALE 1" = 50', DRAWING NO. SV-1 THROUGH SV-3 AND AERIAL MAPPING BY WSP TRANSPORTATION AND INFRASTRUCTURE DATED JANUARY 15, 2014 PREPARED FOR NATIONAL GRID LAND SURVEYING DEPARTMENT, WALTHAM, MASSACHUSETTS AND CAD FILE NO. 09303023.052-1.DWG. PLANS PROVIDED BY NATIONAL GRID.
 3. EASEMENT LOCATIONS WERE DEVELOPED FROM THE FOLLOWING:
 - ELECTRONIC CAD FILE "ACAD-7257PL.DWG" PROVIDED BY VANASSE HANGEN BRUSTLIN (VHB) ENTITLED "EXISTING CONDITIONS PLAN," PROJECT TITLE "NATIONAL GRID LNG TERMINAL ROAD LNG FACILITY" DATED MARCH 10, 2014, ORIGINAL SCALE 1" = 50', DRAWING NO. SV-1 THROUGH SV-3 AND AERIAL MAPPING BY WSP TRANSPORTATION AND INFRASTRUCTURE DATED JANUARY 15, 2014 PREPARED FOR NATIONAL GRID LAND SURVEYING DEPARTMENT, WALTHAM, MASSACHUSETTS AND CAD FILE NO. 09303023.052-1.DWG. PLANS PROVIDED BY NATIONAL GRID.
 - DESCRIPTIONS PROVIDED IN THE CITY OF PROVIDENCE DEED BOOK (BK) 470 PAGES 224 - 229, BK 561 PAGES 326 - 328, BK 1111 PAGES 752 - 756 AND BK 5249 PAGES 219 - 322.
 4. FLOOD ZONE HAZARD AREA DATA WERE PROVIDED BY RHODE ISLAND GEOGRAPHIC INFORMATION SYSTEM (RIGIS) AND DERIVED FROM STATEWIDE DIGITAL FLOOD INSURANCE RATE MAP (DFIRM) DATABASE, ORIGINALLY PUBLISHED BY FEMA IN OCTOBER 2015.
 5. SITE BOUNDARIES ARE APPROXIMATE.

FOR PERMITTING ONLY

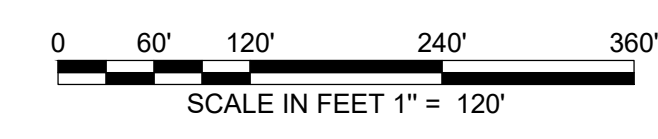
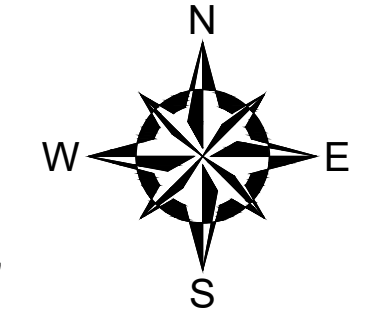

THE INFORMATION SHOWN ON THE DRAWING IS SOLELY FOR USE BY NATIONAL GRID OR THE NATIONAL GRID'S DESIGNATED REPRESENTATIVE FOR THE SPECIFIC PROJECT AND LOCATION IDENTIFIED ON THE DRAWING. THE DRAWING SHALL NOT BE TRANSFERRED, REUSED, COPIED, OR ALTERED IN ANY MANNER FOR USE AT ANY OTHER LOCATION OR FOR ANY OTHER PURPOSE WITHOUT THE PRIOR WRITTEN CONSENT OF GZA AND NATIONAL GRID. ANY TRANSFER, REUSE, OR MODIFICATION TO THE DRAWING BY OTHERS, WITHOUT THE PRIOR WRITTEN EXPRESS CONSENT OF GZA AND NATIONAL GRID, WILL BE AT THE USER'S SOLE RISK AND WITHOUT ANY RISK OR LIABILITY TO GZA AND NATIONAL GRID.

NATIONAL GRID			
DIKE ACCESS ROAD PERMIT CLOSEOUT 642 ALLENS AVENUE PROVIDENCE, RHODE ISLAND			
OVERALL AERIAL			
<small>PREPARED BY:</small>		<small>PREPARED FOR:</small>	
GZA GeoEnvironmental, Inc. Engineers and Scientists <small>www.gza.com</small>		nationalgrid	
<small>PROJ MGR:</small> SN	<small>REVIEWED BY:</small> SN	<small>CHECKED BY:</small> SN	<small>FIGURE</small>
<small>DESIGNED BY:</small> SN	<small>DRAWN BY:</small> LDT	<small>SCALE:</small> AS NOTED	2
<small>DATE:</small>	<small>PROJECT NO.</small>	<small>REVISION NO.</small>	
FEBRUARY 2020	33554.61	---	<small>SHEET NO. 2 OF 7</small>

2020 - GZA GeoEnvironmental, Inc. GZA-33554.61_SVN_FIGURES_CAD_DRAWING_33554.61_OVERALL_AERIAL_DRAWING_OVERALL_AERIAL_FEBRUARY_4_2020_2:01 PM USA THERMAL

2020 - GZA GeoEnvironmental, Inc. - GZA - 33554.61.DWG - SITE PERMITTING PLAN - FEBRUARY 4, 2020 2:07 PM LISA THERIAULT

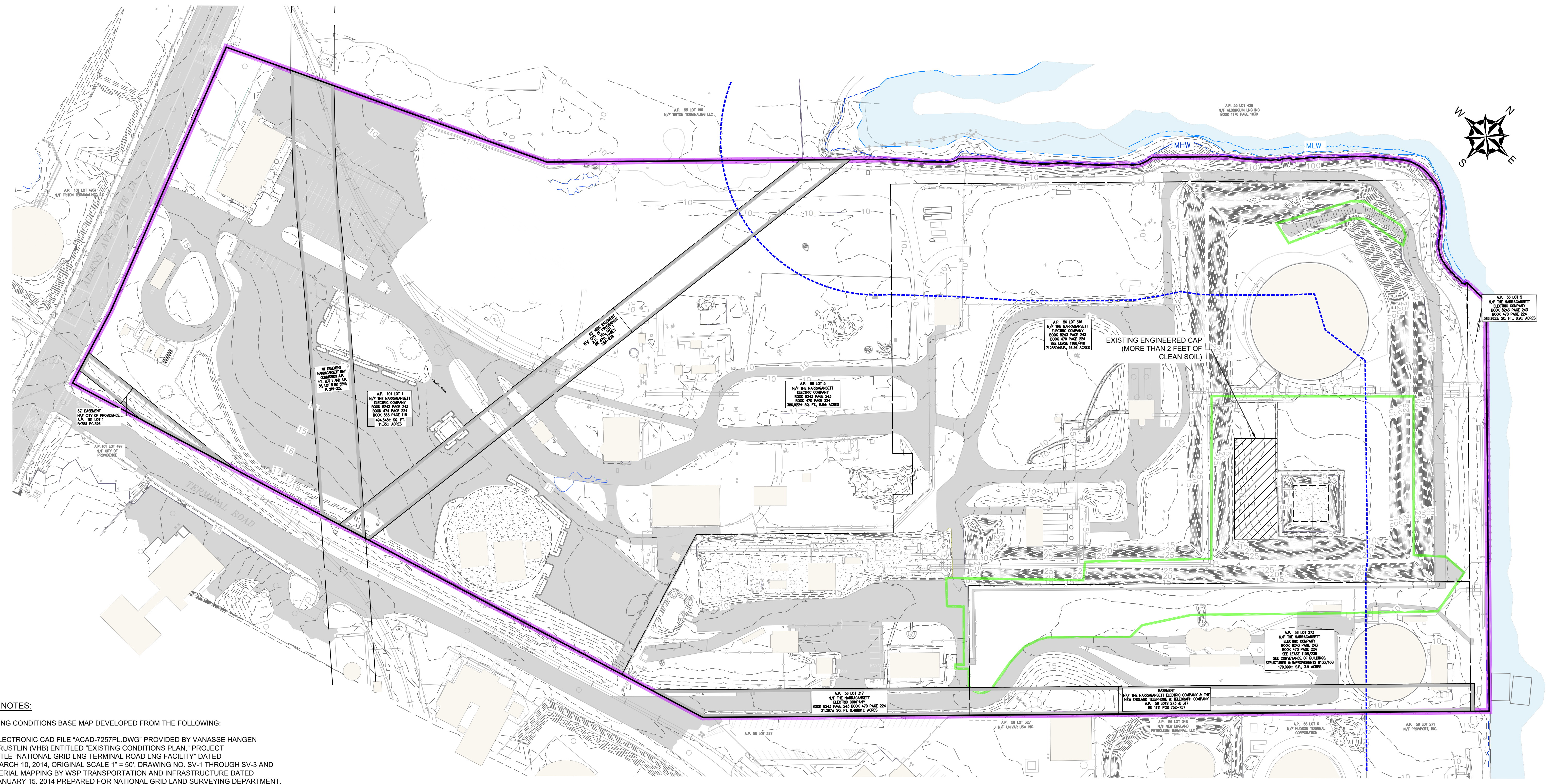

GENERAL NOTES:

- 1) EXISTING CONDITIONS BASE MAP DEVELOPED FROM THE FOLLOWING:
 - ELECTRONIC CAD FILE "ACAD-7257PL.DWG" PROVIDED BY VANASSE HANGEN BRUSTLIN (VHB) ENTITLED "EXISTING CONDITIONS PLAN," PROJECT TITLE "NATIONAL GRID LNG TERMINAL ROAD LNG FACILITY" DATED MARCH 10, 2014, ORIGINAL SCALE 1" = 50', DRAWING NO. SV-1 THROUGH SV-3 AND AERIAL MAPPING BY WSP TRANSPORTATION AND INFRASTRUCTURE DATED JANUARY 15, 2014 PREPARED FOR NATIONAL GRID LAND SURVEYING DEPARTMENT, WALTHAM, MASSACHUSETTS AND CAD FILE NO. 09303023.052-1.DWG
 - ELECTRONIC CAD FILE "3654 642 ALLENS AVE ASBUILT.DWG", PREPARED BY A-PLUS CONSTRUCTION SERVICES CORPORATION FOR CHARTER ENVIRONMENTAL, TITLED "AS-BUILT PLAN," SHEET 1 TITLED "SUB GRADE" AND SHEET 2 TITLED "FINISH GRADE," DATED DECEMBER 16, 2016 AND PROVIDED TO GZA ON MARCH 23, 2017
 - ON-SITE INVESTIGATIONS AND SURVEYS BY GZA PERSONNEL DURING VARIOUS SITE VISITS BETWEEN 2011 AND 2019.
- 2) PROPERTY LINES AND LOT INFORMATION ESTABLISHED FROM INFORMATION PROVIDED ON A DRAWING ENTITLED "EXISTING CONDITIONS PLAN," PROJECT TITLE "NATIONAL GRID LNG TERMINAL ROAD LNG FACILITY" DATED MARCH 10, 2014, ORIGINAL SCALE 1" = 50', DRAWING NO. SV-1 THROUGH SV-3.
- 3) SITE BOUNDARIES ARE APPROXIMATE.
- 4) HORIZONTAL DATUM IS BASED ON NAD 1983 FROM BASE MAPPING PROVIDED BY VHB.
- 5) VERTICAL DATUM IS BASED ON NAVD 1988 FROM BASE MAPPING PROVIDED BY VHB.
- 6) EASEMENT LOCATIONS WERE DEVELOPED FROM THE FOLLOWING:
 - ELECTRONIC CAD FILE "ACAD-7257PL.DWG" PROVIDED BY VANASSE HANGEN BRUSTLIN (VHB) ENTITLED "EXISTING CONDITIONS PLAN," PROJECT TITLE "NATIONAL GRID LNG TERMINAL ROAD LNG FACILITY" DATED MARCH 10, 2014, ORIGINAL SCALE 1" = 50', DRAWING NO. SV-1 THROUGH SV-3 AND AERIAL MAPPING BY WSP TRANSPORTATION AND INFRASTRUCTURE DATED JANUARY 15, 2014 PREPARED FOR NATIONAL GRID LAND SURVEYING DEPARTMENT, WALTHAM, MASSACHUSETTS AND CAD FILE NO. 09303023.052-1.DWG. PLANS PROVIDED BY NATIONAL GRID.
 - DESCRIPTIONS PROVIDED IN THE CITY OF PROVIDENCE DEED BOOK (BK) 470 PAGES 224 - 229, BK 561 PAGES 326 - 328, BK 1111 PAGES 752 -756 AND BK 5249 PAGES 219 - 322.



LEGEND:

	EXISTING STRUCTURE		MHW	MEAN HIGH WATER
	EXISTING CONTOUR (MAJOR 5 FOOT INTERVAL)		MLW	MEAN LOW WATER
	EXISTING CONTOUR (MINOR 1 FOOT INTERVAL)			ABUTTING PROPERTY LINE
	PAVEMENT			EDGE OF WATER
	EASEMENT AREA			EXISTING RAILROAD TRACKS
	PROPERTY LINE			EXISTING FENCE
	INTERIOR PROPERTY LINE			EXISTING CONCRETE PAD
	STRA AREA			UTILITY POLE
	200-FOOT CRMC JURISDICTIONAL LIMIT			LIGHT POLE
	642 ALLENS AVENUE FORMER MGP SITE			HYDRANT

FOR PERMITTING ONLY

THE INFORMATION SHOWN ON THE DRAWING IS SOLELY FOR USE BY NATIONAL GRID OR THE NATIONAL GRID'S DESIGNATED REPRESENTATIVE FOR THE SPECIFIC PROJECT AND LOCATION IDENTIFIED ON THE DRAWING. THE DRAWING SHALL NOT BE TRANSFERRED, REUSED, COPIED, OR ALTERED IN ANY MANNER FOR USE AT ANY OTHER LOCATION OR FOR ANY OTHER PURPOSE WITHOUT THE PRIOR WRITTEN CONSENT OF GZA AND NATIONAL GRID. ANY TRANSFER, REUSE, OR MODIFICATION TO THE DRAWING BY OTHERS, WITHOUT THE PRIOR WRITTEN EXPRESS CONSENT OF GZA AND NATIONAL GRID, WILL BE AT THE USER'S SOLE RISK AND WITHOUT ANY RISK OR LIABILITY TO GZA AND NATIONAL GRID.

NATIONAL GRID			
DIKE ACCESS ROAD PERMIT CLOSEOUT 642 ALLENS AVENUE PROVIDENCE, RHODE ISLAND			
PRE-CONSTRUCTION SITE PLAN			
PREPARED BY: GZA GeoEnvironmental, Inc. Engineers and Scientists www.gza.com	PREPARED FOR: nationalgrid	DESIGNED BY: SN	FIGURE
REVIEWED BY: SN	DRAWN BY: LDT	CHECKED BY: SN	SCALE: AS NOTED
DATE: FEBRUARY 2020	PROJECT NO.: 33554.61	REVISION NO.: 0	REVISION NO.: 0
			3
			SHEET NO. 3 OF 7

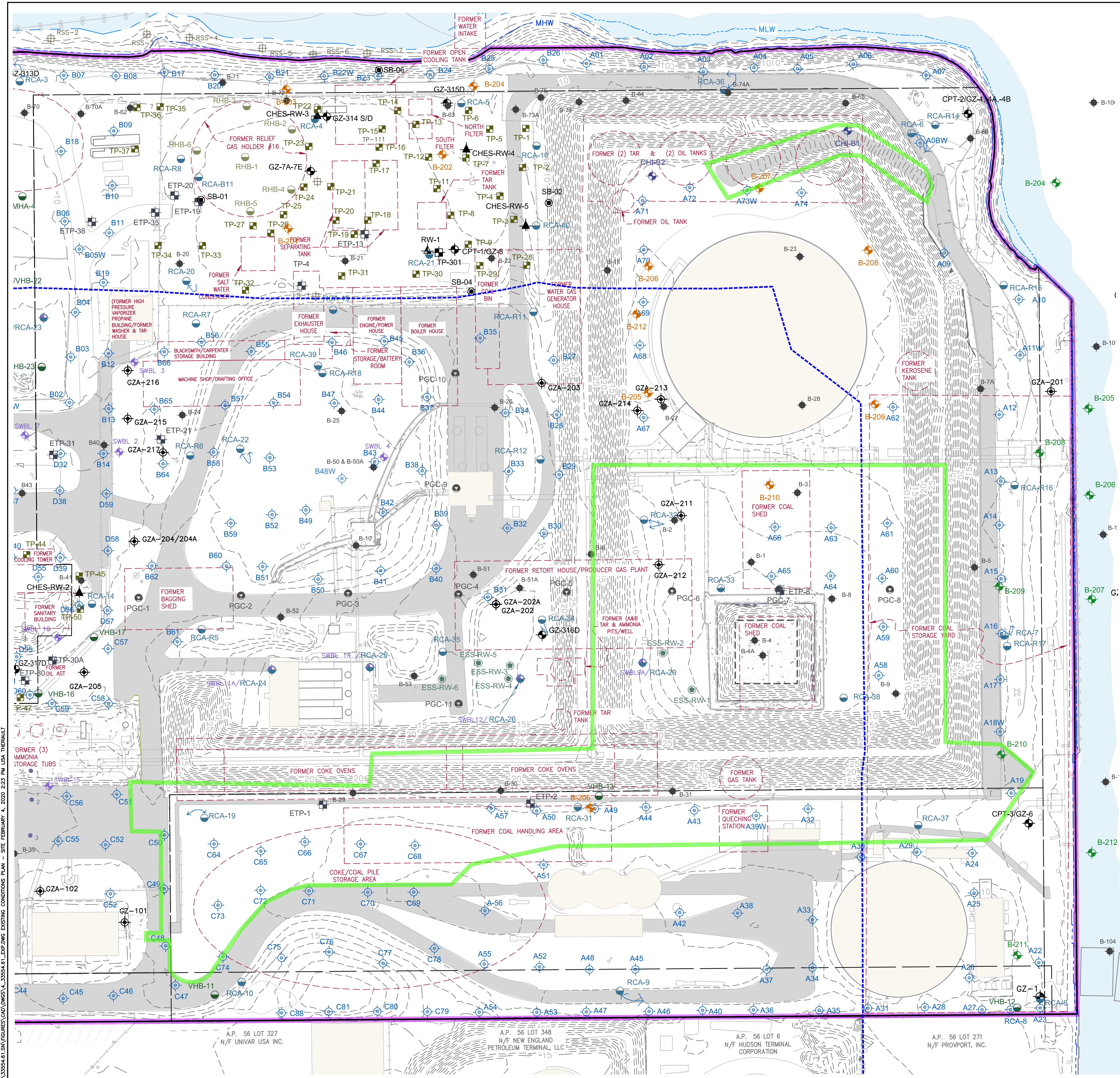

GENERAL NOTES:

- EXISTING CONDITIONS BASE MAP DEVELOPED FROM THE FOLLOWING:
 - ELECTRONIC CAD FILE "ACAD-7257P.DWG" PROVIDED BY VANASSE HANGEN BRUSTLIN (VHB) ENTITLED "EXISTING CONDITIONS PLAN," PROJECT TITLE "NATIONAL GRID LNG TERMINAL ROAD LNG FACILITY" DATED MARCH 10, 2014, ORIGINAL SCALE 1" = 50', DRAWING NO. SV-1 THROUGH SV-3 AND AERIAL MAPPING BY WSP TRANSPORTATION AND INFRASTRUCTURE DATED JANUARY 15, 2014 PREPARED FOR NATIONAL GRID LAND SURVEYING DEPARTMENT, WALTHAM, MASSACHUSETTS AND CAD FILE NO. 09303023.052-1.DWG.
 - ELECTRONIC CAD FILE "3654-642 ALLENS AVE ASBUILT.DWG", PREPARED BY A PLUS CONSTRUCTION SERVICES CORPORATION FOR CHARTER ENVIRONMENTAL, TITLED "AS-BUILT PLAN," SHEET 1 TITLED "SUB GRADE" AND SHEET 2 TITLED "FINISH GRADE," DATED DECEMBER 16, 2016 AND PROVIDED TO GZA ON MARCH 23, 2017.
 - ON-SITE INVESTIGATIONS AND SURVEYS BY GZA PERSONNEL DURING VARIOUS SITE VISITS BETWEEN 2011 AND 2015.
- PROPERTY LINES AND LOT INFORMATION ESTABLISHED FROM INFORMATION PROVIDED ON A DRAWING ENTITLED "EXISTING CONDITIONS PLAN" PROJECT TITLE "NATIONAL GRID LNG TERMINAL ROAD LNG FACILITY" DATED MARCH 10, 2014, ORIGINAL SCALE 1" = 50', DRAWING NO. SV-1 THROUGH SV-3.
- EXPLORATION LOCATION PLANS WERE DEVELOPED FROM THE FOLLOWING:
 - SITE PLANS PROVIDED BY RESOURCE CONTROLS ASSOCIATES (RCA) IN THE RIDEM-SUBMITTED JULY 5, 1994 "SITE CHARACTERIZATION PLAN" PREPARED ON BEHALF OF THE PROVIDENCE GAS COMPANY. PLANS PROVIDED BY NATIONAL GRID.
 - SITE PLANS PROVIDED BY RCA IN THE RIDEM-SUBMITTED JUNE 28, 1996 "PHASE IB FIELD CHARACTERIZATION INVESTIGATION" PREPARED ON BEHALF OF THE PROVIDENCE GAS COMPANY. PLANS PROVIDED BY NATIONAL GRID.
 - SITE PLANS PROVIDED BY ENVIRONMENTAL SCIENCE SERVICES, INC. (ESS) IN THE RIDEM-SUBMITTED DECEMBER 4, 1998 "REMEDIAL ACTION WORK PLAN (RAWP)" PREPARED ON BEHALF OF THE PROVIDENCE GAS COMPANY. PLANS PROVIDED BY NATIONAL GRID.
 - SITE PLANS PROVIDED BY ESS IN THE RIDEM-SUBMITTED OCTOBER 21, 1999 "SUBSURFACE INVESTIGATION AND PROPOSED ALGONQUIN GENERATOR CONSTRUCTION AREA" PREPARED ON BEHALF OF THE PROVIDENCE GAS COMPANY. PLANS PROVIDED BY NATIONAL GRID.
 - SITE PLANS PROVIDED BY VHB IN THE RIDEM-SUBMITTED NOVEMBER 2002 "REMEDIAL ACTION CLOSURE REPORT" PREPARED ON BEHALF OF THE NEW ENGLAND GAS COMPANY. PLANS PROVIDED BY NATIONAL GRID.
 - SITE PLANS PROVIDED BY VHB IN THE RIDEM-SUBMITTED APRIL 2003 "SITE INVESTIGATION REPORT" PREPARED ON BEHALF OF THE NEW ENGLAND GAS COMPANY. PLANS PROVIDED BY NATIONAL GRID.
 - SITE PLANS PROVIDED BY VHB IN THE RIDEM-SUBMITTED JANUARY 26, 2009 "OXIDE BOX INVESTIGATION TECHNICAL MEMORANDUM" PREPARED ON BEHALF OF NATIONAL GRID. PLANS PROVIDED BY NATIONAL GRID.
 - FIGURE 3 "EXPLORATION LOCATION PLAN" PREPARED BY GZA GEOENVIRONMENTAL, INC. (GZA) ON BEHALF OF CHICAGO BRIDGE AND IRON (CB&I) IN JULY 2005. PLANS PROVIDED BY NATIONAL GRID.
 - FIGURE 35 "TEST BORINGS UNDER SASSAFRAS POINT PLANT" DATED JUNE 5, 1912 PREPARED BY THE DIVISION OF PUBLIC WORKS, PROVIDENCE, RHODE ISLAND. PLANS PROVIDED BY NATIONAL GRID.
 - DRAWING 3 "WHARF FACILITIES - BULKHEAD REBUILDING - CROSS SECTIONS" DATED JANUARY 11, 1973 PREPARED BY PARSONS, BRINCKERHOFF, QUADE AND DOUGLAS ON BEHALF OF THE PROVIDENCE GAS COMPANY. PLANS PROVIDED BY NATIONAL GRID.
 - FIGURE 2 "EXPLORATION LOCATION PLAN," DATED SEPTEMBER 18, 2015, BY WEIDLINGER ASSOCIATES, INC. (WEI) ON BEHALF OF KIEWIT CORPORATION (KIEWIT). PLAN PROVIDED BY NATIONAL GRID.
 - ELECTRONIC CAD FILE "ACAD-7257P.DWG" PROVIDED BY VANASSE HANGEN BRUSTLIN (VHB) ENTITLED "EXISTING CONDITIONS PLAN," PROJECT TITLE "NATIONAL GRID LNG TERMINAL ROAD LNG FACILITY" DATED MARCH 10, 2014, ORIGINAL SCALE 1" = 50', DRAWING NO. SV-1 THROUGH SV-3 AND AERIAL MAPPING BY WSP TRANSPORTATION AND INFRASTRUCTURE DATED JANUARY 15, 2014 PREPARED FOR NATIONAL GRID LAND SURVEYING DEPARTMENT, WALTHAM, MASSACHUSETTS AND CAD FILE NO. 09303023.052-1.DWG. PLANS PROVIDED BY NATIONAL GRID.
 - ON-SITE INVESTIGATIONS AND SURVEYS BY GZA PERSONNEL DURING VARIOUS SITE VISITS BETWEEN 2011 AND 2015.
- THE LOCATION OF THE EXPLORATIONS AND MONITORING WELLS AT THE SITE WERE APPROXIMATELY DETERMINED AND HAVE BEEN ALIGNED AND ADJUSTED FOR THE "BEST FIT" AND THESE DATA SHOULD BE CONSIDERED ACCURATE ONLY TO THE DEGREE IMPLIED BY THE METHOD USED.
- APPROXIMATE HISTORICAL STRUCTURE/EQUIPMENT LOCATIONS AND DATES WERE OBTAINED FROM THE FOLLOWING SOURCES:
 - CERTIFIED SANBORN MAPS DATED: 1950, 1956, 1972, 1977 AND 1982
 - AERIAL ORTHOPHOTOGRAPHIC IMAGES OBTAINED FROM RIGIS: 1939, 1951, 1962, 1972, 1976, 1981, 1988, 1992, 1995, 1997, 2002, 2008
 - SITE PLANS PROVIDED BY RESOURCE CONTROLS ASSOCIATES (RCA) IN THE RIDEM-SUBMITTED JULY 5, 1994 "SITE CHARACTERIZATION PLAN" PREPARED ON BEHALF OF THE PROVIDENCE GAS COMPANY. PLANS PROVIDED BY NATIONAL GRID.
 - HISTORIC SITE PLAN "GENERAL PLAN OF WORKS, PROVIDENCE GAS COMPANY, SASSAFRAS POINT PLANT, PROVIDENCE, RHODE ISLAND," UNDATED. PLANS PROVIDED BY NATIONAL GRID.
- HORIZONTAL DATUM IS BASED ON NAD 1983 FROM BASE MAPPING PROVIDED BY VHB.
- VERTICAL DATUM IS BASED ON NAVD 1988 (MSL) FROM BASE MAPPING PROVIDED BY VHB.



KEY PLAN:
SCALE: 1"=800'

LEGEND:

- EXISTING STRUCTURE
- EXISTING CONTOUR (MAJOR 5 FOOT INTERVAL)
- EXISTING CONTOUR (MINOR 1 FOOT INTERVAL)
- EXISTING PAVEMENT
- PROPERTY LINE
- INTERIOR PROPERTY LINE
- HISTORIC STRUCTURE OR FEATURE
- STRA AREA
- 200-FOOT CRMC JURISDICTIONAL LIMIT
- UTILITY POLE
- LIGHT POLE
- HYDRANT

EXPLORATION LEGEND:

- VHB-7 ENVIRONMENTAL BORING OBSERVED BY VHB IN 2002 AND 2003
- F47 ENVIRONMENTAL BORING OBSERVED BY ESS IN 1999 AND 2000
- RCA-40 ENVIRONMENTAL BORING OBSERVED BY RCA BETWEEN 1994-1996
- ETP-4 ENVIRONMENTAL TEST PITS OBSERVED BY RCA IN 1995 AND 1996
- ESS-RW-1 RECOVERY WELL INSTALLED BY ESS IN 1999 AND 2000
- CPT-3/GZ-6 GEOTECHNICAL BORING OBSERVED BY GZA IN 2004
- SWBL-13 GEOTECHNICAL BORING OBSERVED BY SWEC IN 1995
- B-207 GEOTECHNICAL BORING PERFORMED FOR PROVIDENCE GAS COMPANY IN 1973
- B-25 GEOTECHNICAL BORING OBSERVED BY HALEY & ALDRICH IN 1971 AND 1972
- PGC-8 GEOTECHNICAL BORING PERFORMED FOR PROVIDENCE GAS COMPANY IN 1912
- B-211 GEOTECHNICAL BORING PERFORMED BY GOLDER ASSOCIATES IN 2016
- W155 CONFIRMATORY SOIL SAMPLE LOCATION COLLECTED BY ESS IN 1999
- CHI-B1 GEOTECHNICAL BORING PERFORMED BY CHI IN 2014

FOR PERMITTING ONLY

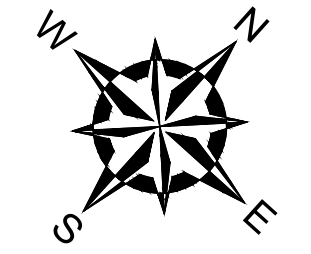

THE INFORMATION SHOWN ON THE DRAWING IS SOLELY FOR USE BY NATIONAL GRID OR THE NATIONAL GRID'S DESIGNATED REPRESENTATIVE FOR THE SPECIFIC PROJECT AND LOCATION IDENTIFIED ON THE DRAWING. THE DRAWING SHALL NOT BE TRANSFERRED, REUSED, COPIED, OR ALTERED IN ANY MANNER FOR USE AT ANY OTHER LOCATION OR FOR ANY OTHER PURPOSE WITHOUT THE PRIOR WRITTEN CONSENT OF GZA AND NATIONAL GRID. ANY TRANSFER, REUSE, OR MODIFICATION TO THE DRAWING BY OTHERS, WITHOUT THE PRIOR WRITTEN EXPRESS CONSENT OF GZA AND NATIONAL GRID, WILL BE AT THE USER'S SOLE RISK AND WITHOUT ANY RISK OR LIABILITY TO GZA AND NATIONAL GRID.

NATIONAL GRID DIKE ACCESS ROAD PERMIT CLOSEOUT 642 ALLENS AVENUE PROVIDENCE, RHODE ISLAND			
EXPLORATION LOCATION PLAN			
PREPARED BY: GZA GeoEnvironmental, Inc. Engineers and Scientists www.gza.com	PREPARED FOR: nationalgrid		
PROJ MGR: SN DESIGNED BY: SN DATE: FEBRUARY 2020	REVIEWED BY: SN DRAWN BY: LDT PROJECT NO.: 33554.61	CHECKED BY: SN SCALE: AS NOTED REVISION NO.: 0	FIGURE 4 SHEET NO. 4 OF 7

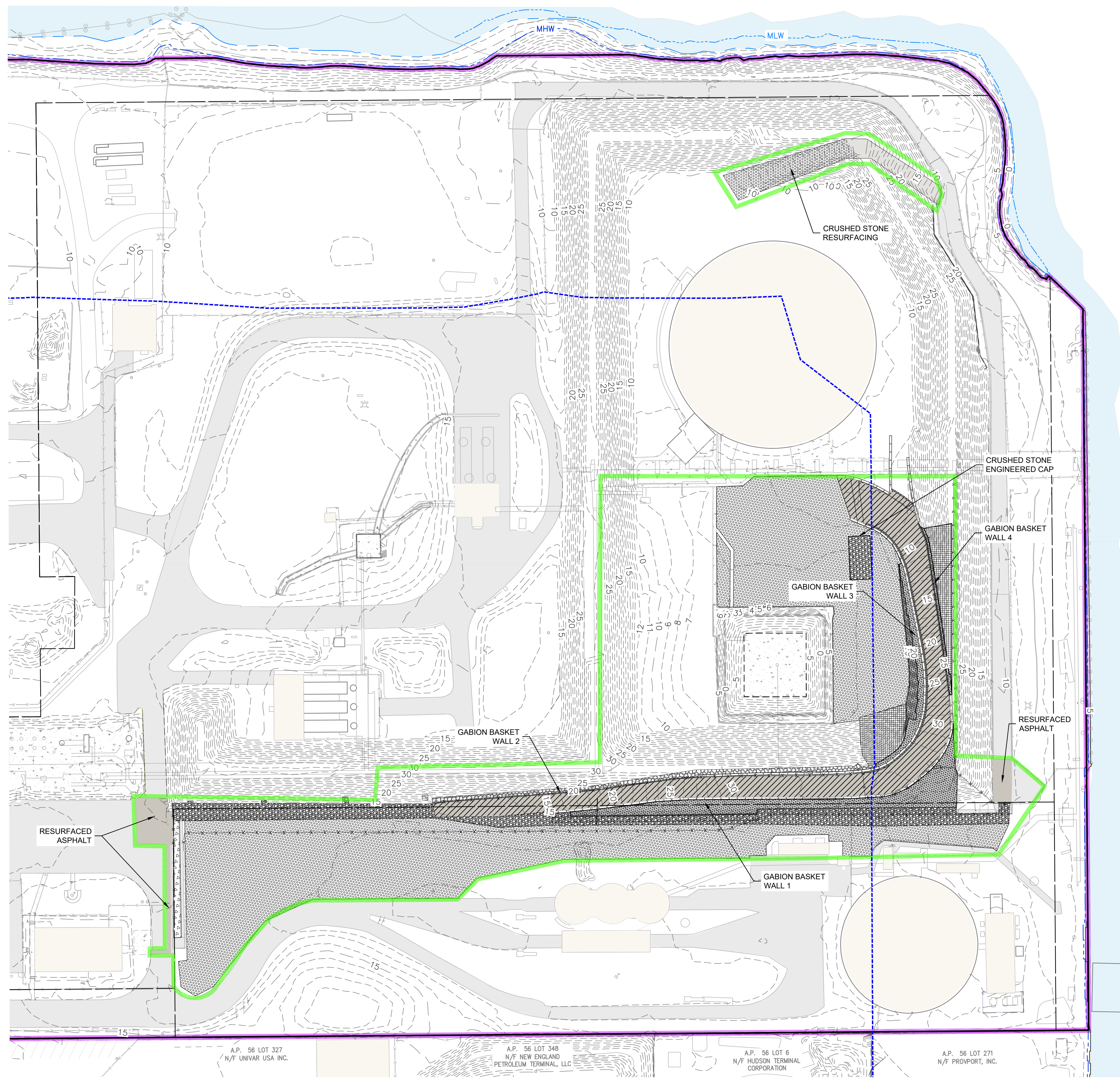

LEGEND:

- PROPERTY LINES
- - - INTERIOR PROPERTY LINES
- - - 10 - CURRENT GRADING CONTOUR (MAJOR 5 FOOT INTERVAL)
- - - 11 - CURRENT GRADING CONTOUR (MINOR 1 FOOT INTERVAL)
- - - 200-FOOT CRMC SETBACK
- 642 ALLENS AVENUE FORMER MGP SITE
- STRA AREA
- EXISTING PAVEMENT
- EXISTING BUILDING
- RESURFACED ASPHALT
- INSTALLED ASPHALT ENGINEERED CAP (2" TOP COURSE, 4" BASE COURSE, 8" AGGREGATE BASE)
- INSTALLED CRUSHED STONE ENGINEERED CAP (AT LEAST 12" CLEAN GRANULAR IMPORT, NON-WOVEN GEOTEXTILE)
- RIP RAP ENGINEERED CAP (AT LEAST 12" RIP RAP, NON-WOVEN GEOTEXTILE)
- GABION BASKET/RIP RAP ENGINEERED WALL (AT LEAST 24" CLEAN MATERIAL)
- RIP RAP RESURFACING AREA
- CRUSHED STONE /PEASTONE RESURFACING
- JERSEY BARRIERS
- CAPE COD BERM
- NEW FENCE

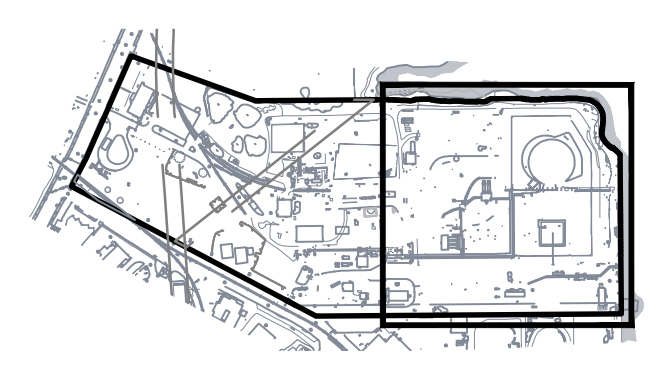

KEY PLAN:
SCALE: 1"=800'

- GENERAL NOTES:**
- EXISTING CONDITIONS BASE MAP DEVELOPED FROM THE FOLLOWING:
 - ELECTRONIC CAD FILE "ACAD-7257PL.DWG" PROVIDED BY VANASSE HANGEN BRUSTLIN (VHB) ENTITLED "EXISTING CONDITIONS PLAN," PROJECT TITLE "NATIONAL GRID LNG TERMINAL ROAD LNG FACILITY" DATED MARCH 10, 2014, ORIGINAL SCALE 1" = 50', DRAWING NO. SV-1 THROUGH SV-3 AND AERIAL MAPPING BY WSP TRANSPORTATION AND INFRASTRUCTURE DATED JANUARY 15, 2014 PREPARED FOR NATIONAL GRID LAND SURVEYING DEPARTMENT, WALTHAM, MASSACHUSETTS AND CAD FILE NO. 09303023.052-1.DWG
 - ELECTRONIC CAD FILE "3854 642 ALLENS AVE ASBUILT.DWG", PREPARED BY A-PLUS CONSTRUCTION SERVICES CORPORATION FOR CHARTER ENVIRONMENTAL, TITLED "AS-BUILT PLAN," SHEET 1 TITLED "SUB GRADE" AND SHEET 2 TITLED "FINISH GRADE," DATED DECEMBER 16, 2016 AND PROVIDED TO GZA ON MARCH 23, 2017
 - ON-SITE INVESTIGATIONS AND SURVEYS BY GZA PERSONNEL DURING VARIOUS SITE VISITS BETWEEN 2011 AND 2019.
 - AS-BUILT DEVELOPED FROM AN ELECTRONIC CAD FILE "19-NG-20_TERMINAL-RD_PROVIDENCE.DWG," PREPARED BY TAUPER LAND SURVEY, INC. ON DECEMBER 30, 2019 FOR NATIONAL GRID LAND SURVEYING DEPARTMENT, WALTHAM, MASSACHUSETTS.
 - PROPERTY LINES AND LOT INFORMATION ESTABLISHED FROM INFORMATION PROVIDED ON A DRAWING ENTITLED "EXISTING CONDITIONS PLAN," PROJECT TITLE "NATIONAL GRID LNG TERMINAL ROAD LNG FACILITY" DATED MARCH 10, 2014, ORIGINAL SCALE 1" = 50', DRAWING NO. SV-1 THROUGH SV-3.
 - SITE BOUNDARIES ARE APPROXIMATE.
 - HORIZONTAL DATUM IS BASED ON NAD 1983 FROM BASE MAPPING PROVIDED BY VHB.
 - VERTICAL DATUM IS BASED ON NAVD 1988 FROM BASE MAPPING PROVIDED BY VHB.

FOR PERMITTING ONLY

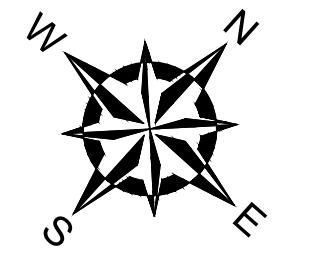

THE INFORMATION SHOWN ON THE DRAWING IS SOLELY FOR USE BY NATIONAL GRID OR THE NATIONAL GRID'S DESIGNATED REPRESENTATIVE FOR THE SPECIFIC PROJECT AND LOCATION IDENTIFIED ON THE DRAWING. THE DRAWING SHALL NOT BE TRANSFERRED, REUSED, COPIED, OR ALTERED IN ANY MANNER FOR USE AT ANY OTHER LOCATION OR FOR ANY OTHER PURPOSE WITHOUT THE PRIOR WRITTEN CONSENT OF GZA AND NATIONAL GRID. ANY TRANSFER, REUSE, OR MODIFICATION TO THE DRAWING BY OTHERS, WITHOUT THE PRIOR WRITTEN EXPRESS CONSENT OF GZA AND NATIONAL GRID, WILL BE AT THE USER'S SOLE RISK AND WITHOUT ANY RISK OR LIABILITY TO GZA AND NATIONAL GRID.

NATIONAL GRID			
DIKE ACCESS ROAD PERMIT CLOSEOUT 642 ALLENS AVENUE PROVIDENCE, RHODE ISLAND			
REMEDIAL CAP FINAL GRADING PLAN			
PREPARED BY: GZA GeoEnvironmental, Inc. Engineers and Scientists www.gza.com		PREPARED FOR: nationalgrid	
PROJ MGR: SN	REVIEWED BY: SN	CHECKED BY: SN	FIGURE
DESIGNED BY: SN	DRAWN BY: LDT	SCALE: AS NOTED	5
DATE: FEBRUARY 2020	PROJECT NO. 33554.61	REVISION NO. 0	

2020 - GZA GeoEnvironmental, Inc. GZA-33554.61-ENVIRONMENTAL-CAP-FD-PLANING-5-FEBRUARY-4-2020-2:28 PM USA THERMAL

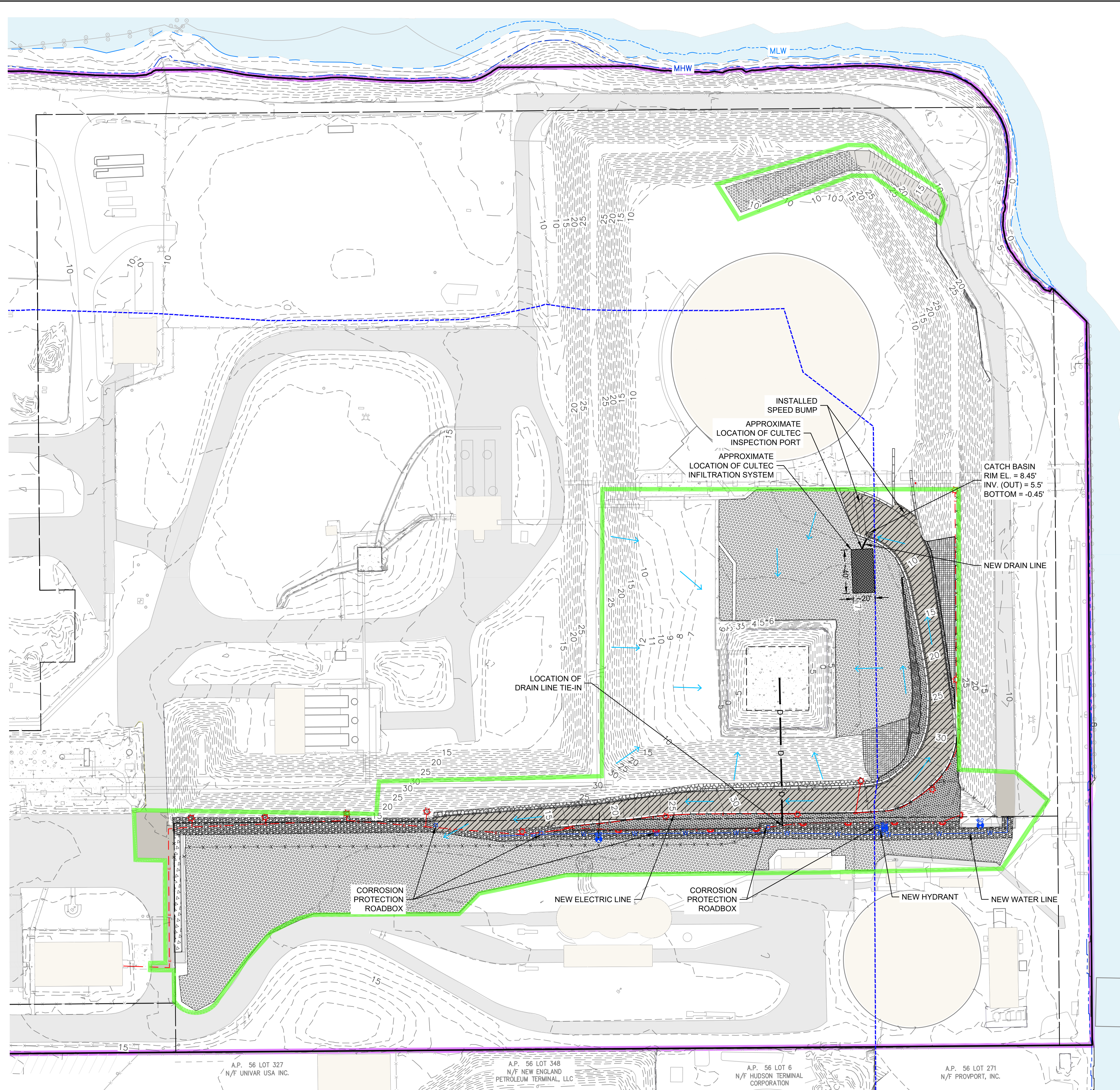

- LEGEND:**
- PROPERTY LINES
 - INTERIOR PROPERTY LINES
 - 10- CURRENT GRADING CONTOUR (MAJOR 5 FOOT INTERVAL)
 - 11- CURRENT GRADING CONTOUR (MINOR 1 FOOT INTERVAL)
 - 200-FOOT CRMC SETBACK
 - 642 ALLENS AVENUE FORMER MGP SITE
 - STRA AREA
 - EXISTING PAVEMENT
 - EXISTING BUILDING
 - UTILITY POLE
 - LIGHT POLE
 - NEW HYDRANT
 - RESURFACED ASPHALT
 - INSTALLED ASPHALT ENGINEERED CAP (AT LEAST 2" TOP COURSE, 4" BASE COURSE, 8" AGGREGATE BASE)
 - INSTALLED CRUSHED STONE ENGINEERED CAP (AT LEAST 12" CLEAN GRANULAR IMPORT, NON-WOVEN GEOTEXTILE)
 - RIP RAP ENGINEERED CAP (12" RIP RAP, NON-WOVEN GEOTEXTILE)
 - GABION BASKET/RIP RAP ENGINEERED WALL (AT LEAST 24" CLEAN MATERIAL)
 - RIP RAP RESURFACING AREA
 - CRUSHED STONE /PEASTONE RESURFACING
 - JERSEY BARRIERS
 - CAPE COD BERM
 - NEW UTILITY POLE WITH LIGHT
 - NEW MOUNTED LIGHT
 - NEW CATCH BASIN
 - NEW WATER LINE (APPROXIMATE LOCATION - FOR REFERENCE ONLY)
 - NEW DRAIN LINE (APPROXIMATE LOCATION - FOR REFERENCE ONLY)
 - NEW FENCE
 - NEW ELECTRIC LINE (APPROXIMATE LOCATION - FOR REFERENCE ONLY)
 - WATER GATE
 - WATER LINE CORROSION PROTECTION ROADBOX
 - INDICATES STORMWATER FLOW

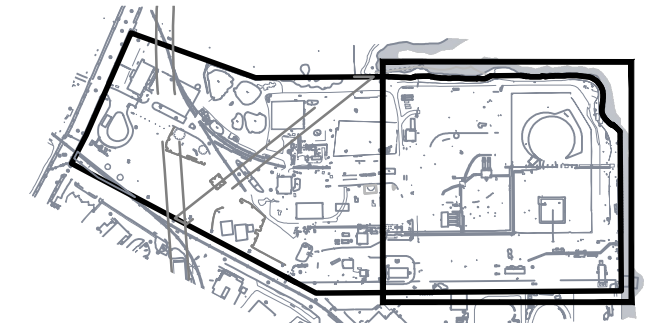

- GENERAL NOTES:**
- EXISTING CONDITIONS BASE MAP DEVELOPED FROM THE FOLLOWING:
 - ELECTRONIC CAD FILE "ACAD-7257PL.DWG" PROVIDED BY VANASSE HANGEN BRUSTLIN (VHB) ENTITLED "EXISTING CONDITIONS PLAN," PROJECT TITLE "NATIONAL GRID LNG TERMINAL ROAD LNG FACILITY" DATED MARCH 10, 2014, ORIGINAL SCALE 1" = 50', DRAWING NO. SV-1 THROUGH SV-3 AND AERIAL MAPPING BY WSP TRANSPORTATION AND INFRASTRUCTURE DATED JANUARY 15, 2014 PREPARED FOR NATIONAL GRID LAND SURVEYING DEPARTMENT, WALTHAM, MASSACHUSETTS AND CAD FILE NO. 09303023.052-1.DWG
 - ELECTRONIC CAD FILE "3654 642 ALLENS AVE ASBUILT.DWG", PREPARED BY A-PLUS CONSTRUCTION SERVICES CORPORATION FOR CHARTER ENVIRONMENTAL, TITLED "AS-BUILT PLAN," SHEET 1 TITLED "SUB GRADE" AND SHEET 2 TITLED "FINISH GRADE," DATED DECEMBER 16, 2016 AND PROVIDED TO GZA ON MARCH 23, 2017
 - ON-SITE INVESTIGATIONS AND SURVEYS BY GZA PERSONNEL DURING VARIOUS SITE VISITS BETWEEN 2011 AND 2019.
 - AS-BUILT DEVELOPED FROM AN ELECTRONIC CAD FILE "19-NG-20_TERMINAL-RD PROVIDENCE.DWG," PREPARED BY TAUPER LAND SURVEY, INC. ON DECEMBER 30, 2019 FOR NATIONAL GRID LAND SURVEYING DEPARTMENT, WALTHAM, MASSACHUSETTS.
 - PROPERTY LINES AND LOT INFORMATION ESTABLISHED FROM INFORMATION PROVIDED ON A DRAWING ENTITLED "EXISTING CONDITIONS PLAN," PROJECT TITLE "NATIONAL GRID LNG TERMINAL ROAD LNG FACILITY" DATED MARCH 10, 2014, ORIGINAL SCALE 1" = 50', DRAWING NO. SV-1 THROUGH SV-3.
 - SITE BOUNDARIES ARE APPROXIMATE.
 - LOCATION OF UTILITIES IS APPROXIMATE AND INCLUDED FOR REFERENCE ONLY)
 - HORIZONTAL DATUM IS BASED ON NAD 1983 FROM BASE MAPPING PROVIDED BY VHB.
 - VERTICAL DATUM IS BASED ON NAVD 1988 FROM BASE MAPPING PROVIDED BY VHB.

FOR PERMITTING ONLY

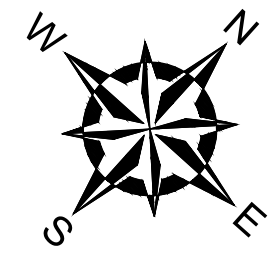

THE INFORMATION SHOWN ON THE DRAWING IS SOLELY FOR USE BY NATIONAL GRID OR THE NATIONAL GRID'S DESIGNATED REPRESENTATIVE FOR THE SPECIFIC PROJECT AND LOCATION IDENTIFIED ON THE DRAWING. THE DRAWING SHALL NOT BE TRANSFERRED, REUSED, COPIED, OR ALTERED IN ANY MANNER FOR USE AT ANY OTHER LOCATION OR FOR ANY OTHER PURPOSE WITHOUT THE PRIOR WRITTEN CONSENT OF GZA AND NATIONAL GRID. ANY TRANSFER, REUSE, OR MODIFICATION TO THE DRAWING BY OTHERS, WITHOUT THE PRIOR WRITTEN EXPRESS CONSENT OF GZA AND NATIONAL GRID, WILL BE AT THE USER'S SOLE RISK AND WITHOUT ANY RISK OR LIABILITY TO GZA AND NATIONAL GRID.

NATIONAL GRID DIKE ACCESS ROAD PERMIT CLOSEOUT 642 ALLENS AVENUE PROVIDENCE, RHODE ISLAND			
INSTALLED UTILITIES AND STORMWATER MANAGEMENT PLAN			
PREPARED BY: GZA GeoEnvironmental, Inc. Engineers and Scientists www.gza.com	PREPARED FOR: nationalgrid		
PROJ MGR: SN DESIGNED BY: SN DATE: FEBRUARY 2020	REVIEWED BY: SN DRAWN BY: LDT PROJECT NO.: 33554.61	CHECKED BY: SN SCALE: AS NOTED REVISION NO.: 0	FIGURE 6 SHEET NO. 6 OF 7

2020 - GZA GeoEnvironmental, Inc. GZA-33554.61-ENVIRONMENTAL AND STORMWATER MANAGEMENT PLAN.DWG 9 FEBRUARY 4, 2020 3:54 PM USA THERMALT

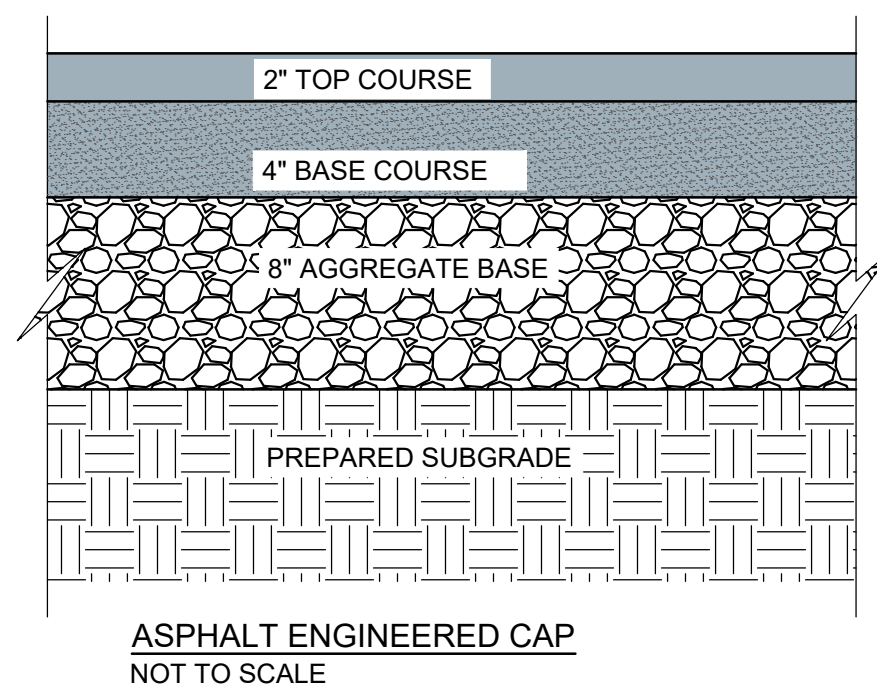

ASPHALT ENGINEERED CAP
NOT TO SCALE

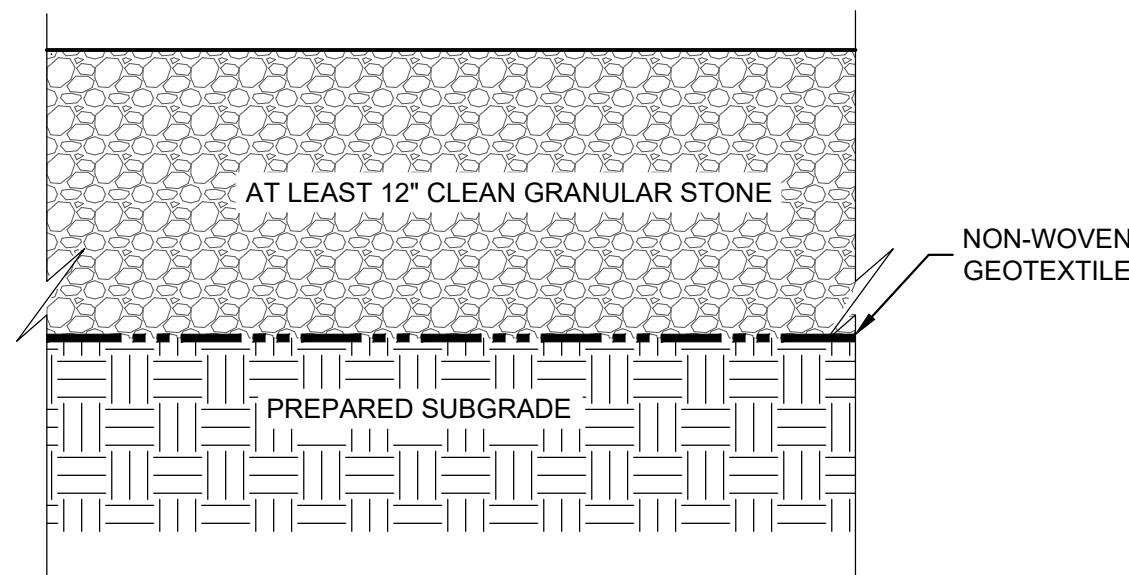

CRUSHED STONE ENGINEERED CAP
NOT TO SCALE

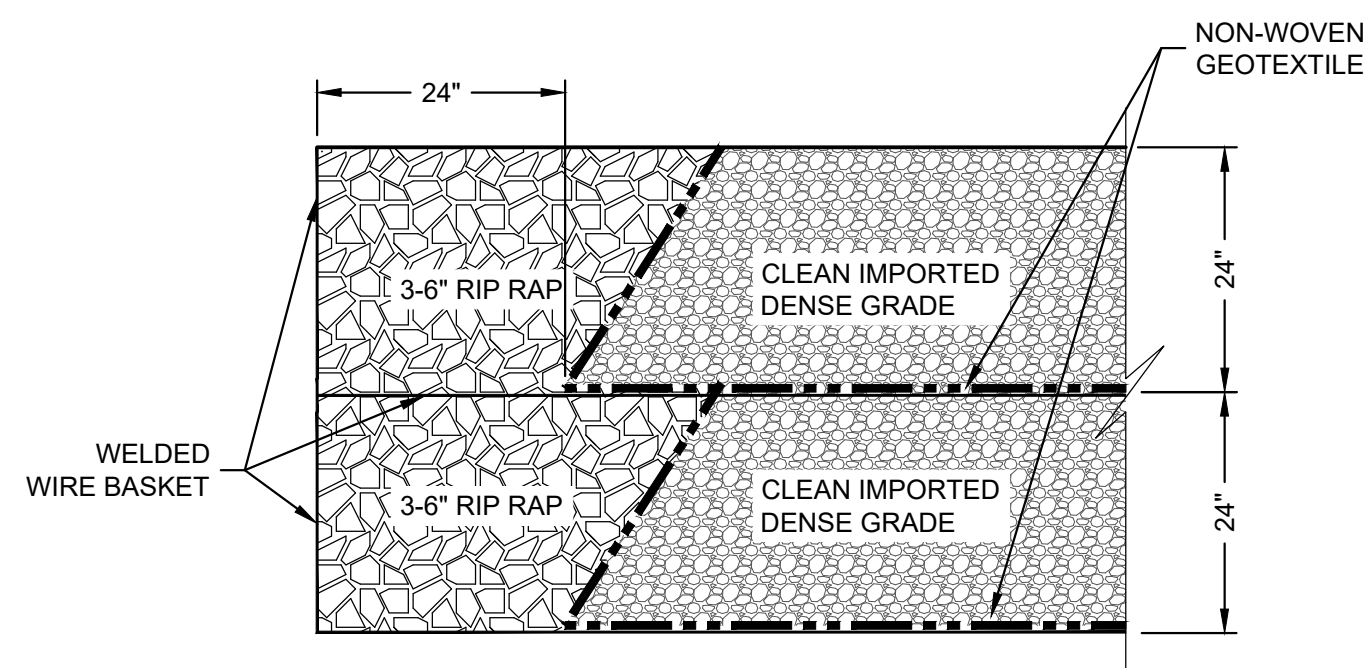

GABION BASKET ENGINEERED CAP
NOT TO SCALE

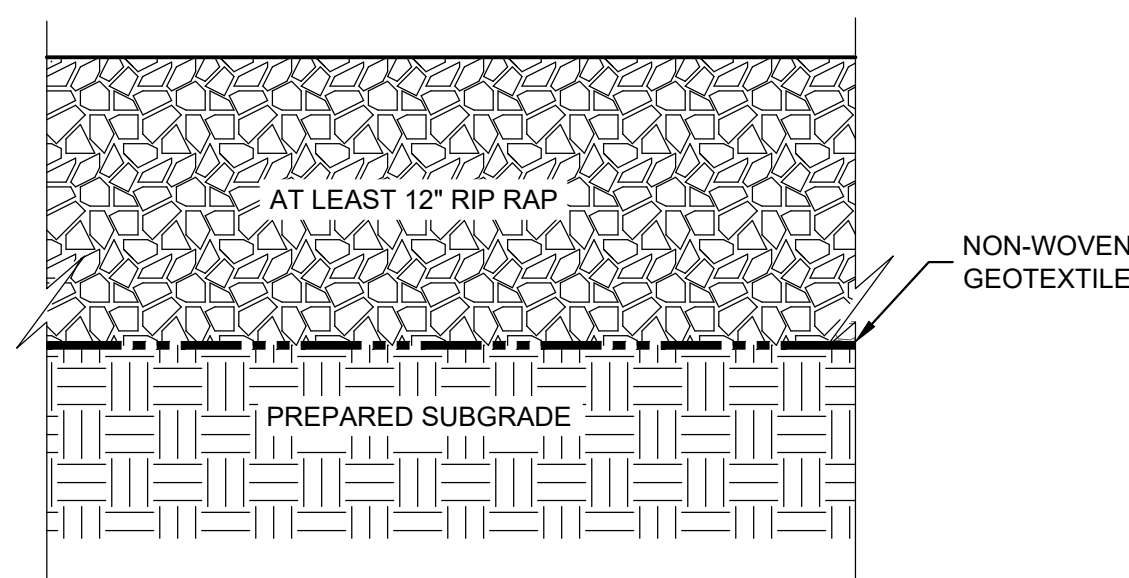

RIP RAP ENGINEERED CAP
NOT TO SCALE

FOR PERMITTING ONLY

THE INFORMATION SHOWN ON THE DRAWING IS SOLELY FOR USE BY NATIONAL GRID OR THE NATIONAL GRID'S DESIGNATED REPRESENTATIVE FOR THE SPECIFIC PROJECT AND LOCATION IDENTIFIED ON THE DRAWING. THE DRAWING SHALL NOT BE TRANSFERRED, REUSED, COPIED, OR ALTERED IN ANY MANNER FOR USE AT ANY OTHER LOCATION OR FOR ANY OTHER PURPOSE WITHOUT THE PRIOR WRITTEN CONSENT OF GZA AND NATIONAL GRID. ANY TRANSFER, REUSE, OR MODIFICATION TO THE DRAWING BY OTHERS, WITHOUT THE PRIOR WRITTEN EXPRESS CONSENT OF GZA AND NATIONAL GRID, WILL BE AT THE USER'S SOLE RISK AND WITHOUT ANY RISK OR LIABILITY TO GZA AND NATIONAL GRID.

NATIONAL GRID DIKE ACCESS ROAD PERMIT CLOSEOUT 642 ALLENS AVENUE PROVIDENCE, RHODE ISLAND			
REMEDIAL CAP DETAILS			
PREPARED BY: GZA GeoEnvironmental, Inc. Engineers and Scientists www.gza.com		PREPARED FOR: nationalgrid	
PROJ MGR: SN DESIGNED BY: SN DATE: FEBRUARY 2020	REVIEWED BY: SN DRAWN BY: LDT PROJECT NO.: 33554.61	CHECKED BY: SN SCALE: AS NOTED REVISION NO.: 0	FIGURE 7 SHEET NO. 7 OF 7



ATTACHMENT C

NOTICE OF TERMINATION FORM



NOTICE OF TERMINATION (NOT)

STORMWATER GENERAL PERMIT FOR CONSTRUCTION ACTIVITY

INSTRUCTIONS:

Use this form to notify RIDEM upon project completion, confirming that work has been completed in accordance with approved plans and final site stabilization was achieved on **Stormwater Construction** permitted sites.

Submit forms by email to: DEM.StwConstruction@dem.ri.gov or by mail to:

Permit Application Center (PAC), RIDEM, 235 Promenade Street, Room 260, Providence, RI 02908.

Provide all file numbers associated with this site.

RIPDES Permit Authorization to be terminated:		Freshwater Wetlands Permit:		NA
RIR 101439		Water Quality Certification File:		16-115
		UIC/Groundwater Discharge File:		001729

I. OWNER

Name:	Narragansett Electric Co. dba National Grid	Email:	william.howard@nationalgrid.com		
Mailing Address:	280 Melrose Street	Phone:	401-784-7490		
City:	Providence	State:	RI	Zip:	02907
Contact Person:	William Howard	Title:			

II. OPERATOR (if different from Owner)

Name:		Email:			
Mailing Address:		Phone:			
City:		State:		Zip:	
Contact Person:		Title:			

III. CONSTRUCTION SITE INFORMATION

Street Address:	121 Terminal Road			Phone:	
City:	Providence	State:	RI	Zip:	02905
Nearest Utility Pole:		Assessor's Plat:	56	Lot:	273, 316
Date land disturbing activities ceased (required):	June 7, 2019				
Date final site stabilization was achieved (required):	June 7, 2019				

IV. OWNER & OPERATOR CERTIFICATION

I certify under penalty of law that all disturbed soils at the construction site have been stabilized and temporary erosion and sediment control measures have been removed and all stormwater discharges associated with construction activity from the construction site that are authorized by the General Permit have been eliminated. The burden of operating in compliance with applicable RIPDES Regulations is my responsibility. I am aware that there are significant penalties for submitting false information, including the possibility of fine and imprisonment for knowing violations.

Owner's Name:	William Howard	Owner's Title:	Principal Environmental Scientist
Owner's Signature:		Date:	02/07/2020
Operator's Name:		Operator Title:	
Operator's Signature:		Date:	