

**QUARTERLY MONITORING REPORT  
Springfield Street School Complex  
Providence, Rhode Island**

**Project No. 081-12152-03  
May 2007 Monitoring Round**

Prepared for  
Providence School Department  
797 Westminster Street  
Providence, RI 02903

Prepared by  
LFR Inc.  
300 Metro Center Boulevard  
Suite 250  
Warwick, RI 02886  
[www.lfr.com](http://www.lfr.com)





June 5, 2007

081-12152-03

Mr. Jeffrey Crawford  
Rhode Island Department of Environmental Management  
Office of Waste Management  
235 Promenade Street  
Providence, RI 02908-5767

Subject: Quarterly Monitoring for Springfield Street School Complex, 50 Springfield Street,  
Providence, RI – May 2007 Monitoring Round

Dear Mr. Crawford:

Quarterly monitoring for soil gas, indoor air and system monitoring was conducted between May 14 and 18, 2007. The monitoring was performed in accordance with the *Long-Term Operation and Maintenance Plan and Site Contingency Plan (O&M Plan)* contained in the *Remedial Action Work Plan* prepared by ATC dated April 2, 1999, revised May 3, 1999 and May 9, 1999. The *Remedial Action Work Plan (RAWP)* was approved by the Rhode Island Department of Environmental Management (RIDEM) in a letter dated June 4, 1999.

Results of monitoring are provided in the following sections and in the attachments.

## COVER MONITORING

LFR conducted a visual survey of the site for evidence of significant soil cover erosion, or for any areas where the orange snow fencing indicator barrier was visible. LFR did not observe any areas where the orange indicator barrier was visible during this monitoring event.

Some areas of asphalt and concrete have been disturbed by settling, as identified and discussed with RIDEM in separate correspondence. However, as noted previously, the asphalt in these areas does not act as the cap because the asphalt is underlain by at least two feet of clean fill. The City of Providence is planning to repair areas of settling during the summer of 2007. Plans showing the areas to be repaired are being submitted under separate cover.

## SUB-SLAB VENTILATION SYSTEM

The sub-slab ventilation system was inspected by LFR during the quarterly monitoring on May 16, 2007. The blower in the front shed at the middle school was found to be off upon arrival, due to a high water level in the knockout tank. The other three blowers were operating normally. RIDEM was notified via phone and e-mail that the blower was not working. The knockout tank was drained on May 18, 2007, and the blower was restarted. On May 23, 2007, the blower was re-inspected and



found to be operating, but the vacuum gauge indicated that no vacuum was being drawn. The blower was shut down, and LFR personnel returned to the Site on May 24, 2007 to service the system. On May 24, 2007, we determined that water in the subslab piping was preventing the blower from drawing air. The water was cleared, and the system was restarted. The system then operated normally.

Influent and effluent air from the two blowers at the elementary school and the blower in the rear shed at the middle school was monitored. Samples of influent and effluent gas were collected in Tedlar bags at each location and screened for methane, carbon dioxide, carbon monoxide, hydrogen sulfide, and volatile organic compounds (VOC). Results are provided in Table 1.

Methane, carbon monoxide, hydrogen sulfide and organic vapor concentrations in the subslab ventilation system samples were all measured as zero during this monitoring event. Carbon dioxide readings at the elementary school ranged from 0.0 to 0.1 percent, and carbon dioxide readings at the middle school were 0.0 percent.

## **INDOOR AIR MONITORING**

Indoor air monitoring was conducted on May 16, 2007 (while the building was occupied) using a Landtec Gem 2000 landfill gas monitor (methane, carbon dioxide, oxygen, carbon monoxide and hydrogen sulfide) and a Mini Rae photoionization detector (organic vapors). Results of monitoring are provided in the Table 2. Methane, carbon dioxide, carbon monoxide, hydrogen sulfide and organic vapor concentrations were not detected during the indoor air monitoring.

The methane monitors at the middle school and the elementary schools had stickers that indicated they were last calibrated by Diamond Calibration personnel on April 13, 2007. The sensors appeared to be functioning. Calibration Certificates from Diamond Calibration indicate that many of the sensors read above 0 when calibrated to the zero gas. This prevents the sensors from giving a fault alarm if the reading drops below zero due to a sudden temperature change, and still provides a conservative measure of protection because the alarm limit does not change.

## **GROUNDWATER MONITORING**

Five groundwater monitoring wells were sampled by LFR on May 17 and 21, 2007. All wells except ATC-1 were sampled on May 17; the cap on ATC-1 was stuck so LFR personnel returned to the Site on May 21 with appropriate tools to open the well and collect the sample on May 21. Prior to sampling, the depth to water was gauged, and a volume of water equivalent to approximately three well volumes was removed from each well. Temperature, specific conductance, dissolved oxygen, and pH were measured in the field prior to sampling. Depth to groundwater ranged between 10.91 and 16.35 feet below the ground surface. Groundwater samples were collected in laboratory prepared sample jars and delivered under chain-of-custody protocol to Contest Laboratory in East Longmeadow, Massachusetts for analysis for volatile organic compounds by EPA method 8260. The



laboratory report is provided as Attachment A. Results of analysis of groundwater samples are summarized in Table 3.

The laboratory analysis of the five groundwater samples detected low concentrations of one target analyte in ATC-3, and one in ATC-4. The concentrations were well below applicable GB groundwater standards, and were consistent with concentrations and compounds detected during previous rounds of sampling and analysis.

## **SOIL GAS MONITORING**

Soil gas monitoring was conducted at 29 locations on May 14 and 15, 2007. The sampling was conducted by placing an air sampling gripper cap on each well and attaching a piece of tubing. A volume of air equivalent to approximately 3 well volumes was removed from each well using an SKC Airchek Sampling pump. Soil gas was then screened using a Landtec Gem 2000 Landfill Gas Analyzer & Extraction Monitor and a MiniRae Photoionization Detector (PID).

Air samples were also collected in Tedlar bags using the SKC Airchek Pump from wells WB-2 and MPL-6. The Tedlar bags were submitted to Con-test Analytical Laboratory for analysis for VOC via EPA method TO-14.

### ***Soil Gas Field Monitoring Results***

Soil gas samples were screened for methane, carbon monoxide, hydrogen sulfide, carbon dioxide, oxygen, and total VOCs. Soil gas survey results are provided in Table 4.

Methane, carbon monoxide and hydrogen sulfide were not detected at any of the monitoring locations. Organic vapors were detected at concentrations below the Remedial Action Work Plan Action Levels.

Carbon dioxide was detected at 27 of 29 locations with detectable concentrations ranging from 0.1% to 4.2%. This maximum carbon dioxide concentration is lower than the maximum concentration of 4.8% detected during the last round of monitoring in February 2007. The carbon dioxide Remedial Action Work Plan Action Level is 0.1%, and 21 readings exceeded the action level. The presence of carbon dioxide in soil gas is an indicator of subsurface bacterial activity and does not represent a threat to users of the property. Graphs presenting carbon dioxide, oxygen, and methane concentrations over time for seven representative wells are presented in Attachment B. Concentrations detected during this round of monitoring appear to be consistent with the patterns of rising carbon dioxide concentrations in the summer and fall, and falling carbon dioxide concentrations in the winter and spring.



### ***Soil Gas Laboratory Results***

Soil gas samples were collected from soil gas wells MPL-6 and WB-2 in Tedlar bags and submitted to Con-Test Analytical Laboratories for analysis by method TO-14. Results of the analysis are summarized in Table 5, and the laboratory report is provided in Attachment A. The results of analysis were typical of the concentrations and compounds which have been detected in previous monitoring events.

The Occupational Safety and Health Administration (OSHA) Permissible Exposure Limits (PELs) are provided in Table 5 for comparison purposes even though they are not applicable to soil gas, because it does not represent exposure point concentrations. The PELs are the average concentrations that OSHA allows to be present in a workplace without any respiratory protection or exposure controls. The concentrations detected in soil gas were well below the OSHA PELs.

### **CONCLUSIONS**

Methane, carbon monoxide, hydrogen sulfide and organic vapor concentrations did not exceed RAWP action levels in any soil gas samples, indoor air or subslab ventilation system samples. Carbon dioxide concentrations exceeded the action level at some locations. The detection of carbon dioxide in soil gas is typical of what has been detected during previous monitoring events and appears to be a result of naturally occurring bacterial activity in the subsurface.

Inspection of the cap did not reveal any evidence of exposure of the orange barrier or of breaches of the cap that would allow users of the Site to be exposed to the underlying capped soils.

If you have any questions or require any additional information, please contact the undersigned at 401-738-3887.

Sincerely,

A handwritten signature in black ink that reads "Donna Holden Pallister". The signature is fluid and cursive, with the first name being the most prominent.

Donna Holden Pallister, P.E., L.S.P.  
Senior Engineer

cc: A. Sepe, City of Providence  
S. Tremblay, Providence School Department  
Providence Public Building Authority

FIGURE

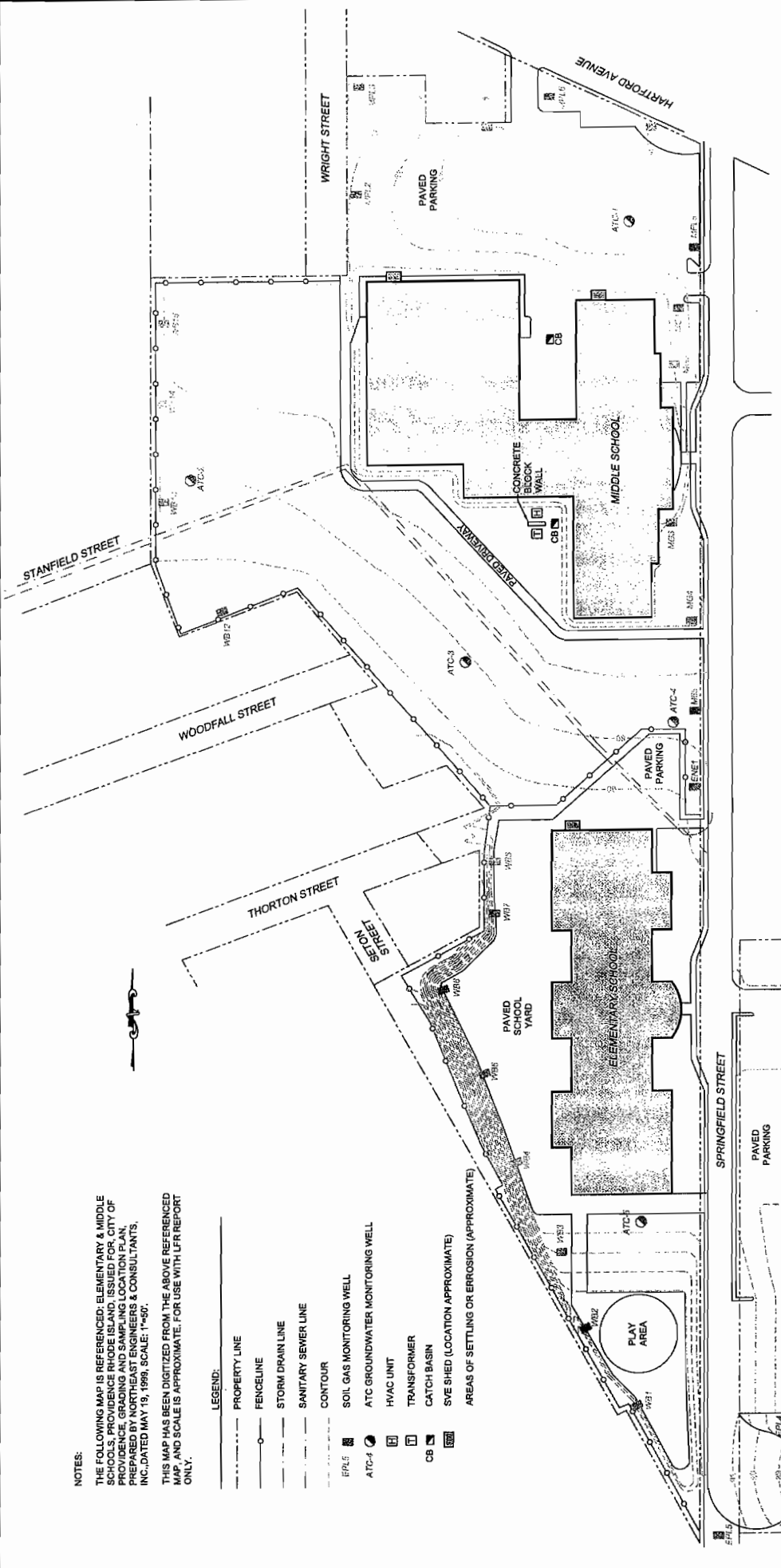

**NOTES:**  
 THE FOLLOWING MAP IS REFERENCED: ELEMENTARY & MIDDLE SCHOOLS, PROVIDENCE RHODE ISLAND, ISSUED FOR CITY OF PROVIDENCE, GRADING AND SAMPLING LOCATION PLAN, PREPARED BY NORTHEAST ENGINEERS & CONSULTANTS, INC., DATED MAY 19, 1998, SCALE: 1"=60'.  
 THIS MAP HAS BEEN DIGITIZED FROM THE ABOVE REFERENCED MAP, AND SCALE IS APPROXIMATE. FOR USE WITH LFR REPORT ONLY.

- LEGEND:**
- PROPERTY LINE
  - - - FENCELINE
  - - - STORM DRAIN LINE
  - - - SANITARY SEWER LINE
  - CONTOUR
  - SOIL GAS MONITORING WELL
  - ATC-4
  - HVAC UNIT
  - ▣ TRANSFORMER
  - ▢ CATCH BASIN
  - ▣ SVE SHED (LOCATION APPROXIMATE)
  - ▣ AREAS OF SETTLING OR EROSION (APPROXIMATE)

**LFR**  
 250 Cantanville Road  
 Building E, Suite 12  
 Warwick, Rhode Island 02886  
 Phone: (401) 798-3887  
 Fax: (401) 792-1886

**DATE:** 4-7-03  
**DRAWN BY:** PPH  
**REVIEWED BY:** DP  
**APPROVED BY:** DP  
**SCALE:** AS NOTED  
**FILE NO:** 081-10227-00  
**JOB NO:** 081-10227-00

**TITLE:** SITE PLAN

**LOCATION:** SPRINGFIELD STREET SCHOOL COMPLEX  
 SPRINGFIELD STREET  
 PROVIDENCE, RHODE ISLAND

**FIGURE:** 1

**SCALE:** 1"=100'

## TABLES



**Table 1**  
**System Monitoring Notes**  
**Springfield Street School Complex**  
**Providence, Rhode Island**  
**May 16, 2007**

Monitoring Location	Methane % by volume Landtec	Carbon Dioxide % by volume	Oxygen % by volume	Carbon Monoxide PPM	Hydrogen Sulfide PPM	Organic Vapors PPM
Elementary School inlet 1	0.0	0.1	20.1	0	0	0.0
Elementary School inlet 2	0.0	0.0	20.0	0	0	0.0
Elementary School Outlet	0.0	0.1	20.3	0	0	0.0
Middle School front shed inlet	Off on 5/16	Off on 5/16	Off on 5/16	Off on 5/16	Off on 5/16	Off on 5/16
Middle School front shed after 2 <sup>nd</sup> carbon	Off on 5/16	Off on 5/16	Off on 5/16	Off on 5/16	Off on 5/16	Off on 5/16
Middle School back shed inlet	0.0	0.0	20.1	0	0	0.0
Middle School back shed after 2 <sup>nd</sup> carbon	0.0	0.0	20.1	0	0	0.0
<b>Remedial Action Work Plan Action Levels</b>	<b>0.5</b>	<b>1,000 ppm (0.1%)</b>	<b>NA</b>	<b>9 ppm</b>	<b>10 ppm</b>	<b>5 ppm</b>

Measurements made with: Landtec Gem 2000, MiniRae 2000

Sampling date: May 16, 2007

Measured by: D.H. Pallister

**Table 2**  
**Indoor Air Monitoring Results**  
**Springfield Street School Complex**  
**Providence, Rhode Island**  
**May 16, 2007**

<b>Monitoring Location</b>	<b>Methane % by volume Landtec</b>	<b>Carbon Dioxide % by volume</b>	<b>Oxygen % by volume</b>	<b>Carbon Monoxide PPM</b>	<b>Hydrogen Sulfide PPM</b>	<b>Organic Vapors PPM*</b>
E.S. Front office	0.0	0.0	20.6	0	0	0.0
E.S. Elevator	0.0	0.0	20.6	0	0	0.0
E.S. Electrical closet in Mech. Room	0.0	0.0	20.5	0	0	0.0
E.S. Gym	0.0	0.0	20.7	0	0	0.0
E.S. Room 213	0.0	0.0	20.5	0	0	0.0
E.S. Library	0.0	0.0	20.6	0	0	0.0
E.S. Room 106	0.0	0.0	20.2	0	0	0.0
E.S. Stairway Stair C	0.0	0.0	20.0	0	0	0.0
E.S. Room 111	0.0	0.0	20.7	0	0	0.0
E.S. Cafeteria	0.0	0.0	20.6	0	0	0.0

**Table 2**  
**Indoor Air Monitoring Notes**  
**Springfield Street School Complex**  
**May 16, 2007**

<b>Monitoring Location</b>	<b>Methane % by volume Landtec</b>	<b>Carbon Dioxide % by volume</b>	<b>Oxygen % by volume</b>	<b>Carbon Monoxide PPM</b>	<b>Hydrogen Sulfide PPM</b>	<b>Organic Vapors PPM*</b>
<b>M.S.</b> Front Office	0.0	0.0	20.2	0	0	0.0
<b>M.S.</b> Library	0.0	0.0	20.4	0	0	0.0
<b>M.S.</b> Stairway toward Hartford Ave.	0.0	0.0	20.3	0	0	0.0
<b>M.S.</b> Crack near door to outside near gym	0.0	0.0	20.2	0	0	0.0
<b>M.S.</b> Former Music Room (Rm # 2 practise)	0.0	0.0	20.3	0	0	0.0
<b>M.S.</b> Near Sensor in cafeteria	0.0	0.0	20.3	0	0	0.0
<b>M.S.</b> Classroom 108	0.0	0.0	20.6	0	0	0.0

**Table 2**  
**Indoor Air Monitoring Notes**  
**Springfield Street School Complex**  
**May 16, 2007**

<b>Monitoring Location</b>	<b>Methane % by volume Landtec</b>	<b>Carbon Dioxide % by volume</b>	<b>Oxygen % by volume</b>	<b>Carbon Monoxide PPM</b>	<b>Hydrogen Sulfide PPM</b>	<b>Organic Vapors PPM*</b>
<b>M.S.</b> Hall outside cafeteria next to Sensor	0.0	0.0	20.3	0	0	0.0
<b>M.S.</b> Elevator	0.0	0.0	20.4	0	0	0.0
<b>Remedial Action Work Plan Action Levels</b>	<b>0.5</b>	<b>1,000 ppm (0.1%)</b>	<b>NA</b>	<b>9 ppm</b>	<b>10 ppm</b>	<b>5 ppm</b>

**Notes:**

**E.S.** indicates Elementary School

**M.S.** indicates Middle School

Measurements made with: GEM 2000 Gas Analyzer & Extraction Monitor, MiniRae PID Meter

Table 3  
 Summary of Ground Water Sampling Results  
 Springfield Street School Complex  
 Springfield Street  
 Providence, Rhode Island

Monitoring Wells	Detected Compounds	Sampling Dates and Results in µg/L																				RIDEM GB Groundwater Objective		
		2/28/2001	7/20/2001	9-12/2001	8/1/2002	8/28/2002	12/19/2002	3/18/2003	7/17/2003	11/5/2003	1/22/2004	5/21/2004	8/17/2004	12/2/2004	4/6/2005	7/27/2005	10/27&28/2005	2/2/2006	4/27/2006	8/31/2006	11/15/2006		3/27/2007	5/21/2007
ATC-1	Benzene	6.1	ND	18.9	0.9	ND	ND	ND	ND	ND	ND	ND	ND	ND	ND	ND	ND	ND	ND	ND	ND	ND	ND	140
	n-butylbenzene	1.7	ND	2.8	ND	ND	ND	ND	ND	ND	ND	ND	ND	ND	ND	ND	ND	ND	ND	ND	ND	ND	ND	NA
	sec-Butylbenzene	1.1	ND	4.1	ND	ND	ND	ND	ND	ND	ND	ND	ND	ND	ND	ND	ND	ND	ND	ND	ND	ND	ND	NA
	tert-Butylbenzene	ND	ND	ND	ND	ND	ND	ND	ND	ND	ND	ND	ND	ND	ND	ND	ND	ND	ND	ND	ND	ND	ND	NA
	Ethylbenzene	4.5	ND	12.6	ND	ND	ND	ND	ND	ND	ND	ND	ND	ND	ND	ND	ND	ND	ND	ND	ND	ND	ND	1600
	Isopropylbenzene	ND	ND	1.8	ND	ND	ND	ND	ND	ND	ND	ND	ND	ND	ND	ND	ND	ND	ND	ND	ND	ND	ND	NA
	n-Propylbenzene	ND	ND	5.0	ND	ND	ND	ND	ND	ND	ND	ND	ND	ND	ND	ND	ND	ND	ND	ND	ND	ND	ND	NA
	MTBE	12.4	7.0	28.6	ND	ND	ND	ND	ND	ND	ND	ND	ND	ND	ND	ND	ND	ND	ND	ND	ND	ND	ND	5000
	Trichloroethylene	ND	ND	ND	ND	ND	ND	ND	1.27	ND	ND	ND	ND	1.10	ND	ND	1.3	ND	ND	ND	ND	ND	ND	540
	Toluene	2.5	ND	8.2	ND	ND	ND	ND	ND	ND	ND	ND	ND	ND	ND	ND	ND	ND	ND	ND	ND	ND	ND	1700
	1,2,4-Trimethylbenzene	2.2	ND	8.2	ND	ND	ND	ND	ND	ND	ND	ND	ND	ND	ND	ND	ND	ND	ND	ND	ND	ND	ND	NA
	1,3,5-Trimethylbenzene	3.4	ND	5.2	ND	ND	ND	ND	ND	ND	ND	ND	ND	ND	ND	ND	ND	ND	ND	ND	ND	ND	ND	NA
	Xylenes	14.6	ND	37	ND	ND	ND	ND	ND	ND	ND	ND	ND	ND	ND	ND	ND	ND	ND	ND	ND	ND	ND	NA
	1,1,2-Trichloroethane	ND	ND	ND	ND	ND	ND	ND	ND	ND	ND	ND	ND	ND	ND	ND	1.2	ND	ND	ND	ND	ND	ND	NA
ATC-2	Chloroform	0.9	ND	ND	1.0	ND	ND	ND	ND	ND	NS	1.1	1.0	ND	ND	ND	ND	ND	ND	ND	ND	ND	ND	NA
ATC-3	Toluene	ND	ND	ND	ND	NS	ND	ND	ND	ND	3.03	ND	ND	ND	ND	ND	3.0	ND	4.5	13.1	ND	2.3	1700	
ATC-4	Benzene	ND	ND	2.5	0.6	ND	ND	ND	ND	ND	ND	ND	0.5	ND	ND	ND	ND	ND	ND	ND	ND	ND	ND	140
	Chlorobenzene	2.6	ND	57.3	2.7	5.18	ND	ND	ND	ND	ND	ND	ND	0.60	ND	ND	ND	ND	ND	ND	ND	ND	ND	70
	1,4-dichlorobenzene	4.2	ND	9.2	3.4	3.36	ND	ND	ND	ND	ND	0.80	1.6	2.1	ND	ND	ND	ND	ND	1.2	1.1	ND	1.2	NA
	MTBE	ND	ND	ND	ND	ND	ND	ND	1.19	9.55	1.06	2.90	0.6	ND	ND	ND	ND	ND	ND	ND	ND	ND	ND	5000
	1,2,4-Trimethylbenzene	ND	ND	1.7	ND	ND	ND	ND	ND	ND	ND	ND	ND	ND	ND	ND	ND	ND	ND	ND	ND	ND	ND	NA
ATC-5	MTBE	ND	ND	2.2	NS	ND	ND	ND	ND	NS	ND	ND	ND	ND	ND	ND	ND	ND	ND	ND	ND	ND	ND	5000
	Chloroform	ND	ND	ND	ND	ND	ND	ND	ND	NS	ND	ND	0.6	ND	ND	ND	ND	ND	ND	ND	ND	ND	ND	NA
Sampled By:		ATC	ATC	ATC	ATC	LFR	LFR	LFR	LFR	LFR	LFR	LFR	LFR	LFR	LFR	LFR	LFR	LFR	LFR	LFR	LFR	LFR	LFR	

\*ATC Monitoring Report for September through December 2001 did not list date samples were collected.

ND is not detected above method detection limit

NS is not sampled

NA= No applicable standard published

MTBE is Methyl tert-Butyl Ether

µg/L = micrograms per liter

**Table 4**  
**Soil Gas Survey Field Notes**  
**Springfield Street School Complex**  
**Providence, RI**  
**May 14 and 15, 2007**

Monitoring Well	Methane % by volume	Carbon Dioxide % by volume	Oxygen % by volume	Carbon Monoxide PPM	Hydrogen Sulfide PPM	Organic Vapors PPM
WB-1	0.0	1.5	17.8	0.0	0.0	0.0
WB-2	0.0	1.5	20.2	0.0	0.0	0.2
WB-3	0.0	0.7	21.3	0.0	0.0	0.0
WB-4	0.0	0.3	20.8	0.0	0.0	1.3
WB-5	0.0	0.1	21.2	0.0	0.0	0.1
WB-6	0.0	0.4	21.1	0.0	0.0	0.0
WB-7	0.0	0.2	20.8	0.0	0.0	0.4
WB-8	0.0	0.0	20.9	0.0	0.0	0.0
WB-12	0.0	0.3	21.1	0.0	0.0	0.1
WB-13	0.0	0.1	21.3	0.0	0.0	0.0
WB-14	0.0	0.1	17.4	0.0	0.0	0.0
WB-15	0.0	0.5	21.2	0.0	0.0	0.0
EPL-1	0.0	1.3	20.9	0.0	0.0	0.5
EPL-2	0.0	0.2	18.6	0.0	0.0	0.1
EPL-3	0.0	2.7	19.9	0.0	0.0	0.0
EPL-4	0.0	2.0	16.6	0.0	0.0	0.1
EPL-5	0.0	4.1	12.7	0.0	0.0	0.0
ENE-1	0.0	0.1	21.6	0.0	0.0	0.0
MG1	0.0	0.2	20.1	0.0	0.0	0.0
MG2	0.0	1.1	19.8	0.0	0.0	0.0
MG-3	0.0	0.1	19.8	0.0	0.0	0.0
MG-4	0.0	0.0	20.1	0.0	0.0	0.0
MG-5	0.0	0.3	21.1	0.0	0.0	0.0
MPL2	0.0	1.6	20.3	0.0	0.0	0.0
MPL3	0.0	3.1	16.8	0.0	0.0	0.0

**Table 4**  
**Soil Gas Survey Field Notes**  
**Springfield Street School Complex**  
**Providence, RI**  
**May 14 and 15, 2007**

Monitoring Well	Methane % by volume	Carbon Dioxide % by volume	Oxygen % by volume	Carbon Monoxide PPM	Hydrogen Sulfide PPM	Organic Vapors PPM
MPL5	0.0	4.2	18.3	0.0	0.0	0.0
MPL6	0.0	4.1	15.1	0.0	0.0	0.0
MPL7	0.0	2.3	14.6	0.0	0.0	0.0
MPL8	0.0	1.0	17.5	0.0	0.0	0.0
<b>Remedial Action Work Plan Action Levels</b>	<b>0.5%</b>	<b>1,000 PPM</b>	<b>NA</b>	<b>9 PPM</b>	<b>10 PPM</b>	<b>5 PPM</b>

**Sampled by:** Janelle Bonn

**Weather Conditions:** ~ 65° F. overcast on 5/14 , ~ 72° F. overcast on 5/15

**Sampling Equipment:** Landtec Gem 2000 Plus Gas Analyzer (Methane, CO<sub>2</sub>, O<sub>2</sub>, H<sub>2</sub>S and CO), and MiniRAE 2000 (organic vapors), SKC pump.

**Table 5**  
**Soil Gas Laboratory Analysis Results**  
**Springfield Street School Complex**  
**May 17, 2007**

Parameter	OSHA PELs (PPBv)	Results of Analysis in parts per billion by volume (PPBv)	
		MPL-6	WB-2
Benzene	1,000	0.36	0.29
Chloroform	50,000	3.2	<0.1
Chloromethane	100,000	0.24	0.11
Dichlorodifluoromethane	1,000,000	<0.1	0.5
1,4-Dichlorobenzene	75,000	<0.1	0.16
Ethylbenzene	100,000	0.75	0.55
Methylene Chloride	100,000	<0.1	0.53
Styrene	100,000	1.6	1.0
Tetrachloroethylene	100,000	0.19	0.16
Toluene	200,000	17	12
Trichlorofluoromethane (Freon 11)	1,000,000	<0.1	0.41
1,3,5-Trimethylbenzene	None	0.12	<0.1
1,2,4-Trimethylbenzene	None	<0.1	1.0
M/p-Xylene	100,000	3.1	2.5
o-Xylene	100,000	0.61	0.56

Table lists only detected compounds. See laboratory report for full list of analytes.

Occupational Safety and Health Administration (OSHA) PELs = Permissible Exposure Limits from NIOSH Pocket Guide to Chemical Hazards



**Attachment A**

**Laboratory Report for Soil Gas and Groundwater**



39 Spruce Street ° East Longmeadow, MA 01028 ° FAX 413/525-6405 ° TEL. 413/525-2332

REPORT DATE 5/30/2007

LFR, INC. - RI  
300 METRO CENTER BLVD., SUITE 250  
WARWICK, RI 02886  
ATTN: DONNA PALLISTER

CONTRACT NUMBER:  
PURCHASE ORDER NUMBER: 5131

PROJECT NUMBER:

**ANALYTICAL SUMMARY**

LIMS BAT #: LIMIT-06424  
JOB NUMBER: 081-12152-03

The results of analyses performed on the following samples submitted to the CON-TEST Analytical Laboratory are found in this report.

PROJECT LOCATION: SPRINGFIELD ST. SCHOOL

FIELD SAMPLE #	LAB ID	MATRIX	SAMPLE DESCRIPTION	TEST
ATC-1	07B18763	GRND WATER	NOT SPECIFIED	8260 water
ATC-2	07B18764	GRND WATER	NOT SPECIFIED	8260 water
ATC-3	07B18765	GRND WATER	NOT SPECIFIED	8260 water
ATC-4	07B18766	GRND WATER	NOT SPECIFIED	8260 water
ATC-5	07B18767	GRND WATER	NOT SPECIFIED	8260 water
MPL-6	07B18769	AIR	NOT SPECIFIED	to-14 ppbv
MPL-6	07B18769	AIR	NOT SPECIFIED	to-14 ug/m3
WB-2	07B18768	AIR	NOT SPECIFIED	to-14 ppbv
WB-2	07B18768	AIR	NOT SPECIFIED	to-14 ug/m3



39 Spruce Street ° East Longmeadow, MA 01028 ° FAX 413/525-6405 ° TEL. 413/525-2332

REPORT DATE 5/30/2007

LFR, INC. - RI  
300 METRO CENTER BLVD., SUITE 250  
WARWICK, RI 02886  
ATTN: DONNA PALLISTER

CONTRACT NUMBER:  
PURCHASE ORDER NUMBER: 5131

PROJECT NUMBER:

ANALYTICAL SUMMARY

LIMS BAT #: LIMIT-06424  
JOB NUMBER: 081-12152-03

The results of analyses performed on the following samples submitted to the CON-TEST Analytical Laboratory are found in this report.

Comments :

LIMS BATCH NO. : LIMIT-06424

IN METHOD TO-14, ANY REPORTED RESULT FOR CHLOROETHANE OR TRICHLOROFLUOROMETHANE IS ESTIMATED.

IN METHOD TO-14, ANY REPORTED RESULT FOR TRICHLOROFLUOROMETHANE OR 1,2,4-TRIMETHYLBENZENE IS LIKELY TO BE BIASED ON THE HIGH SIDE BASED ON LABORATORY FORTIFIED BLANK RECOVERY BIAS.

IN METHOD 8260, FOR SAMPLE(S) 07B18763-07B18765 AND 07B18767, ANY REPORTED RESULTS FOR BROMOMETHANE, CHLOROETHANE, 1,4-DIOXANE, ACETONE, CARBON TETRACHLORIDE, DIBROMOCHLOROMETHANE, 1,1,1,2-TETRACHLOROETHANE, AND BROMOFORM ARE ESTIMATED. EITHER INITIAL OR CONTINUING CALIBRATION DID NOT MEET REQUIRED CRITERIA.

IN METHOD 8260, FOR SAMPLE 07B18766, ANY REPORTED RESULTS FOR BROMOMETHANE, CHLOROETHANE, 1,4-DIOXANE, AND ACETONE ARE ESTIMATED. EITHER INITIAL OR CONTINUING CALIBRATION DID NOT MEET REQUIRED CRITERIA.

IN METHOD 8260, FOR SAMPLE 07B18766, LABORATORY FORTIFIED BLANK RECOVERY FOR DICHLORODIFLUOROMETHANE IS OUTSIDE OF CONTROL LIMITS. ANY REPORTED RESULTS FOR THIS COMPOUND ARE LIKELY TO BE BIASED ON THE LOW SIDE.

The CON-TEST Environmental Laboratory operates under the following certifications and accreditations :

AIHA 100033	AIHA ELLAP (LEAD) 100033	
MASSACHUSETTS MA0100	NEW HAMPSHIRE NELAP 2516	NEW JERSEY NELAP NJ MA007 (AIR)
CONNECTICUT PH-0567	VERMONT DOH (LEAD) No. LL015036	
NEW YORK ELAP/NELAP 10899	RHODE ISLAND (LIC. No. 112)	

I certify that the analyses listed above, unless specifically listed as subcontracted, if any, were performed under my direction according to the approved methodologies listed in this document, and that based upon my inquiry of those individuals immediately responsible for obtaining the information, the material contained in this report is, to the best of my knowledge and belief, accurate and complete.

*Tod Kopyscinski* 5/30/07  
SIGNATURE DATE

Tod Kopyscinski  
Director of Operations

Sondra L. Slesinski  
Quality Assurance Officer

Edward Denson  
Technical Director

\* See end of data tabulation for notes and comments pertaining to this sample



39 Spruce Street ° East Longmeadow, MA 01028 ° FAX 413/525-6405 ° TEL. 413/525-2332

DONNA PALLISTER  
LFR, INC. - RI  
300 METRO CENTER BLVD., SUITE 250  
WARWICK, RI 02886

5/30/2007  
Page 1 of 24

Purchase Order No.: 5131

Project Location: SPRINGFIELD ST. SCHOOL  
Date Received: 5/22/2007  
Field Sample #: ATC-1

LIMS-BAT #: LIMIT-06424  
Job Number: 081-12152-03

Sample ID : 07B18763                      Sampled : 5/21/2007  
NOT SPECIFIED

Sample Matrix: GRND WATER

	Units	Results	Date Analyzed	Analyst	RL	SPEC Limit		P/ F
						Lo	Hi	
Acetone	ug/l	ND	05/24/07	LBD	50.0			
Acrylonitrile	ug/l	ND	05/24/07	LBD	5.0			
tert-Amylmethyl Ether	ug/l	ND	05/24/07	LBD	0.5			
Benzene	ug/l	ND	05/24/07	LBD	1.0			
Bromobenzene	ug/l	ND	05/24/07	LBD	1.0			
Bromochloromethane	ug/l	ND	05/24/07	LBD	1.0			
Bromodichloromethane	ug/l	ND	05/24/07	LBD	1.0			
Bromoform	ug/l	ND	05/24/07	LBD	1.0			
Bromomethane	ug/l	ND	05/24/07	LBD	10.0			
2-Butanone (MEK)	ug/l	ND	05/24/07	LBD	20.0			
tert-Butyl Alcohol	ug/l	ND	05/24/07	LBD	20.0			
n-Butylbenzene	ug/l	ND	05/24/07	LBD	1.0			
sec-Butylbenzene	ug/l	ND	05/24/07	LBD	1.0			
tert-Butylbenzene	ug/l	ND	05/24/07	LBD	1.0			
tert-Butylethyl Ether	ug/l	ND	05/24/07	LBD	0.5			
Carbon Disulfide	ug/l	ND	05/24/07	LBD	3.0			
Carbon Tetrachloride	ug/l	ND	05/24/07	LBD	1.0			
Chlorobenzene	ug/l	ND	05/24/07	LBD	1.0			
Chlorodibromomethane	ug/l	ND	05/24/07	LBD	0.5			
Chloroethane	ug/l	ND	05/24/07	LBD	2.0			
Chloroform	ug/l	ND	05/24/07	LBD	2.0			
Chloromethane	ug/l	ND	05/24/07	LBD	2.0			
2-Chlorotoluene	ug/l	ND	05/24/07	LBD	1.0			
4-Chlorotoluene	ug/l	ND	05/24/07	LBD	1.0			
1,2-Dibromo-3-Chloropropane	ug/l	ND	05/24/07	LBD	5.0			
1,2-Dibromoethane	ug/l	ND	05/24/07	LBD	0.50			
Dibromomethane	ug/l	ND	05/24/07	LBD	1.0			
1,2-Dichlorobenzene	ug/l	ND	05/24/07	LBD	1.0			
1,3-Dichlorobenzene	ug/l	ND	05/24/07	LBD	1.0			
1,4-Dichlorobenzene	ug/l	ND	05/24/07	LBD	1.0			

RL = Reporting Limit

ND = Not Detected at or above the Reporting Limit

NM = Not Measured

SPEC LIMIT = a client specified recommended or regulatory level for comparison with data to determine PASS (P) or FAIL (F) condition of results.

\* = See end of report for comments and notes applying to this sample



39 Spruce Street ° East Longmeadow, MA 01028 ° FAX 413/525-6405 ° TEL. 413/525-2332

DONNA PALLISTER  
LFR, INC. - RI  
300 METRO CENTER BLVD., SUITE 250  
WARWICK, RI 02886

5/30/2007  
Page 2 of 24

Project Location: SPRINGFIELD ST. SCHOOL  
Date Received: 5/22/2007  
Field Sample #: ATC-1

Purchase Order No.: 5131

LIMS-BAT #: L1MT-06424  
Job Number: 081-12152-03

Sample ID : 07B18763                      Sampled : 5/21/2007  
NOT SPECIFIED

Sample Matrix: GRND WATER

	Units	Results	Date Analyzed	Analyst	RL	SPEC Limit		P/ F
						Lo	Hi	
trans-1,4-Dichloro-2-Butene	ug/l	ND	05/24/07	LBD	2.0			
Dichlorodifluoromethane	ug/l	ND	05/24/07	LBD	2.0			
1,1-Dichloroethane	ug/l	ND	05/24/07	LBD	1.0			
1,2-Dichloroethane	ug/l	ND	05/24/07	LBD	1.0			
1,1-Dichloroethylene	ug/l	ND	05/24/07	LBD	1.0			
cis-1,2-Dichloroethylene	ug/l	ND	05/24/07	LBD	1.0			
trans-1,2-Dichloroethylene	ug/l	ND	05/24/07	LBD	1.0			
1,2-Dichloropropane	ug/l	ND	05/24/07	LBD	1.0			
1,3-Dichloropropane	ug/l	ND	05/24/07	LBD	0.5			
2,2-Dichloropropane	ug/l	ND	05/24/07	LBD	1.0			
1,1-Dichloropropene	ug/l	ND	05/24/07	LBD	2.0			
cis-1,3-Dichloropropene	ug/l	ND	05/24/07	LBD	0.5			
trans-1,3-Dichloropropene	ug/l	ND	05/24/07	LBD	0.5			
Diethyl Ether	ug/l	ND	05/24/07	LBD	2.0			
Diisopropyl Ether	ug/l	ND	05/24/07	LBD	0.5			
1,4-Dioxane	ug/l	ND	05/24/07	LBD	50.0			
Ethyl Benzene	ug/l	ND	05/24/07	LBD	1.0			
Hexachlorobutadiene	ug/l	ND	05/24/07	LBD	1.0			
2-Hexanone	ug/l	ND	05/24/07	LBD	10.0			
Isopropylbenzene	ug/l	ND	05/24/07	LBD	1.0			
p-Isopropyltoluene	ug/l	ND	05/24/07	LBD	1.0			
MTBE	ug/l	ND	05/24/07	LBD	1.0			
Methylene Chloride	ug/l	ND	05/24/07	LBD	5.0			
MIBK	ug/l	ND	05/24/07	LBD	10.0			
Naphthalene	ug/l	ND	05/24/07	LBD	2.0			
n-Propylbenzene	ug/l	ND	05/24/07	LBD	1.0			
Styrene	ug/l	ND	05/24/07	LBD	1.0			
1,1,1,2-Tetrachloroethane	ug/l	ND	05/24/07	LBD	1.0			
1,1,2,2-Tetrachloroethane	ug/l	ND	05/24/07	LBD	0.5			
Tetrachloroethylene	ug/l	ND	05/24/07	LBD	1.0			

RL = Reporting Limit

ND = Not Detected at or above the Reporting Limit

NM = Not Measured

SPEC LIMIT = a client specified recommended or regulatory level for comparison with data to determine PASS (P) or FAIL (F) condition of results.

\* = See end of report for comments and notes applying to this sample



39 Spruce Street ° East Longmeadow, MA 01028 ° FAX 413/525-6405 ° TEL. 413/525-2332

DONNA PALLISTER  
LFR, INC. - RI  
300 METRO CENTER BLVD., SUITE 250  
WARWICK, RI 02886

Purchase Order No.: 5131

5/30/2007  
Page 3 of 24

Project Location: SPRINGFIELD ST. SCHOOL  
Date Received: 5/22/2007  
Field Sample #: ATC-1

LIMS-BAT #: LIMIT-06424  
Job Number: 081-12152-03

Sample ID : 07B18763                      Sampled : 5/21/2007  
NOT SPECIFIED

Sample Matrix: GRND WATER

	Units	Results	Date Analyzed	Analyst	RL	SPEC Limit		P/ F
						Lo	Hi	
Tetrahydrofuran	ug/l	ND	05/24/07	LBD	10.0			
Toluene	ug/l	ND	05/24/07	LBD	1.0			
1,2,3-Trichlorobenzene	ug/l	ND	05/24/07	LBD	5.0			
1,2,4-Trichlorobenzene	ug/l	ND	05/24/07	LBD	1.0			
1,1,1-Trichloroethane	ug/l	ND	05/24/07	LBD	1.0			
1,1,2-Trichloroethane	ug/l	ND	05/24/07	LBD	1.0			
Trichloroethylene	ug/l	ND	05/24/07	LBD	1.0			
Trichlorofluoromethane	ug/l	ND	05/24/07	LBD	2.0			
1,2,3-Trichloropropane	ug/l	ND	05/24/07	LBD	2.0			
1,1,2-Trichloro-1,2,2-Trifluoroethane	ug/l	ND	05/24/07	LBD	5.0			
1,2,4-Trimethylbenzene	ug/l	ND	05/24/07	LBD	1.0			
1,3,5-Trimethylbenzene	ug/l	ND	05/24/07	LBD	1.0			
Vinyl Chloride	ug/l	ND	05/24/07	LBD	2.0			
m + p Xylene	ug/l	ND	05/24/07	LBD	2.0			
o-Xylene	ug/l	ND	05/24/07	LBD	1.0			

Analytical Method:  
SW846 8260

SAMPLES ARE CONCENTRATED BY PURGE & TRAP, FOLLOWED BY GC/MS TARGET COMPOUND ANALYSIS. REPORTED RESULTS AND REPORTING LIMITS FOR 1,4-DIOXANE AND TERT-BUTYLALCOHOL ARE ESTIMATED SINCE RESPONSE FACTORS FOR THESE COMPOUNDS ARE BELOW METHOD SPECIFICATIONS.

RL = Reporting Limit

ND = Not Detected at or above the Reporting Limit

NM = Not Measured

SPEC LIMIT = a client specified recommended or regulatory level for comparison with data to determine PASS (P) or FAIL (F) condition of results.

\* = See end of report for comments and notes applying to this sample



39 Spruce Street ° East Longmeadow, MA 01028 ° FAX 413/525-6405 ° TEL. 413/525-2332

DONNA PALLISTER  
LFR, INC. - RI  
300 METRO CENTER BLVD., SUITE 250  
WARWICK, RI 02886

5/30/2007  
Page 4 of 24

Purchase Order No.: 5131

Project Location: SPRINGFIELD ST. SCHOOL  
Date Received: 5/22/2007  
Field Sample #: ATC-2

LIMS-BAT #: LIMIT-06424  
Job Number: 081-12152-03

Sample ID: 07B18764  
Sampled: 5/17/2007  
NOT SPECIFIED

Sample Matrix: GRND WATER

	Units	Results	Date Analyzed	Analyst	RL	SPEC Limit		P/ F
						Lo	Hi	
Acetone	ug/l	ND	05/24/07	LBD	50.0			
Acrylonitrile	ug/l	ND	05/24/07	LBD	5.0			
tert-Amylmethyl Ether	ug/l	ND	05/24/07	LBD	0.5			
Benzene	ug/l	ND	05/24/07	LBD	1.0			
Bromobenzene	ug/l	ND	05/24/07	LBD	1.0			
Bromochloromethane	ug/l	ND	05/24/07	LBD	1.0			
Bromodichloromethane	ug/l	ND	05/24/07	LBD	1.0			
Bromoform	ug/l	ND	05/24/07	LBD	1.0			
Bromomethane	ug/l	ND	05/24/07	LBD	10.0			
2-Butanone (MEK)	ug/l	ND	05/24/07	LBD	20.0			
tert-Butyl Alcohol	ug/l	ND	05/24/07	LBD	20.0			
n-Butylbenzene	ug/l	ND	05/24/07	LBD	1.0			
sec-Butylbenzene	ug/l	ND	05/24/07	LBD	1.0			
tert-Butylbenzene	ug/l	ND	05/24/07	LBD	1.0			
tert-Butylethyl Ether	ug/l	ND	05/24/07	LBD	0.5			
Carbon Disulfide	ug/l	ND	05/24/07	LBD	3.0			
Carbon Tetrachloride	ug/l	ND	05/24/07	LBD	1.0			
Chlorobenzene	ug/l	ND	05/24/07	LBD	1.0			
Chlorodibromomethane	ug/l	ND	05/24/07	LBD	0.5			
Chloroethane	ug/l	ND	05/24/07	LBD	2.0			
Chloroform	ug/l	ND	05/24/07	LBD	2.0			
Chloromethane	ug/l	ND	05/24/07	LBD	2.0			
2-Chlorotoluene	ug/l	ND	05/24/07	LBD	1.0			
4-Chlorotoluene	ug/l	ND	05/24/07	LBD	1.0			
1,2-Dibromo-3-Chloropropane	ug/l	ND	05/24/07	LBD	5.0			
1,2-Dibromoethane	ug/l	ND	05/24/07	LBD	0.50			
Dibromomethane	ug/l	ND	05/24/07	LBD	1.0			
1,2-Dichlorobenzene	ug/l	ND	05/24/07	LBD	1.0			
1,3-Dichlorobenzene	ug/l	ND	05/24/07	LBD	1.0			
1,4-Dichlorobenzene	ug/l	ND	05/24/07	LBD	1.0			

RL = Reporting Limit

ND = Not Detected at or above the Reporting Limit

NM = Not Measured

SPEC LIMIT = a client specified recommended or regulatory level for comparison with data to determine PASS (P) or FAIL (F) condition of results.

\* = See end of report for comments and notes applying to this sample



39 Spruce Street ° East Longmeadow, MA 01028 ° FAX 413/525-6405 ° TEL. 413/525-2332

DONNA PALLISTER  
 LFR, INC. - RI  
 300 METRO CENTER BLVD., SUITE 250  
 WARWICK, RI 02886

5/30/2007  
 Page 5 of 24

Purchase Order No.: 5131

Project Location: SPRINGFIELD ST. SCHOOL  
 Date Received: 5/22/2007  
 Field Sample #: ATC-2

LIMS-BAT #: LIMIT-06424  
 Job Number: 081-12152-03

Sample ID : 07B18764      Sampled : 5/17/2007  
 NOT SPECIFIED

Sample Matrix: GRND WATER

	Units	Results	Date Analyzed	Analyst	RL	SPEC Limit		P/ F
						Lo	Hi	
trans-1,4-Dichloro-2-Butene	ug/l	ND	05/24/07	LBD	2.0			
Dichlorodifluoromethane	ug/l	ND	05/24/07	LBD	2.0			
1,1-Dichloroethane	ug/l	ND	05/24/07	LBD	1.0			
1,2-Dichloroethane	ug/l	ND	05/24/07	LBD	1.0			
1,1-Dichloroethylene	ug/l	ND	05/24/07	LBD	1.0			
cis-1,2-Dichloroethylene	ug/l	ND	05/24/07	LBD	1.0			
trans-1,2-Dichloroethylene	ug/l	ND	05/24/07	LBD	1.0			
1,2-Dichloropropane	ug/l	ND	05/24/07	LBD	1.0			
1,3-Dichloropropane	ug/l	ND	05/24/07	LBD	0.5			
2,2-Dichloropropane	ug/l	ND	05/24/07	LBD	1.0			
1,1-Dichloropropene	ug/l	ND	05/24/07	LBD	2.0			
cis-1,3-Dichloropropene	ug/l	ND	05/24/07	LBD	0.5			
trans-1,3-Dichloropropene	ug/l	ND	05/24/07	LBD	0.5			
Diethyl Ether	ug/l	ND	05/24/07	LBD	2.0			
Diisopropyl Ether	ug/l	ND	05/24/07	LBD	0.5			
1,4-Dioxane	ug/l	ND	05/24/07	LBD	50.0			
Ethyl Benzene	ug/l	ND	05/24/07	LBD	1.0			
Hexachlorobutadiene	ug/l	ND	05/24/07	LBD	1.0			
2-Hexanone	ug/l	ND	05/24/07	LBD	10.0			
Isopropylbenzene	ug/l	ND	05/24/07	LBD	1.0			
p-Isopropyltoluene	ug/l	ND	05/24/07	LBD	1.0			
MTBE	ug/l	ND	05/24/07	LBD	1.0			
Methylene Chloride	ug/l	ND	05/24/07	LBD	5.0			
MIBK	ug/l	ND	05/24/07	LBD	10.0			
Naphthalene	ug/l	ND	05/24/07	LBD	2.0			
n-Propylbenzene	ug/l	ND	05/24/07	LBD	1.0			
Styrene	ug/l	ND	05/24/07	LBD	1.0			
1,1,1,2-Tetrachloroethane	ug/l	ND	05/24/07	LBD	1.0			
1,1,2,2-Tetrachloroethane	ug/l	ND	05/24/07	LBD	0.5			
Tetrachloroethylene	ug/l	ND	05/24/07	LBD	1.0			

RL = Reporting Limit

ND = Not Detected at or above the Reporting Limit

NM = Not Measured

SPEC LIMIT = a client specified recommended or regulatory level for comparison with data to determine PASS (P) or FAIL (F) condition of results.

\* = See end of report for comments and notes applying to this sample





39 Spruce Street ° East Longmeadow, MA 01028 ° FAX 413/525-6405 ° TEL. 413/525-2332

DONNA PALLISTER  
LFR, INC. - RI  
300 METRO CENTER BLVD., SUITE 250  
WARWICK, RI 02886

Purchase Order No.: 5131

5/30/2007  
Page 6 of 24

Project Location: SPRINGFIELD ST. SCHOOL  
Date Received: 5/22/2007  
Field Sample #: ATC-2

LIMS-BAT #: LIMT-06424  
Job Number: 081-12152-03

Sample ID: 07B18764  
Sampled: 5/17/2007  
NOT SPECIFIED

Sample Matrix: GRND WATER

	Units	Results	Date Analyzed	Analyst	RL	SPEC Limit		P/ F
						Lo	Hi	
Tetrahydrofuran	ug/l	ND	05/24/07	LBD	10.0			
Toluene	ug/l	ND	05/24/07	LBD	1.0			
1,2,3-Trichlorobenzene	ug/l	ND	05/24/07	LBD	5.0			
1,2,4-Trichlorobenzene	ug/l	ND	05/24/07	LBD	1.0			
1,1,1-Trichloroethane	ug/l	ND	05/24/07	LBD	1.0			
1,1,2-Trichloroethane	ug/l	ND	05/24/07	LBD	1.0			
Trichloroethylene	ug/l	ND	05/24/07	LBD	1.0			
Trichlorofluoromethane	ug/l	ND	05/24/07	LBD	2.0			
1,2,3-Trichloropropane	ug/l	ND	05/24/07	LBD	2.0			
1,1,2-Trichloro-1,2,2-Trifluoroethane	ug/l	ND	05/24/07	LBD	5.0			
1,2,4-Trimethylbenzene	ug/l	ND	05/24/07	LBD	1.0			
1,3,5-Trimethylbenzene	ug/l	ND	05/24/07	LBD	1.0			
Vinyl Chloride	ug/l	ND	05/24/07	LBD	2.0			
m + p Xylene	ug/l	ND	05/24/07	LBD	2.0			
o-Xylene	ug/l	ND	05/24/07	LBD	1.0			

Analytical Method:  
SW846 8260

SAMPLES ARE CONCENTRATED BY PURGE & TRAP, FOLLOWED BY GC/MS TARGET COMPOUND ANALYSIS. REPORTED RESULTS AND REPORTING LIMITS FOR 1,4-DIOXANE AND TERT-BUTYLALCOHOL ARE ESTIMATED SINCE RESPONSE FACTORS FOR THESE COMPOUNDS ARE BELOW METHOD SPECIFICATIONS.

RL = Reporting Limit

ND = Not Detected at or above the Reporting Limit

NM = Not Measured

\* = See end of report for comments and notes applying to this sample

SPEC LIMIT = a client specified recommended or regulatory level for comparison with data to determine PASS (P) or FAIL (F) condition of results.



39 Spruce Street ° East Longmeadow, MA 01028 ° FAX 413/525-6405 ° TEL. 413/525-2332

DONNA PALLISTER  
LFR, INC. - RI  
300 METRO CENTER BLVD., SUITE 250  
WARWICK, RI 02886

5/30/2007  
Page 7 of 24

Project Location: SPRINGFIELD ST. SCHOOL  
Date Received: 5/22/2007  
Field Sample # : ATC-3

Purchase Order No.: 5131

LIMS-BAT #: LIMIT-06424  
Job Number: 081-12152-03

Sample ID : 07B18765                      Sampled : 5/17/2007  
NOT SPECIFIED

Sample Matrix: GRND WATER

	Units	Results	Date Analyzed	Analyst	RL	SPEC Limit		P/ F
						Lo	Hi	
Acelone	ug/l	ND	05/24/07	LBD	50.0			
Acrylonitrile	ug/l	ND	05/24/07	LBD	5.0			
tert-Amylmethyl Ether	ug/l	ND	05/24/07	LBD	0.5			
Benzene	ug/l	ND	05/24/07	LBD	1.0			
Bromobenzene	ug/l	ND	05/24/07	LBD	1.0			
Bromochloromethane	ug/l	ND	05/24/07	LBD	1.0			
Bromodichloromethane	ug/l	ND	05/24/07	LBD	1.0			
Bromoform	ug/l	ND	05/24/07	LBD	1.0			
Bromomethane	ug/l	ND	05/24/07	LBD	10.0			
2-Butanone (MEK)	ug/l	ND	05/24/07	LBD	20.0			
tert-Butyl Alcohol	ug/l	ND	05/24/07	LBD	20.0			
n-Butylbenzene	ug/l	ND	05/24/07	LBD	1.0			
sec-Butylbenzene	ug/l	ND	05/24/07	LBD	1.0			
tert-Butylbenzene	ug/l	ND	05/24/07	LBD	1.0			
tert-Butylethyl Ether	ug/l	ND	05/24/07	LBD	0.5			
Carbon Disulfide	ug/l	ND	05/24/07	LBD	3.0			
Carbon Tetrachloride	ug/l	ND	05/24/07	LBD	1.0			
Chlorobenzene	ug/l	ND	05/24/07	LBD	1.0			
Chlorodibromomethane	ug/l	ND	05/24/07	LBD	0.5			
Chloroethane	ug/l	ND	05/24/07	LBD	2.0			
Chloroform	ug/l	ND	05/24/07	LBD	2.0			
Chloromethane	ug/l	ND	05/24/07	LBD	2.0			
2-Chlorotoluene	ug/l	ND	05/24/07	LBD	1.0			
4-Chlorotoluene	ug/l	ND	05/24/07	LBD	1.0			
1,2-Dibromo-3-Chloropropane	ug/l	ND	05/24/07	LBD	5.0			
1,2-Dibromoethane	ug/l	ND	05/24/07	LBD	0.50			
Dibromomethane	ug/l	ND	05/24/07	LBD	1.0			
1,2-Dichlorobenzene	ug/l	ND	05/24/07	LBD	1.0			
1,3-Dichlorobenzene	ug/l	ND	05/24/07	LBD	1.0			
1,4-Dichlorobenzene	ug/l	ND	05/24/07	LBD	1.0			

RL = Reporting Limit

ND = Not Detected at or above the Reporting Limit

NM = Not Measured

SPEC LIMIT = a client specified recommended or regulatory level for comparison with data to determine PASS (P) or FAIL (F) condition of results.

\* = See end of report for comments and notes applying to this sample



39 Spruce Street ° East Longmeadow, MA 01028 ° FAX 413/525-6405 ° TEL. 413/525-2332

DONNA PALLISTER  
LFR, INC. - RI  
300 METRO CENTER BLVD., SUITE 250  
WARWICK, RI 02886

5/30/2007  
Page 8 of 24

Purchase Order No.: 5131

Project Location: SPRINGFIELD ST. SCHOOL  
Date Received: 5/22/2007  
Field Sample #: ATC-3

LIMS-BAT #: LIMIT-06424  
Job Number: 081-12152-03

Sample ID: 07B18765      Sampled: 5/17/2007  
NOT SPECIFIED

Sample Matrix: GRND WATER

	Units	Results	Date Analyzed	Analyst	RL	SPEC Limit		P/ F
						Lo	Hi	
trans-1,4-Dichloro-2-Butene	ug/l	ND	05/24/07	LBD	2.0			
Dichlorodifluoromethane	ug/l	ND	05/24/07	LBD	2.0			
1,1-Dichloroethane	ug/l	ND	05/24/07	LBD	1.0			
1,2-Dichloroethane	ug/l	ND	05/24/07	LBD	1.0			
1,1-Dichloroethylene	ug/l	ND	05/24/07	LBD	1.0			
cis-1,2-Dichloroethylene	ug/l	ND	05/24/07	LBD	1.0			
trans-1,2-Dichloroethylene	ug/l	ND	05/24/07	LBD	1.0			
1,2-Dichloropropane	ug/l	ND	05/24/07	LBD	1.0			
1,3-Dichloropropane	ug/l	ND	05/24/07	LBD	0.5			
2,2-Dichloropropane	ug/l	ND	05/24/07	LBD	1.0			
1,1-Dichloropropene	ug/l	ND	05/24/07	LBD	2.0			
cis-1,3-Dichloropropene	ug/l	ND	05/24/07	LBD	0.5			
trans-1,3-Dichloropropene	ug/l	ND	05/24/07	LBD	0.5			
Diethyl Ether	ug/l	ND	05/24/07	LBD	2.0			
Diisopropyl Ether	ug/l	ND	05/24/07	LBD	0.5			
1,4-Dioxane	ug/l	ND	05/24/07	LBD	50.0			
Ethyl Benzene	ug/l	ND	05/24/07	LBD	1.0			
Hexachlorobutadiene	ug/l	ND	05/24/07	LBD	1.0			
2-Hexanone	ug/l	ND	05/24/07	LBD	10.0			
Isopropylbenzene	ug/l	ND	05/24/07	LBD	1.0			
p-Isopropyltoluene	ug/l	ND	05/24/07	LBD	1.0			
MTBE	ug/l	ND	05/24/07	LBD	1.0			
Methylene Chloride	ug/l	ND	05/24/07	LBD	5.0			
MIBK	ug/l	ND	05/24/07	LBD	10.0			
Naphthalene	ug/l	ND	05/24/07	LBD	2.0			
n-Propylbenzene	ug/l	ND	05/24/07	LBD	1.0			
Styrene	ug/l	ND	05/24/07	LBD	1.0			
1,1,1,2-Tetrachloroethane	ug/l	ND	05/24/07	LBD	1.0			
1,1,2,2-Tetrachloroethane	ug/l	ND	05/24/07	LBD	0.5			
Tetrachloroethylene	ug/l	ND	05/24/07	LBD	1.0			

RL = Reporting Limit

ND = Not Detected at or above the Reporting Limit

NM = Not Measured

\* = See end of report for comments and notes applying to this sample

SPEC LIMIT = a client specified recommended or regulatory level for comparison with data to determine PASS (P) or FAIL (F) condition of results.



39 Spruce Street ° East Longmeadow, MA 01028 ° FAX 413/525-6405 ° TEL. 413/525-2332

DONNA PALLISTER  
 LFR, INC. - RI  
 300 METRO CENTER BLVD., SUITE 250  
 WARWICK, RI 02886

Purchase Order No.: 5131

5/30/2007  
 Page 9 of 24

Project Location: SPRINGFIELD ST. SCHOOL  
 Date Received: 5/22/2007  
 Field Sample #: ATC-3

LIMS-BAT #: LIMIT-06424  
 Job Number: 081-12152-03

Sample ID : 07B18765                      Sampled : 5/17/2007  
 NOT SPECIFIED

Sample Matrix: GRND WATER

	Units	Results	Date Analyzed	Analyst	RL	SPEC Limit		P/ F
						Lo	Hi	
Tetrahydrofuran	ug/l	ND	05/24/07	LBD	10.0			
Toluene	ug/l	2.3	05/24/07	LBD	1.0			
1,2,3-Trichlorobenzene	ug/l	ND	05/24/07	LBD	5.0			
1,2,4-Trichlorobenzene	ug/l	ND	05/24/07	LBD	1.0			
1,1,1-Trichloroethane	ug/l	ND	05/24/07	LBD	1.0			
1,1,2-Trichloroethane	ug/l	ND	05/24/07	LBD	1.0			
Trichloroethylene	ug/l	ND	05/24/07	LBD	1.0			
Trichlorofluoromethane	ug/l	ND	05/24/07	LBD	2.0			
1,2,3-Trichloropropane	ug/l	ND	05/24/07	LBD	2.0			
1,1,2-Trichloro-1,2,2-Trifluoroethane	ug/l	ND	05/24/07	LBD	5.0			
1,2,4-Trimethylbenzene	ug/l	ND	05/24/07	LBD	1.0			
1,3,5-Trimethylbenzene	ug/l	ND	05/24/07	LBD	1.0			
Vinyl Chloride	ug/l	ND	05/24/07	LBD	2.0			
m + p Xylene	ug/l	ND	05/24/07	LBD	2.0			
o-Xylene	ug/l	ND	05/24/07	LBD	1.0			

Analytical Method:  
 SW846 8260

SAMPLES ARE CONCENTRATED BY PURGE & TRAP, FOLLOWED BY GC/MS TARGET COMPOUND ANALYSIS. REPORTED RESULTS AND REPORTING LIMITS FOR 1,4-DIOXANE AND TERT-BUTYLALCOHOL ARE ESTIMATED SINCE RESPONSE FACTORS FOR THESE COMPOUNDS ARE BELOW METHOD SPECIFICATIONS.

RL = Reporting Limit

ND = Not Detected at or above the Reporting Limit

NM = Not Measured

\* = See end of report for comments and notes applying to this sample

SPEC LIMIT = a client specified recommended or regulatory level for comparison with data to determine PASS (P) or FAIL (F) condition of results.



39 Spruce Street ° East Longmeadow, MA 01028 ° FAX 413/525-6405 ° TEL. 413/525-2332

DONNA PALLISTER  
LFR, INC. - RI  
300 METRO CENTER BLVD., SUITE 250  
WARWICK, RI 02886

5/30/2007  
Page 10 of 24

Purchase Order No.: 5131

Project Location: SPRINGFIELD ST. SCHOOL  
Date Received: 5/22/2007  
Field Sample #: ATC-4

LIMS-BAT #: LIMT-06424  
Job Number: 081-12152-03

Sample ID: 07B18766  
Sampled: 5/17/2007  
NOT SPECIFIED

Sample Matrix: GRND WATER

	Units	Results	Date Analyzed	Analyst	RL	SPEC Limit		P/ F
						Lo	Hi	
Acetone	ug/l	ND	05/25/07	LBD	50.0			
Acrylonitrile	ug/l	ND	05/25/07	LBD	5.0			
tert-Amylmethyl Ether	ug/l	ND	05/25/07	LBD	0.5			
Benzene	ug/l	ND	05/25/07	LBD	1.0			
Bromobenzene	ug/l	ND	05/25/07	LBD	1.0			
Bromochloromethane	ug/l	ND	05/25/07	LBD	1.0			
Bromodichloromethane	ug/l	ND	05/25/07	LBD	1.0			
Bromoform	ug/l	ND	05/25/07	LBD	1.0			
Bromomethane	ug/l	ND	05/25/07	LBD	10.0			
2-Butanone (MEK)	ug/l	ND	05/25/07	LBD	20.0			
tert-Butyl Alcohol	ug/l	ND	05/25/07	LBD	20.0			
n-Butylbenzene	ug/l	ND	05/25/07	LBD	1.0			
sec-Butylbenzene	ug/l	ND	05/25/07	LBD	1.0			
tert-Butylbenzene	ug/l	ND	05/25/07	LBD	1.0			
tert-Butylethyl Ether	ug/l	ND	05/25/07	LBD	0.5			
Carbon Disulfide	ug/l	ND	05/25/07	LBD	3.0			
Carbon Tetrachloride	ug/l	ND	05/25/07	LBD	1.0			
Chlorobenzene	ug/l	ND	05/25/07	LBD	1.0			
Chlorodibromomethane	ug/l	ND	05/25/07	LBD	0.5			
Chloroethane	ug/l	ND	05/25/07	LBD	2.0			
Chloroform	ug/l	ND	05/25/07	LBD	2.0			
Chloromethane	ug/l	ND	05/25/07	LBD	2.0			
2-Chlorotoluene	ug/l	ND	05/25/07	LBD	1.0			
4-Chlorotoluene	ug/l	ND	05/25/07	LBD	1.0			
1,2-Dibromo-3-Chloropropane	ug/l	ND	05/25/07	LBD	5.0			
1,2-Dibromoethane	ug/l	ND	05/25/07	LBD	0.50			
Dibromomethane	ug/l	ND	05/25/07	LBD	1.0			
1,2-Dichlorobenzene	ug/l	ND	05/25/07	LBD	1.0			
1,3-Dichlorobenzene	ug/l	ND	05/25/07	LBD	1.0			
1,4-Dichlorobenzene	ug/l	1.2	05/25/07	LBD	1.0			

RL = Reporting Limit

ND = Not Detected at or above the Reporting Limit

NM = Not Measured

SPEC LIMIT = a client specified recommended or regulatory level for comparison with data to determine PASS (P) or FAIL (F) condition of results.

\* = See end of report for comments and notes applying to this sample



39 Spruce Street ° East Longmeadow, MA 01028 ° FAX 413/525-6405 ° TEL. 413/525-2332

DONNA PALLISTER  
LFR, INC. - RI  
300 METRO CENTER BLVD., SUITE 250  
WARWICK, RI 02886

5/30/2007  
Page 11 of 24

Purchase Order No.: 5131

Project Location: SPRINGFIELD ST. SCHOOL  
Date Received: 5/22/2007  
Field Sample #: ATC-4

LIMS-BAT #: LIMIT-06424  
Job Number: 081-12152-03

Sample ID : 07B18766                      Sampled : 5/17/2007  
NOT SPECIFIED

Sample Matrix: GRND WATER

	Units	Results	Date Analyzed	Analyst	RL	SPEC Limit		P/F
						Lo	Hi	
trans-1,4-Dichloro-2-Butene	ug/l	ND	05/25/07	LBD	2.0			
Dichlorodifluoromethane	ug/l	ND	05/25/07	LBD	2.0			
1,1-Dichloroethane	ug/l	ND	05/25/07	LBD	1.0			
1,2-Dichloroethane	ug/l	ND	05/25/07	LBD	1.0			
1,1-Dichloroethylene	ug/l	ND	05/25/07	LBD	1.0			
cis-1,2-Dichloroethylene	ug/l	ND	05/25/07	LBD	1.0			
trans-1,2-Dichloroethylene	ug/l	ND	05/25/07	LBD	1.0			
1,2-Dichloropropane	ug/l	ND	05/25/07	LBD	1.0			
1,3-Dichloropropane	ug/l	ND	05/25/07	LBD	0.5			
2,2-Dichloropropane	ug/l	ND	05/25/07	LBD	1.0			
1,1-Dichloropropene	ug/l	ND	05/25/07	LBD	2.0			
cis-1,3-Dichloropropene	ug/l	ND	05/25/07	LBD	0.5			
trans-1,3-Dichloropropene	ug/l	ND	05/25/07	LBD	0.5			
Diethyl Ether	ug/l	ND	05/25/07	LBD	2.0			
Diisopropyl Ether	ug/l	ND	05/25/07	LBD	0.5			
1,4-Dioxane	ug/l	ND	05/25/07	LBD	50.0			
Ethyl Benzene	ug/l	ND	05/25/07	LBD	1.0			
Hexachlorobutadiene	ug/l	ND	05/25/07	LBD	1.0			
2-Hexanone	ug/l	ND	05/25/07	LBD	10.0			
Isopropylbenzene	ug/l	ND	05/25/07	LBD	1.0			
p-Isopropyltoluene	ug/l	ND	05/25/07	LBD	1.0			
MTBE	ug/l	ND	05/25/07	LBD	1.0			
Methylene Chloride	ug/l	ND	05/25/07	LBD	5.0			
MIBK	ug/l	ND	05/25/07	LBD	10.0			
Naphthalene	ug/l	ND	05/25/07	LBD	2.0			
n-Propylbenzene	ug/l	ND	05/25/07	LBD	1.0			
Styrene	ug/l	ND	05/25/07	LBD	1.0			
1,1,1,2-Tetrachloroethane	ug/l	ND	05/25/07	LBD	1.0			
1,1,2,2-Tetrachloroethane	ug/l	ND	05/25/07	LBD	0.5			
Tetrachloroethylene	ug/l	ND	05/25/07	LBD	1.0			

RL = Reporting Limit

ND = Not Detected at or above the Reporting Limit

NM = Not Measured

SPEC LIMIT = a client specified recommended or regulatory level for comparison with data to determine PASS (P) or FAIL (F) condition of results.

\* = See end of report for comments and notes applying to this sample



39 Spruce Street ° East Longmeadow, MA 01028 ° FAX 413/525-6405 ° TEL. 413/525-2332

DONNA PALLISTER  
LFR, INC. - RI  
300 METRO CENTER BLVD., SUITE 250  
WARWICK, RI 02886

Purchase Order No.: 5131

5/30/2007  
Page 12 of 24

Project Location: SPRINGFIELD ST. SCHOOL  
Date Received: 5/22/2007  
Field Sample #: ATC-4

LIMS-BAT #: LIMIT-06424  
Job Number: 081-12152-03

Sample ID: 07B18766  
Sampled: 5/17/2007  
NOT SPECIFIED

Sample Matrix: GRND WATER

	Units	Results	Date Analyzed	Analyst	RL	SPEC Limit Lo Hi	P/ F
Tetrahydrofuran	ug/l	ND	05/25/07	LBD	10.0		
Toluene	ug/l	ND	05/25/07	LBD	1.0		
1,2,3-Trichlorobenzene	ug/l	ND	05/25/07	LBD	5.0		
1,2,4-Trichlorobenzene	ug/l	ND	05/25/07	LBD	1.0		
1,1,1-Trichloroethane	ug/l	ND	05/25/07	LBD	1.0		
1,1,2-Trichloroethane	ug/l	ND	05/25/07	LBD	1.0		
Trichloroethylene	ug/l	ND	05/25/07	LBD	1.0		
Trichlorofluoromethane	ug/l	ND	05/25/07	LBD	2.0		
1,2,3-Trichloropropane	ug/l	ND	05/25/07	LBD	2.0		
1,1,2-Trichloro-1,2,2-Trifluoroethane	ug/l	ND	05/25/07	LBD	5.0		
1,2,4-Trimethylbenzene	ug/l	ND	05/25/07	LBD	1.0		
1,3,5-Trimethylbenzene	ug/l	ND	05/25/07	LBD	1.0		
Vinyl Chloride	ug/l	ND	05/25/07	LBD	2.0		
m + p Xylene	ug/l	ND	05/25/07	LBD	2.0		
o-Xylene	ug/l	ND	05/25/07	LBD	1.0		

Analytical Method:  
SW846 8260

SAMPLES ARE CONCENTRATED BY PURGE & TRAP, FOLLOWED BY GC/MS TARGET COMPOUND ANALYSIS. REPORTED RESULTS AND REPORTING LIMITS FOR 1,4-DIOXANE AND TERT-BUTYLALCOHOL ARE ESTIMATED SINCE RESPONSE FACTORS FOR THESE COMPOUNDS ARE BELOW METHOD SPECIFICATIONS.

RL = Reporting Limit

ND = Not Detected at or above the Reporting Limit

NM = Not Measured

SPEC LIMIT = a client specified recommended or regulatory level for comparison with data to determine PASS (P) or FAIL (F) condition of results.

\* = See end of report for comments and notes applying to this sample







39 Spruce Street ° East Longmeadow, MA 01028 ° FAX 413/525-6405 ° TEL. 413/525-2332

DONNA PALLISTER  
LFR, INC. - RI  
300 METRO CENTER BLVD., SUITE 250  
WARWICK, RI 02886

5/30/2007  
Page 14 of 24

Purchase Order No.: 5131

Project Location: SPRINGFIELD ST. SCHOOL  
Date Received: 5/22/2007

LIMS-BAT #: LIMIT-06424  
Job Number: 081-12152-03

Field Sample #: ATC-5

Sample ID: 07B18767

Sampled: 5/17/2007  
NOT SPECIFIED

Sample Matrix: GRND WATER

	Units	Results	Date Analyzed	Analyst	RL	SPEC Limit Lo Hi	P/ F
trans-1,4-Dichloro-2-Butene	ug/l	ND	05/24/07	LBD	2.0		
Dichlorodifluoromethane	ug/l	ND	05/24/07	LBD	2.0		
1,1-Dichloroethane	ug/l	ND	05/24/07	LBD	1.0		
1,2-Dichloroethane	ug/l	ND	05/24/07	LBD	1.0		
1,1-Dichloroethylene	ug/l	ND	05/24/07	LBD	1.0		
cis-1,2-Dichloroethylene	ug/l	ND	05/24/07	LBD	1.0		
trans-1,2-Dichloroethylene	ug/l	ND	05/24/07	LBD	1.0		
1,2-Dichloropropane	ug/l	ND	05/24/07	LBD	1.0		
1,3-Dichloropropane	ug/l	ND	05/24/07	LBD	0.5		
2,2-Dichloropropane	ug/l	ND	05/24/07	LBD	1.0		
1,1-Dichloropropene	ug/l	ND	05/24/07	LBD	2.0		
cis-1,3-Dichloropropene	ug/l	ND	05/24/07	LBD	0.5		
trans-1,3-Dichloropropene	ug/l	ND	05/24/07	LBD	0.5		
Diethyl Ether	ug/l	ND	05/24/07	LBD	2.0		
Diisopropyl Ether	ug/l	ND	05/24/07	LBD	0.5		
1,4-Dioxane	ug/l	ND	05/24/07	LBD	50.0		
Ethyl Benzene	ug/l	ND	05/24/07	LBD	1.0		
Hexachlorobutadiene	ug/l	ND	05/24/07	LBD	1.0		
2-Hexanone	ug/l	ND	05/24/07	LBD	10.0		
Isopropylbenzene	ug/l	ND	05/24/07	LBD	1.0		
p-Isopropyltoluene	ug/l	ND	05/24/07	LBD	1.0		
MTBE	ug/l	ND	05/24/07	LBD	1.0		
Methylene Chloride	ug/l	ND	05/24/07	LBD	5.0		
MIBK	ug/l	ND	05/24/07	LBD	10.0		
Naphthalene	ug/l	ND	05/24/07	LBD	2.0		
n-Propylbenzene	ug/l	ND	05/24/07	LBD	1.0		
Styrene	ug/l	ND	05/24/07	LBD	1.0		
1,1,1,2-Tetrachloroethane	ug/l	ND	05/24/07	LBD	1.0		
1,1,2,2-Tetrachloroethane	ug/l	ND	05/24/07	LBD	0.5		
Tetrachloroethylene	ug/l	ND	05/24/07	LBD	1.0		

RL = Reporting Limit

ND = Not Detected at or above the Reporting Limit

NM = Not Measured

\* = See end of report for comments and notes applying to this sample

SPEC LIMIT = a client specified recommended or regulatory level for comparison with data to determine PASS (P) or FAIL (F) condition of results.



39 Spruce Street ° East Longmeadow, MA 01028 ° FAX 413/525-6405 ° TEL. 413/525-2332

DONNA PALLISTER  
LFR, INC. - RI  
300 METRO CENTER BLVD., SUITE 250  
WARWICK, RI 02886

Purchase Order No.: 5131

5/30/2007  
Page 15 of 24

Project Location: ~-SPRINGFIELD ST. SCHOOL  
Date Received: 5/22/2007  
Field Sample #: ATC-5

LIMS-BAT #: LIMIT-06424  
Job Number: 081-12152-03

Sample ID: 07B18767      Sampled: 5/17/2007  
NOT SPECIFIED

Sample Matrix: GRND WATER

	Units	Results	Date Analyzed	Analyst	RL	SPEC Limit		P/ F
						Lo	Hi	
Tetrahydrofuran	ug/l	ND	05/24/07	LBD	10.0			
Toluene	ug/l	ND	05/24/07	LBD	1.0			
1,2,3-Trichlorobenzene	ug/l	ND	05/24/07	LBD	5.0			
1,2,4-Trichlorobenzene	ug/l	ND	05/24/07	LBD	1.0			
1,1,1-Trichloroethane	ug/l	ND	05/24/07	LBD	1.0			
1,1,2-Trichloroethane	ug/l	ND	05/24/07	LBD	1.0			
Trichloroethylene	ug/l	ND	05/24/07	LBD	1.0			
Trichlorofluoromethane	ug/l	ND	05/24/07	LBD	2.0			
1,2,3-Trichloropropane	ug/l	ND	05/24/07	LBD	2.0			
1,1,2-Trichloro-1,2,2-Trifluoroethane	ug/l	ND	05/24/07	LBD	5.0			
1,2,4-Trimethylbenzene	ug/l	ND	05/24/07	LBD	1.0			
1,3,5-Trimethylbenzene	ug/l	ND	05/24/07	LBD	1.0			
Vinyl Chloride	ug/l	ND	05/24/07	LBD	2.0			
m + p Xylene	ug/l	ND	05/24/07	LBD	2.0			
o-Xylene	ug/l	ND	05/24/07	LBD	1.0			

Analytical Method:  
SW846 8260

SAMPLES ARE CONCENTRATED BY PURGE & TRAP, FOLLOWED BY GC/MS TARGET COMPOUND ANALYSIS. REPORTED RESULTS AND REPORTING LIMITS FOR 1,4-DIOXANE AND TERT-BUTYLALCOHOL ARE ESTIMATED SINCE RESPONSE FACTORS FOR THESE COMPOUNDS ARE BELOW METHOD SPECIFICATIONS.

RL = Reporting Limit

ND = Not Detected at or above the Reporting Limit

NM = Not Measured

\* = See end of report for comments and notes applying to this sample

SPEC LIMIT = a client specified recommended or regulatory level for comparison with data to determine PASS (P) or FAIL (F) condition of results.



39 Spruce Street ° East Longmeadow, MA 01028 ° FAX 413/525-6405 ° TEL. 413/525-2332

DONNA PALLISTER  
 LFR, INC. - RI  
 300 METRO CENTER BLVD., SUITE 250  
 WARWICK, RI 02886

Purchase Order No.: 5131

5/30/2007  
 Page 16 of 24

Project Location: SPRINGFIELD ST. SCHOOL  
 Date Received: 5/22/2007  
 Field Sample #: MPL-6

LIMS-BAT #: LIMIT-06424  
 Job Number: 081-12152-03

Sample ID : 07B18769                      Sampled : 5/17/2007  
 NOT SPECIFIED

Sample Matrix: AIR

	Units	Results	Date Analyzed	Analyst	RL	SPEC Limit		P/ F
						Lo	Hi	
Benzene	PPBv	0.36	05/24/07	TPH	0.10			
Bromomethane	PPBv	ND	05/24/07	TPH	0.10			
Carbon Tetrachloride	PPBv	ND	05/24/07	TPH	0.10			
Chlorobenzene	PPBv	ND	05/24/07	TPH	0.10			
Chloroethane	PPBv	ND	05/24/07	TPH	0.10			
Chloroform	PPBv	3.2	05/24/07	TPH	0.10			
Chloromethane	PPBv	0.24	05/24/07	TPH	0.10			
1,2-Dibromoethane	PPBv	ND	05/24/07	TPH	0.10			
1,2-Dichlorobenzene	PPBv	ND	05/24/07	TPH	0.10			
1,3-Dichlorobenzene	PPBv	ND	05/24/07	TPH	0.10			
1,4-Dichlorobenzene	PPBv	ND	05/24/07	TPH	0.10			
Dichlorodifluoromethane	PPBv	ND	05/24/07	TPH	0.10			
1,1-Dichloroethane	PPBv	ND	05/24/07	TPH	0.10			
1,2-Dichloroethane	PPBv	ND	05/24/07	TPH	0.10			
1,1-Dichloroethylene	PPBv	ND	05/24/07	TPH	0.10			
cis-1,2-Dichloroethylene	PPBv	ND	05/24/07	TPH	0.10			
1,2-Dichloropropane	PPBv	ND	05/24/07	TPH	0.10			
cis-1,3-Dichloropropene	PPBv	ND	05/24/07	TPH	0.10			
trans-1,3-Dichloropropene	PPBv	ND	05/24/07	TPH	0.10			
1,2-Dichlorotetrafluoroethane (114)	PPBv	ND	05/24/07	TPH	0.10			
Ethylbenzene	PPBv	0.75	05/24/07	TPH	0.10			
Hexachlorobutadiene	PPBv	ND	05/24/07	TPH	0.10			
Methylene Chloride	PPBv	ND	05/24/07	TPH	0.10			
Styrene	PPBv	1.6	05/24/07	TPH	0.10			
1,1,2,2-Tetrachloroethane	PPBv	ND	05/24/07	TPH	0.10			
Tetrachloroethylene	PPBv	0.19	05/24/07	TPH	0.10			
Toluene	PPBv	17	05/24/07	TPH	0.10			
1,2,4-Trichlorobenzene	PPBv	ND	05/24/07	TPH	0.20			
1,1,1-Trichloroethane	PPBv	ND	05/24/07	TPH	0.10			
1,1,2-Trichloroethane	PPBv	ND	05/24/07	TPH	0.10			

RL = Reporting Limit

ND = Not Detected at or above the Reporting Limit

NM = Not Measured

SPEC LIMIT = a client specified recommended or regulatory level for comparison with data to determine PASS (P) or FAIL (F) condition of results.

\* = See end of report for comments and notes applying to this sample



39 Spruce Street ° East Longmeadow, MA 01028 ° FAX 413/525-6405 ° TEL. 413/525-2332

DONNA PALLISTER  
LFR, INC. - RI  
300 METRO CENTER BLVD., SUITE 250  
WARWICK, RI 02886

5/30/2007  
Page 17 of 24

Purchase Order No.: 5131

Project Location: SPRINGFIELD ST. SCHOOL  
Date Received: 5/22/2007  
Field Sample #: MPL-6

LIMS-BAT #: LIMT-06424  
Job Number: 081-12152-03

Sample ID : 07B18769                      Sampled : 5/17/2007  
NOT SPECIFIED

Sample Matrix: AIR

	Units	Results	Date Analyzed	Analyst	RL	SPEC Limit Lo      Hi	P/ F
Trichloroethylene	PPBv	ND	05/24/07	TPH	0.10		
Trichlorofluoromethane (Freon 11)	PPBv	ND	05/24/07	TPH	0.10		
1,1,2-Trichloro-1,2,2-Trifluoroethane	PPBv	ND	05/24/07	TPH	0.10		
1,2,4-Trimethylbenzene	PPBv	ND	05/24/07	TPH	0.10		
1,3,5-Trimethylbenzene	PPBv	0.12	05/24/07	TPH	0.10		
Vinyl Chloride	PPBv	ND	05/24/07	TPH	0.10		
m/p-Xylene	PPBv	3.1	05/24/07	TPH	0.20		
o-Xylene	PPBv	0.61	05/24/07	TPH	0.10		

Analytical Method:

EPA TO-14A

SAMPLES ARE TAKEN IN SUMMA CANISTERS AND ANALYZED BY GAS CHROMATOGRAPHY WITH MASS SPECTROMETRY DETECTION. (GC/MS)

RL = Reporting Limit

ND = Not Detected at or above the Reporting Limit

NM = Not Measured

\* = See end of report for comments and notes applying to this sample

SPEC LIMIT = a client specified recommended or regulatory level for comparison with data to determine PASS (P) or FAIL (F) condition of results.



39 Spruce Street ° East Longmeadow, MA 01028 ° FAX 413/525-6405 ° TEL. 413/525-2332

DONNA PALLISTER  
LFR, INC. - RI  
300 METRO CENTER BLVD., SUITE 250  
WARWICK, RI 02886

5/30/2007  
Page 18 of 24

Project Location: SPRINGFIELD ST. SCHOOL.  
Date Received: 5/22/2007  
Field Sample #: WB-2

LIMS-BAT #: LIMIT-06424  
Job Number: 081-12152-03

Sample ID : 07B18768                      Sampled : 5/17/2007  
NOT SPECIFIED

Sample Matrix: AIR

	Units	Results	Date Analyzed	Analyst	RL	SPEC Limit		P/ F
						Lo	Hi	
Benzene	PPBv	0.29	05/24/07	TPH	0.10			
Bromomethane	PPBv	ND	05/24/07	TPH	0.10			
Carbon Tetrachloride	PPBv	ND	05/24/07	TPH	0.10			
Chlorobenzene	PPBv	ND	05/24/07	TPH	0.10			
Chloroethane	PPBv	ND	05/24/07	TPH	0.10			
Chloroform	PPBv	ND	05/24/07	TPH	0.10			
Chloromethane	PPBv	0.11	05/24/07	TPH	0.10			
1,2-Dibromoethane	PPBv	ND	05/24/07	TPH	0.10			
1,2-Dichlorobenzene	PPBv	ND	05/24/07	TPH	0.10			
1,3-Dichlorobenzene	PPBv	ND	05/24/07	TPH	0.10			
1,4-Dichlorobenzene	PPBv	0.16	05/24/07	TPH	0.10			
Dichlorodifluoromethane	PPBv	0.50	05/24/07	TPH	0.10			
1,1-Dichloroethane	PPBv	ND	05/24/07	TPH	0.10			
1,2-Dichloroethane	PPBv	ND	05/24/07	TPH	0.10			
1,1-Dichloroethylene	PPBv	ND	05/24/07	TPH	0.10			
cis-1,2-Dichloroethylene	PPBv	ND	05/24/07	TPH	0.10			
1,2-Dichloropropane	PPBv	ND	05/24/07	TPH	0.10			
cis-1,3-Dichloropropene	PPBv	ND	05/24/07	TPH	0.10			
trans-1,3-Dichloropropene	PPBv	ND	05/24/07	TPH	0.10			
1,2-Dichlorotetrafluoroethane (114)	PPBv	ND	05/24/07	TPH	0.10			
Ethylbenzene	PPBv	0.55	05/24/07	TPH	0.10			
Hexachlorobutadiene	PPBv	ND	05/24/07	TPH	0.10			
Methylene Chloride	PPBv	0.53	05/24/07	TPH	0.10			
Styrene	PPBv	1.0	05/24/07	TPH	0.10			
1,1,2,2-Tetrachloroethane	PPBv	ND	05/24/07	TPH	0.10			
Tetrachloroethylene	PPBv	0.16	05/24/07	TPH	0.10			
Toluene	PPBv	12	05/24/07	TPH	0.10			
1,2,4-Trichlorobenzene	PPBv	ND	05/24/07	TPH	0.20			
1,1,1-Trichloroethane	PPBv	ND	05/24/07	TPH	0.10			
1,1,2-Trichloroethane	PPBv	ND	05/24/07	TPH	0.10			

RL = Reporting Limit

ND = Not Detected at or above the Reporting Limit

NM = Not Measured

SPEC LIMIT = a client specified recommended or regulatory level for comparison with data to determine PASS (P) or FAIL (F) condition of results.

\* = See end of report for comments and notes applying to this sample



39 Spruce Street ° East Longmeadow, MA 01028 ° FAX 413/525-6405 ° TEL. 413/525-2332

DONNA PALLISTER

LFR, INC. - RI

300 METRO CENTER BLVD., SUITE 250

WARWICK, RI 02886

Purchase Order No.: 5131

5/30/2007

Page 19 of 24

Project Location: SPRINGFIELD ST. SCHOOL

LIMS-BAT #: LIMT-06424

Date Received: 5/22/2007

Job Number: 081-12152-03

Field Sample #: WB-2

Sample ID: 07B18768

Sampled: 5/17/2007

NOT SPECIFIED

Sample Matrix: AIR

	Units	Results	Date Analyzed	Analyst	RL	SPEC Limit Lo Hi	P/ F
Trichloroethylene	PPBv	ND	05/24/07	TPH	0.10		
Trichlorofluoromethane (Freon 11)	PPBv	0.41	05/24/07	TPH	0.10		
1,1,2-Trichloro-1,2,2-Trifluoroethane	PPBv	ND	05/24/07	TPH	0.10		
1,2,4-Trimethylbenzene	PPBv	1.0	05/24/07	TPH	0.10		
1,3,5-Trimethylbenzene	PPBv	ND	05/24/07	TPH	0.10		
Vinyl Chloride	PPBv	ND	05/24/07	TPH	0.10		
m/p-Xylene	PPBv	2.5	05/24/07	TPH	0.20		
o-Xylene	PPBv	0.56	05/24/07	TPH	0.10		

Analytical Method:

EPA TO-14A

SAMPLES ARE TAKEN IN SUMMA CANISTERS AND ANALYZED BY GAS CHROMATOGRAPHY WITH MASS SPECTROMETRY DETECTION. (GC/MS)

RL = Reporting Limit

ND = Not Detected at or above the Reporting Limit

NM = Not Measured

SPEC LIMIT = a client specified recommended or regulatory level for comparison with data to determine PASS (P) or FAIL (F) condition of results.

\* = See end of report for comments and notes applying to this sample



39 Spruce Street ° East Longmeadow, MA 01028 ° FAX 413/525-6405 ° TEL. 413/525-2332

DONNA PALLISTER  
LFR, INC. - RI  
300 METRO CENTER BLVD., SUITE 250  
WARWICK, RI 02886

5/30/2007  
Page 20 of 24

Purchase Order No.: 5131

Project Location: SPRINGFIELD ST. SCHOOL  
Date Received: 5/22/2007  
Field Sample #: MPL-6

LIMS-BAT #: LIMIT-06424  
Job Number: 081-12152-03

Sample ID: 07B18769  
Sampled: 5/17/2007  
NOT SPECIFIED

Sample Matrix: AIR

	Units	Results	Date Analyzed	Analyst	RL	SPEC Limit		P/ F
						Lo	Hi	
Benzene	ug/m3	1.1	05/24/07	TPH	0.32			
Bromomethane	ug/m3	ND	05/24/07	TPH	0.38			
Carbon Tetrachloride	ug/m3	ND	05/24/07	TPH	0.62			
Chlorobenzene	ug/m3	ND	05/24/07	TPH	0.46			
Chloroethane	ug/m3	ND	05/24/07	TPH	0.26			
Chloroform	ug/m3	16	05/24/07	TPH	0.48			
Chloromethane	ug/m3	0.50	05/24/07	TPH	0.20			
1,2-Dibromoethane	ug/m3	ND	05/24/07	TPH	0.76			
1,2-Dichlorobenzene	ug/m3	ND	05/24/07	TPH	0.60			
1,3-Dichlorobenzene	ug/m3	ND	05/24/07	TPH	0.60			
1,4-Dichlorobenzene	ug/m3	ND	05/24/07	TPH	0.60			
Dichlorodifluoromethane	ug/m3	ND	05/24/07	TPH	0.49			
1,1-Dichloroethane	ug/m3	ND	05/24/07	TPH	0.40			
1,2-Dichloroethane	ug/m3	ND	05/24/07	TPH	0.40			
1,1-Dichloroethylene	ug/m3	ND	05/24/07	TPH	0.39			
cis-1,2-Dichloroethylene	ug/m3	ND	05/24/07	TPH	0.39			
1,2-Dichloropropane	ug/m3	ND	05/24/07	TPH	0.46			
cis-1,3-Dichloropropene	ug/m3	ND	05/24/07	TPH	0.45			
trans-1,3-Dichloropropene	ug/m3	ND	05/24/07	TPH	0.45			
1,2-Dichlorotetrafluoroethane (114)	ug/m3	ND	05/24/07	TPH	0.70			
Ethylbenzene	ug/m3	3.3	05/24/07	TPH	0.43			
Hexachlorobutadiene	ug/m3	ND	05/24/07	TPH	1.1			
Methylene Chloride	ug/m3	ND	05/24/07	TPH	0.34			
Styrene	ug/m3	6.6	05/24/07	TPH	0.43			
1,1,2,2-Tetrachloroethane	ug/m3	ND	05/24/07	TPH	0.68			
Tetrachloroethylene	ug/m3	1.3	05/24/07	TPH	0.67			
Toluene	ug/m3	63	05/24/07	TPH	0.38			
1,2,4-Trichlorobenzene	ug/m3	ND	05/24/07	TPH	1.5			
1,1,1-Trichloroethane	ug/m3	ND	05/24/07	TPH	0.54			
1,1,2-Trichloroethane	ug/m3	ND	05/24/07	TPH	0.54			

RL = Reporting Limit

ND = Not Detected at or above the Reporting Limit

NM = Not Measured

\* = See end of report for comments and notes applying to this sample

SPEC LIMIT = a client specified recommended or regulatory level for comparison with data to determine PASS (P) or FAIL (F) condition of results.



39 Spruce Street ° East Longmeadow, MA 01028 ° FAX 413/525-6405 ° TEL. 413/525-2332

DONNA PALLISTER

LFR, INC. - RI

300 METRO CENTER BLVD., SUITE 250

WARWICK, RI 02886

Purchase Order No.: 5131

5/30/2007

Page 21 of 24

Project Location: SPRINGFIELD ST. SCHOOL

Date Received: 5/22/2007

Field Sample # : MPL-6

LIMS-BAT #: LIMT-06424

Job Number: 081-12152-03

Sample ID : 07B18769

Sampled : 5/17/2007

NOT SPECIFIED

Sample Matrix: AIR

	Units	Results	Date Analyzed	Analyst	RL	SPEC Limit Lo Hi	P/ F
Trichloroethylene	ug/m3	ND	05/24/07	TPH	0.53		
Trichlorofluoromethane	ug/m3	ND	05/24/07	TPH	0.56		
1,1,2-Trichloro-1,2,2-Trifluoroethane	ug/m3	ND	05/24/07	TPH	0.76		
1,2,4-Trimethylbenzene	ug/m3	ND	05/24/07	TPH	0.49		
1,3,5-Trimethylbenzene	ug/m3	0.59	05/24/07	TPH	0.49		
Vinyl Chloride	ug/m3	ND	05/24/07	TPH	0.25		
m/p-Xylene	ug/m3	13	05/24/07	TPH	0.87		
o-Xylene	ug/m3	2.6	05/24/07	TPH	0.43		

Analytical Method:

EPA TO-14A

SAMPLES ARE TAKEN IN SUMMA CANISTERS AND ANALYZED BY GAS CHROMATOGRAPHY WITH MASS SPECTROMETRY DETECTION. (GC/MS)

RL = Reporting Limit

ND = Not Detected at or above the Reporting Limit

NM = Not Measured

\* = See end of report for comments and notes applying to this sample

SPEC LIMIT = a client specified recommended or regulatory level for comparison with data to determine PASS (P) or FAIL (F) condition of results.





39 Spruce Street ° East Longmeadow, MA 01028 ° FAX 413/525-6405 ° TEL. 413/525-2332

DONNA PALLISTER  
LFR, INC. - RI  
300 METRO CENTER BLVD., SUITE 250  
WARWICK, RI 02886

5/30/2007  
Page 22 of 24

Project Location: SPRINGFIELD ST. SCHOOL  
Date Received: 5/22/2007  
Field Sample #: WB-2

Purchase Order No.: 5131

LIMS-BAT #: LIMIT-06424  
Job Number: 081-12152-03

Sample ID: 07B18768      Sampled: 5/17/2007  
NOT SPECIFIED

Sample Matrix: AIR

	Units	Results	Date Analyzed	Analyst	RL	SPEC Limit		P/ F
						Lo	Hi	
Benzene	ug/m3	0.93	05/24/07	TPH	0.32			
Bromomethane	ug/m3	ND	05/24/07	TPH	0.38			
Carbon Tetrachloride	ug/m3	ND	05/24/07	TPH	0.62			
Chlorobenzene	ug/m3	ND	05/24/07	TPH	0.46			
Chloroethane	ug/m3	ND	05/24/07	TPH	0.26			
Chloroform	ug/m3	ND	05/24/07	TPH	0.48			
Chloromethane	ug/m3	0.23	05/24/07	TPH	0.20			
1,2-Dibromoethane	ug/m3	ND	05/24/07	TPH	0.76			
1,2-Dichlorobenzene	ug/m3	ND	05/24/07	TPH	0.60			
1,3-Dichlorobenzene	ug/m3	ND	05/24/07	TPH	0.60			
1,4-Dichlorobenzene	ug/m3	0.96	05/24/07	TPH	0.60			
Dichlorodifluoromethane	ug/m3	2.5	05/24/07	TPH	0.49			
1,1-Dichloroethane	ug/m3	ND	05/24/07	TPH	0.40			
1,2-Dichloroethane	ug/m3	ND	05/24/07	TPH	0.40			
1,1-Dichloroethylene	ug/m3	ND	05/24/07	TPH	0.39			
cis-1,2-Dichloroethylene	ug/m3	ND	05/24/07	TPH	0.39			
1,2-Dichloropropane	ug/m3	ND	05/24/07	TPH	0.46			
cis-1,3-Dichloropropene	ug/m3	ND	05/24/07	TPH	0.45			
trans-1,3-Dichloropropene	ug/m3	ND	05/24/07	TPH	0.45			
1,2-Dichlorotetrafluoroethane (114)	ug/m3	ND	05/24/07	TPH	0.70			
Ethylbenzene	ug/m3	2.4	05/24/07	TPH	0.43			
Hexachlorobutadiene	ug/m3	ND	05/24/07	TPH	1.1			
Methylene Chloride	ug/m3	1.8	05/24/07	TPH	0.34			
Styrene	ug/m3	4.5	05/24/07	TPH	0.43			
1,1,2,2-Tetrachloroethane	ug/m3	ND	05/24/07	TPH	0.68			
Tetrachloroethylene	ug/m3	1.1	05/24/07	TPH	0.67			
Toluene	ug/m3	44	05/24/07	TPH	0.38			
1,2,4-Trichlorobenzene	ug/m3	ND	05/24/07	TPH	1.5			
1,1,1-Trichloroethane	ug/m3	ND	05/24/07	TPH	0.54			
1,1,2-Trichloroethane	ug/m3	ND	05/24/07	TPH	0.54			

RL = Reporting Limit

ND = Not Detected at or above the Reporting Limit

NM = Not Measured

\* = See end of report for comments and notes applying to this sample

SPEC LIMIT = a client specified recommended or regulatory level for comparison with data to determine PASS (P) or FAIL (F) condition of results.



39 Spruce Street ° East Longmeadow, MA 01028 ° FAX 413/525-6405 ° TEL. 413/525-2332

DONNA PALLISTER  
LFR, INC. - RI  
300 METRO CENTER BLVD., SUITE 250  
WARWICK, RI 02886

Purchase Order No.: 5131

5/30/2007  
Page 23 of 24

Project Location: SPRINGFIELD ST. SCHOOL  
Date Received: 5/22/2007  
Field Sample #: WB-2

LIMS-BAT #: LIMIT-06424  
Job Number: 081-12152-03

Sample ID : 07B18768                      Sampled : 5/17/2007  
NOT SPECIFIED

Sample Matrix: AIR

	Units	Results	Date Analyzed	Analyst	RL	SPEC Limit Lo      Hi	P/ F
Trichloroethylene	ug/m3	ND	05/24/07	TPH	0.53		
Trichlorofluoromethane	ug/m3	2.3	05/24/07	TPH	0.56		
1,1,2-Trichloro-1,2,2-Trifluoroethane	ug/m3	ND	05/24/07	TPH	0.76		
1,2,4-Trimethylbenzene	ug/m3	5.1	05/24/07	TPH	0.49		
1,3,5-Trimethylbenzene	ug/m3	ND	05/24/07	TPH	0.49		
Vinyl Chloride	ug/m3	ND	05/24/07	TPH	0.25		
m/p-Xylene	ug/m3	11	05/24/07	TPH	0.87		
o-Xylene	ug/m3	2.4	05/24/07	TPH	0.43		

Analytical Method:  
EPA TO-14A

SAMPLES ARE TAKEN IN SUMMA CANISTERS AND ANALYZED BY GAS CHROMATOGRAPHY WITH MASS SPECTROMETRY DETECTION. (GC/MS)

RL = Reporting Limit

ND = Not Detected at or above the Reporting Limit

NM = Not Measured

\* = See end of report for comments and notes applying to this sample

SPEC LIMIT = a client specified recommended or regulatory level for comparison with data to determine PASS (P) or FAIL (F) condition of results.



39 Spruce Street ° East Longmeadow, MA 01028 ° FAX 413/525-6405 ° TEL. 413/525-2332

DONNA PALLISTER  
LFR, INC. - RI  
300 METRO CENTER BLVD., SUITE 250  
WARWICK, RI 02886

Purchase Order No.: 5131

Project Location: SPRINGFIELD ST. SCHOOL  
Date Received: 5/22/2007

5/30/2007  
Page 24 of 24

LIMS-BAT #: LIMT-06424  
Job Number: 081-12152-03

\*\* END OF REPORT \*\*

RL = Reporting Limit

ND = Not Detected at or above the Reporting Limit

NM = Not Measured

SPEC LIMIT = a client specified recommended or regulatory level for comparison with data to determine PASS (P) or FAIL (F) condition of results.

\* = See end of report for comments and notes applying to this sample



39 Spruce Street ° East Longmeadow, MA 01028 ° FAX 413/525-6405 ° TEL. 413/525-2332

**QC SUMMARY REPORT**

SAMPLE QC: Sample Results with Duplicates

BATCH QC: Lab fortified Blanks and Duplicates

Sample Matrix Spikes and Matrix Spike Duplicates

Standard Reference Materials and Duplicates

Method Blanks

Report Date: 5/30/2007

Lims Bat #: LIMT-06424

Page 1 of 11

QC Batch Number: BATCH-12470

Sample Id	Analysis	QC Analysis	Values	Units	Limits
07B18768	4-Bromofluorobenzene	Surrogate Recovery	94.75	%	70-130
07B18769	4-Bromofluorobenzene	Surrogate Recovery	85.75	%	70-130
BLANK-102242	Benzene	Blank	<0.32	ug/m3	
	Carbon Tetrachloride	Blank	<0.62	ug/m3	
	Chloroform	Blank	<0.48	ug/m3	
	1,2-Dichloroethane	Blank	<0.40	ug/m3	
	1,4-Dichlorobenzene	Blank	<0.60	ug/m3	
	Ethylbenzene	Blank	<0.43	ug/m3	
	Styrene	Blank	<0.43	ug/m3	
	Tetrachloroethylene	Blank	<0.67	ug/m3	
	Toluene	Blank	<0.38	ug/m3	
	1,1,1-Trichloroethane	Blank	<0.54	ug/m3	
	Trichloroethylene	Blank	<0.53	ug/m3	
	1,1,2-Trichloro-1,2,2-Trifluoroethane	Blank	<0.76	ug/m3	
	Trichlorofluoromethane	Blank	<0.56	ug/m3	
	o-Xylene	Blank	<0.43	ug/m3	
	m/p-Xylene	Blank	<0.87	ug/m3	
	1,2-Dichlorobenzene	Blank	<0.60	ug/m3	
	1,3-Dichlorobenzene	Blank	<0.60	ug/m3	
	1,1-Dichloroethane	Blank	<0.40	ug/m3	
	1,1-Dichloroethylene	Blank	<0.39	ug/m3	
	Vinyl Chloride	Blank	<0.25	ug/m3	
	Methylene Chloride	Blank	<0.34	ug/m3	
	Chlorobenzene	Blank	<0.46	ug/m3	
	Chloromethane	Blank	<0.20	ug/m3	
	Bromomethane	Blank	<0.38	ug/m3	
	Chloroethane	Blank	<0.26	ug/m3	
	cis-1,3-Dichloropropene	Blank	<0.45	ug/m3	
	trans-1,3-Dichloropropene	Blank	<0.45	ug/m3	
	1,1,2-Trichloroethane	Blank	<0.54	ug/m3	
	1,1,2,2-Tetrachloroethane	Blank	<0.68	ug/m3	
	Hexachlorobutadiene	Blank	<1.1	ug/m3	
	1,2,4-Trichlorobenzene	Blank	<1.5	ug/m3	
	1,2,4-Trimethylbenzene	Blank	<0.49	ug/m3	
	1,3,5-Trimethylbenzene	Blank	<0.49	ug/m3	
	cis-1,2-Dichloroethylene	Blank	<0.39	ug/m3	
	1,2-Dichloropropane	Blank	<0.46	ug/m3	
	Dichlorodifluoromethane	Blank	<0.49	ug/m3	
	1,2-Dibromoethane	Blank	<0.76	ug/m3	
	1,2-Dichlorotetrafluoroethane (114)	Blank	<0.70	ug/m3	



39 Spruce Street ° East Longmeadow, MA 01028 ° FAX 413/525-6405 ° TEL. 413/525-2332

**QC SUMMARY REPORT**

SAMPLE QC: Sample Results with Duplicates

BATCH QC: Lab fortified Blanks and Duplicates

Sample Matrix Spikes and Matrix Spike Duplicates

Standard Reference Materials and Duplicates

Method Blanks

Report Date: 5/30/2007

Lims Bat #: LIMIT-06424

Page 2 of 11

QC Batch Number: GCMS/VOL-16942

Sample Id	Analysis	QC Analysis	Values	Units	Limits
07B18763	1,2-Dichloroethane-d4	Surrogate Recovery	102.1	%	70-130
	Toluene-d8	Surrogate Recovery	100.0	%	70-130
	Bromofluorobenzene	Surrogate Recovery	100.5	%	70-130
07B18764	1,2-Dichloroethane-d4	Surrogate Recovery	101.7	%	70-130
	Toluene-d8	Surrogate Recovery	100.6	%	70-130
	Bromofluorobenzene	Surrogate Recovery	99.5	%	70-130
07B18765	1,2-Dichloroethane-d4	Surrogate Recovery	101.9	%	70-130
	Toluene-d8	Surrogate Recovery	100.1	%	70-130
	Bromofluorobenzene	Surrogate Recovery	100.6	%	70-130
07B18766	1,2-Dichloroethane-d4	Surrogate Recovery	110.3	%	70-130
	Toluene-d8	Surrogate Recovery	98.6	%	70-130
	Bromofluorobenzene	Surrogate Recovery	96.4	%	70-130
07B18767	1,2-Dichloroethane-d4	Surrogate Recovery	103.1	%	70-130
	Toluene-d8	Surrogate Recovery	100.4	%	70-130
	Bromofluorobenzene	Surrogate Recovery	99.5	%	70-130
BLANK-102333	Acetone	Blank	<50.0	ug/l	
	Benzene	Blank	<1.0	ug/l	
	Carbon Tetrachloride	Blank	<1.0	ug/l	
	Chloroform	Blank	<2.0	ug/l	
	1,2-Dichloroethane	Blank	<1.0	ug/l	
	1,4-Dichlorobenzene	Blank	<1.0	ug/l	
	Ethyl Benzene	Blank	<1.0	ug/l	
	2-Butanone (MEK)	Blank	<20.0	ug/l	
	MIBK	Blank	<10.0	ug/l	
	Naphthalene	Blank	<2.0	ug/l	
	Styrene	Blank	<1.0	ug/l	
	Tetrachloroethylene	Blank	<1.0	ug/l	
	Toluene	Blank	<1.0	ug/l	
	1,1,1-Trichloroethane	Blank	<1.0	ug/l	
	Trichloroethylene	Blank	<1.0	ug/l	
	1,1,2-Trichloro-1,2,2-Trifluoroethane	Blank	<5.0	ug/l	
	Trichlorofluoromethane	Blank	<2.0	ug/l	
	o-Xylene	Blank	<1.0	ug/l	
	m + p Xylene	Blank	<2.0	ug/l	
	1,2-Dichlorobenzene	Blank	<1.0	ug/l	
1,3-Dichlorobenzene	Blank	<1.0	ug/l		
1,1-Dichloroethane	Blank	<1.0	ug/l		
1,1-Dichloroethylene	Blank	<1.0	ug/l		



39 Spruce Street ° East Longmeadow, MA 01028 ° FAX 413/525-6405 ° TEL. 413/525-2332

**QC SUMMARY REPORT**

SAMPLE QC: Sample Results with Duplicates

BATCH QC: Lab fortified Blanks and Duplicates

Sample Matrix Spikes and Matrix Spike Duplicates

Standard Reference Materials and Duplicates

Method Blanks

Report Date: 5/30/2007

Lims Bat #: LIMT-06424

Page 3 of 11

QC Batch Number: GCMS/VOL-16942

Sample Id	Analysis	QC Analysis	Values	Units	Limits
BLANK-102333	1,4-Dioxane	Blank	<50.0	ug/l	
	MTBE	Blank	<1.0	ug/l	
	trans-1,2-Dichloroethylene	Blank	<1.0	ug/l	
	Vinyl Chloride	Blank	<2.0	ug/l	
	Methylene Chloride	Blank	<5.0	ug/l	
	Chlorobenzene	Blank	<1.0	ug/l	
	Chloromethane	Blank	<2.0	ug/l	
	Bromomethane	Blank	<10.0	ug/l	
	Chloroethane	Blank	<2.0	ug/l	
	cis-1,3-Dichloropropene	Blank	<0.5	ug/l	
	trans-1,3-Dichloropropene	Blank	<0.5	ug/l	
	Chlorodibromomethane	Blank	<0.5	ug/l	
	1,1,2-Trichloroethane	Blank	<1.0	ug/l	
	Bromoform	Blank	<1.0	ug/l	
	1,1,2,2-Tetrachloroethane	Blank	<0.5	ug/l	
	2-Chlorotoluene	Blank	<1.0	ug/l	
	Hexachlorobutadiene	Blank	<1.0	ug/l	
	Isopropylbenzene	Blank	<1.0	ug/l	
	p-Isopropyltoluene	Blank	<1.0	ug/l	
	n-Propylbenzene	Blank	<1.0	ug/l	
	sec-Butylbenzene	Blank	<1.0	ug/l	
	tert-Butylbenzene	Blank	<1.0	ug/l	
	1,2,3-Trichlorobenzene	Blank	<5.0	ug/l	
	1,2,4-Trichlorobenzene	Blank	<1.0	ug/l	
	1,2,4-Trimethylbenzene	Blank	<1.0	ug/l	
	1,3,5-Trimethylbenzene	Blank	<1.0	ug/l	
	Dibromomethane	Blank	<1.0	ug/l	
	cis-1,2-Dichloroethylene	Blank	<1.0	ug/l	
	4-Chlorotoluene	Blank	<1.0	ug/l	
	1,1-Dichloropropene	Blank	<2.0	ug/l	
	1,2-Dichloropropane	Blank	<1.0	ug/l	
	1,3-Dichloropropane	Blank	<0.5	ug/l	
	2,2-Dichloropropane	Blank	<1.0	ug/l	
	1,1,1,2-Tetrachloroethane	Blank	<1.0	ug/l	
	1,2,3-Trichloropropane	Blank	<2.0	ug/l	
	n-Butylbenzene	Blank	<1.0	ug/l	
	Dichlorodifluoromethane	Blank	<2.0	ug/l	
	Bromochloromethane	Blank	<1.0	ug/l	
	Bromobenzene	Blank	<1.0	ug/l	
	Acrylonitrile	Blank	<5.0	ug/l	
	Carbon Disulfide	Blank	<3.0	ug/l	
	2-Hexanone	Blank	<10.0	ug/l	
	trans-1,4-Dichloro-2-Butene	Blank	<2.0	ug/l	



39 Spruce Street ° East Longmeadow, MA 01028 ° FAX 413/525-6405 ° TEL. 413/525-2332

QC SUMMARY REPORT

SAMPLE QC: Sample Results with Duplicates

BATCH QC: Lab fortified Blanks and Duplicates

Sample Matrix Spikes and Matrix Spike Duplicates

Standard Reference Materials and Duplicates

Method Blanks

Report Date: 5/30/2007

Lims Bat #: LIMT-06424

Page 4 of 11

QC Batch Number: GCMS/VOL-16942

Sample Id	Analysis	QC Analysis	Values	Units	Limits
BLANK-102333	Diethyl Ether	Blank	<2.0	ug/l	
	Bromodichloromethane	Blank	<1.0	ug/l	
	1,2-Dibromo-3-Chloropropane	Blank	<5.0	ug/l	
	1,2-Dibromoethane	Blank	<0.50	ug/l	
	Tetrahydrofuran	Blank	<10.0	ug/l	
	tert-Butyl Alcohol	Blank	<20.0	ug/l	
	Diisopropyl Ether	Blank	<0.5	ug/l	
	tert-Butylethyl Ether	Blank	<0.5	ug/l	
	tert-Amylmethyl Ether	Blank	<0.5	ug/l	
LFBLANK-63479	Acetone	Lab Fort Blank Amt.	10.0	ug/l	
		Lab Fort Blk. Found	5.2	ug/l	
		Lab Fort Blk. % Rec.	52.0	%	70-160
	Benzene	Lab Fort Blank Amt.	10.0	ug/l	
		Lab Fort Blk. Found	10.7	ug/l	
		Lab Fort Blk. % Rec.	107.3	%	70-130
	Carbon Tetrachloride	Lab Fort Blank Amt.	10.0	ug/l	
		Lab Fort Blk. Found	13.8	ug/l	
		Lab Fort Blk. % Rec.	138.1	%	70-130
	Chloroform	Lab Fort Blank Amt.	10.0	ug/l	
		Lab Fort Blk. Found	10.7	ug/l	
		Lab Fort Blk. % Rec.	107.6	%	70-130
	1,2-Dichloroethane	Lab Fort Blank Amt.	10.0	ug/l	
		Lab Fort Blk. Found	10.4	ug/l	
		Lab Fort Blk. % Rec.	104.4	%	70-130
	1,4-Dichlorobenzene	Lab Fort Blank Amt.	10.0	ug/l	
		Lab Fort Blk. Found	9.1	ug/l	
		Lab Fort Blk. % Rec.	91.9	%	70-130
	Ethyl Benzene	Lab Fort Blank Amt.	10.0	ug/l	
		Lab Fort Blk. Found	9.9	ug/l	
		Lab Fort Blk. % Rec.	99.6	%	70-130
	2-Butanone (MEK)	Lab Fort Blank Amt.	10.0	ug/l	
		Lab Fort Blk. Found	7.7	ug/l	
		Lab Fort Blk. % Rec.	77.2	%	40-160
	MIBK	Lab Fort Blank Amt.	10.0	ug/l	
		Lab Fort Blk. Found	11.4	ug/l	
		Lab Fort Blk. % Rec.	114.3	%	70-160
	Naphthalene	Lab Fort Blank Amt.	10.0	ug/l	
		Lab Fort Blk. Found	7.9	ug/l	
		Lab Fort Blk. % Rec.	79.0	%	40-130
Styrene	Lab Fort Blank Amt.	10.0	ug/l		
	Lab Fort Blk. Found	10.5	ug/l		
	Lab Fort Blk. % Rec.	105.6	%	70-130	



39 Spruce Street ° East Longmeadow, MA 01028 ° FAX 413/525-6405 ° TEL. 413/525-2332

**QC SUMMARY REPORT**

SAMPLE QC: Sample Results with Duplicates

BATCH QC: Lab fortified Blanks and Duplicates

Sample Matrix Spikes and Matrix Spike Duplicates

Standard Reference Materials and Duplicates

Method Blanks

Report Date: 5/30/2007

Lims Bat #: LIMT-06424

Page 5 of 11

QC Batch Number: GCMS/VOL-16942

Sample Id	Analysis	QC Analysis	Values	Units	Limits
LFBLANK-63479	Tetrachloroethylene	Lab Fort Blank Amt.	10.0	ug/l	
		Lab Fort Blk. Found	10.6	ug/l	
		Lab Fort Blk. % Rec.	106.7	%	70-160
	Toluene	Lab Fort Blank Amt.	10.0	ug/l	
		Lab Fort Blk. Found	10.0	ug/l	
		Lab Fort Blk. % Rec.	100.0	%	70-130
	1,1,1-Trichloroethane	Lab Fort Blank Amt.	10.0	ug/l	
		Lab Fort Blk. Found	11.2	ug/l	
		Lab Fort Blk. % Rec.	112.9	%	70-130
	Trichloroethylene	Lab Fort Blank Amt.	10.0	ug/l	
		Lab Fort Blk. Found	9.7	ug/l	
		Lab Fort Blk. % Rec.	97.9	%	70-130
	1,1,2-Trichloro-1,2,2-Trifluoroethane	Lab Fort Blank Amt.	10.0	ug/l	
		Lab Fort Blk. Found	10.6	ug/l	
		Lab Fort Blk. % Rec.	106.2	%	70-130
	Trichlorofluoromethane	Lab Fort Blank Amt.	10.0	ug/l	
		Lab Fort Blk. Found	9.1	ug/l	
		Lab Fort Blk. % Rec.	91.5	%	70-160
	o-Xylene	Lab Fort Blank Amt.	10.0	ug/l	
		Lab Fort Blk. Found	9.8	ug/l	
		Lab Fort Blk. % Rec.	98.8	%	70-130
	m + p Xylene	Lab Fort Blank Amt.	20.0	ug/l	
		Lab Fort Blk. Found	19.8	ug/l	
		Lab Fort Blk. % Rec.	99.0	%	70-130
	1,2-Dichlorobenzene	Lab Fort Blank Amt.	10.0	ug/l	
		Lab Fort Blk. Found	9.3	ug/l	
		Lab Fort Blk. % Rec.	93.2	%	70-130
	1,3-Dichlorobenzene	Lab Fort Blank Amt.	10.0	ug/l	
		Lab Fort Blk. Found	9.5	ug/l	
		Lab Fort Blk. % Rec.	95.8	%	70-130
1,1-Dichloroethane	Lab Fort Blank Amt.	10.0	ug/l		
	Lab Fort Blk. Found	10.6	ug/l		
	Lab Fort Blk. % Rec.	106.9	%	70-130	
1,1-Dichloroethylene	Lab Fort Blank Amt.	10.0	ug/l		
	Lab Fort Blk. Found	8.7	ug/l		
	Lab Fort Blk. % Rec.	87.0	%	70-130	
1,4-Dioxane	Lab Fort Blank Amt.	50.0	ug/l		
	Lab Fort Blk. Found	41.2	ug/l		
	Lab Fort Blk. % Rec.	82.5	%	40-130	
MTBE	Lab Fort Blank Amt.	20.0	ug/l		
	Lab Fort Blk. Found	20.3	ug/l		
	Lab Fort Blk. % Rec.	101.5	%	70-130	
trans-1,2-Dichloroethylene	Lab Fort Blank Amt.	10.0	ug/l		





39 Spruce Street ° East Longmeadow, MA 01028 ° FAX 413/525-6405 ° TEL. 413/525-2332

**QC SUMMARY REPORT**

SAMPLE QC: Sample Results with Duplicates

BATCH QC: Lab fortified Blanks and Duplicates

Sample Matrix Spikes and Matrix Spike Duplicates

Standard Reference Materials and Duplicates

Method Blanks

Report Date: 5/30/2007

Lims Bat #: LIMT-06424

Page 6 of 11

QC Batch Number: GCMS/VOL-16942

Sample Id	Analysis	QC Analysis	Values	Units	Limits
LFBLANK-63479	trans-1,2-Dichloroethylene	Lab Fort Blk. Found	10.2	ug/l	
		Lab Fort Blk. % Rec.	102.8	%	70-130
	Vinyl Chloride	Lab Fort Blank Amt.	10.0	ug/l	
		Lab Fort Blk. Found	8.3	ug/l	
	Methylene Chloride	Lab Fort Blk. % Rec.	83.0	%	40-160
		Lab Fort Blank Amt.	10.0	ug/l	
	Chlorobenzene	Lab Fort Blk. Found	10.2	ug/l	
		Lab Fort Blk. % Rec.	102.1	%	70-130
		Lab Fort Blank Amt.	10.0	ug/l	
	Chloromethane	Lab Fort Blk. Found	10.0	ug/l	
		Lab Fort Blk. % Rec.	100.6	%	70-130
		Lab Fort Blank Amt.	10.0	ug/l	
	Bromomethane	Lab Fort Blk. Found	8.2	ug/l	
		Lab Fort Blk. % Rec.	82.8	%	40-160
		Lab Fort Blank Amt.	10.0	ug/l	
	Chloroethane	Lab Fort Blk. Found	32.5	ug/l	
		Lab Fort Blk. % Rec.	325.4	%	40-160
		Lab Fort Blank Amt.	10.0	ug/l	
	cis-1,3-Dichloropropene	Lab Fort Blk. Found	9.7	ug/l	
		Lab Fort Blk. % Rec.	97.3	%	70-130
		Lab Fort Blank Amt.	10.0	ug/l	
	trans-1,3-Dichloropropene	Lab Fort Blk. Found	11.9	ug/l	
		Lab Fort Blk. % Rec.	119.1	%	70-130
		Lab Fort Blank Amt.	10.0	ug/l	
	Chlorodibromomethane	Lab Fort Blk. Found	11.9	ug/l	
		Lab Fort Blk. % Rec.	119.9	%	70-130
		Lab Fort Blank Amt.	10.0	ug/l	
	1,1,2-Trichloroethane	Lab Fort Blk. Found	13.0	ug/l	
		Lab Fort Blk. % Rec.	130.2	%	70-130
		Lab Fort Blank Amt.	10.0	ug/l	
	Bromoform	Lab Fort Blk. Found	10.3	ug/l	
		Lab Fort Blk. % Rec.	103.4	%	70-130
		Lab Fort Blank Amt.	10.0	ug/l	
	1,1,2,2-Tetrachloroethane	Lab Fort Blk. Found	12.7	ug/l	
		Lab Fort Blk. % Rec.	127.9	%	70-130
		Lab Fort Blank Amt.	10.0	ug/l	
	2-Chlorotoluene	Lab Fort Blk. Found	10.0	ug/l	
		Lab Fort Blk. % Rec.	100.6	%	70-130
		Lab Fort Blank Amt.	10.0	ug/l	
	Hexachlorobutadiene	Lab Fort Blk. Found	9.8	ug/l	
		Lab Fort Blk. % Rec.	98.2	%	70-130
		Lab Fort Blank Amt.	10.0	ug/l	
		Lab Fort Blk. Found	8.2	ug/l	



39 Spruce Street ° East Longmeadow, MA 01028 ° FAX 413/525-6405 ° TEL. 413/525-2332

**QC SUMMARY REPORT**

SAMPLE QC: Sample Results with Duplicates

BATCH QC: Lab fortified Blanks and Duplicates

Sample Matrix Spikes and Matrix Spike Duplicates

Standard Reference Materials and Duplicates

Method Blanks

Report Date: 5/30/2007

Lims Bat #: LIMT-06424

Page 7 of 11

QC Batch Number: GCMS/VOL-16942

Sample Id	Analysis	QC Analysis	Values	Units	Limits
LFBLANK-63479	Hexachlorobutadiene	Lab Fort Blk. % Rec.	82.3	%	70-130
	Isopropylbenzene	Lab Fort Blank Amt.	10.0	ug/l	
		Lab Fort Blk. Found	9.4	ug/l	
	p-Isopropyltoluene	Lab Fort Blk. % Rec.	94.6	%	70-130
		Lab Fort Blank Amt.	10.0	ug/l	
		Lab Fort Blk. Found	8.9	ug/l	
	n-Propylbenzene	Lab Fort Blk. % Rec.	89.9	%	70-130
		Lab Fort Blank Amt.	10.0	ug/l	
		Lab Fort Blk. Found	9.7	ug/l	
	sec-Butylbenzene	Lab Fort Blk. % Rec.	97.7	%	70-130
		Lab Fort Blank Amt.	10.0	ug/l	
		Lab Fort Blk. Found	8.9	ug/l	
	tert-Butylbenzene	Lab Fort Blk. % Rec.	89.9	%	70-130
		Lab Fort Blank Amt.	10.0	ug/l	
		Lab Fort Blk. Found	10.3	ug/l	
	1,2,3-Trichlorobenzene	Lab Fort Blk. % Rec.	103.6	%	70-130
		Lab Fort Blank Amt.	10.0	ug/l	
		Lab Fort Blk. Found	7.7	ug/l	
	1,2,4-Trichlorobenzene	Lab Fort Blk. % Rec.	77.0	%	70-130
		Lab Fort Blank Amt.	10.0	ug/l	
		Lab Fort Blk. Found	7.7	ug/l	
	1,2,4-Trimethylbenzene	Lab Fort Blk. % Rec.	77.2	%	70-130
		Lab Fort Blank Amt.	10.0	ug/l	
		Lab Fort Blk. Found	9.1	ug/l	
	1,3,5-Trimethylbenzene	Lab Fort Blk. % Rec.	91.2	%	70-130
		Lab Fort Blank Amt.	10.0	ug/l	
		Lab Fort Blk. Found	9.2	ug/l	
	Dibromomethane	Lab Fort Blk. % Rec.	92.4	%	70-130
		Lab Fort Blank Amt.	10.0	ug/l	
		Lab Fort Blk. Found	10.1	ug/l	
	cis-1,2-Dichloroethylene	Lab Fort Blk. % Rec.	101.9	%	70-130
		Lab Fort Blank Amt.	10.0	ug/l	
		Lab Fort Blk. Found	10.7	ug/l	
	4-Chlorotoluene	Lab Fort Blk. % Rec.	107.5	%	70-130
		Lab Fort Blank Amt.	10.0	ug/l	
		Lab Fort Blk. Found	9.1	ug/l	
	1,1-Dichloropropene	Lab Fort Blk. % Rec.	91.8	%	70-130
		Lab Fort Blank Amt.	10.0	ug/l	
		Lab Fort Blk. Found	10.5	ug/l	
	1,2-Dichloropropane	Lab Fort Blk. % Rec.	105.5	%	70-130
		Lab Fort Blank Amt.	10.0	ug/l	
		Lab Fort Blk. Found	10.6	ug/l	
		Lab Fort Blk. % Rec.	106.6	%	70-130



39 Spruce Street ° East Longmeadow, MA 01028 ° FAX 413/525-6405 ° TEL. 413/525-2332

**QC SUMMARY REPORT**

SAMPLE QC: Sample Results with Duplicates

BATCH QC: Lab fortified Blanks and Duplicates

Sample Matrix Spikes and Matrix Spike Duplicates

Standard Reference Materials and Duplicates

Method Blanks

Report Date: 5/30/2007

Lims Bat #: LIMT-06424

Page 8 of 11

QC Batch Number: GCMS/VOL-16942

Sample Id	Analysis	QC Analysis	Values	Units	Limits
LFBLANK-63479					
	1,3-Dichloropropane	Lab Fort Blank Amt.	10.0	ug/l	
		Lab Fort Blk. Found	10.2	ug/l	
		Lab Fort Blk. % Rec.	102.0	%	70-130
	2,2-Dichloropropane	Lab Fort Blank Amt.	10.0	ug/l	
		Lab Fort Blk. Found	10.4	ug/l	
		Lab Fort Blk. % Rec.	104.8	%	40-130
	1,1,1,2-Tetrachloroethane	Lab Fort Blank Amt.	10.0	ug/l	
		Lab Fort Blk. Found	13.2	ug/l	
		Lab Fort Blk. % Rec.	132.7	%	70-130
	1,2,3-Trichloropropane	Lab Fort Blank Amt.	10.0	ug/l	
		Lab Fort Blk. Found	8.9	ug/l	
		Lab Fort Blk. % Rec.	89.4	%	70-130
	n-Butylbenzene	Lab Fort Blank Amt.	10.0	ug/l	
		Lab Fort Blk. Found	8.7	ug/l	
		Lab Fort Blk. % Rec.	87.1	%	70-130
	Dichlorodifluoromethane	Lab Fort Blank Amt.	10.0	ug/l	
		Lab Fort Blk. Found	6.4	ug/l	
		Lab Fort Blk. % Rec.	64.0	%	40-160
	Bromochloromethane	Lab Fort Blank Amt.	10.0	ug/l	
		Lab Fort Blk. Found	11.2	ug/l	
		Lab Fort Blk. % Rec.	112.9	%	70-130
	Bromobenzene	Lab Fort Blank Amt.	10.0	ug/l	
		Lab Fort Blk. Found	9.9	ug/l	
		Lab Fort Blk. % Rec.	99.4	%	70-130
	Acrylonitrile	Lab Fort Blank Amt.	10.0	ug/l	
		Lab Fort Blk. Found	11.2	ug/l	
		Lab Fort Blk. % Rec.	112.5	%	70-160
	Carbon Disulfide	Lab Fort Blank Amt.	10.0	ug/l	
		Lab Fort Blk. Found	10.5	ug/l	
		Lab Fort Blk. % Rec.	105.1	%	70-130
	2-Hexanone	Lab Fort Blank Amt.	10.0	ug/l	
		Lab Fort Blk. Found	7.4	ug/l	
		Lab Fort Blk. % Rec.	74.0	%	70-160
	trans-1,4-Dichloro-2-Butene	Lab Fort Blank Amt.	10.0	ug/l	
		Lab Fort Blk. Found	8.7	ug/l	
		Lab Fort Blk. % Rec.	87.5	%	70-130
	Diethyl Ether	Lab Fort Blank Amt.	10.0	ug/l	
		Lab Fort Blk. Found	9.1	ug/l	
		Lab Fort Blk. % Rec.	91.2	%	70-130
	Bromodichloromethane	Lab Fort Blank Amt.	10.0	ug/l	
		Lab Fort Blk. Found	10.8	ug/l	
		Lab Fort Blk. % Rec.	108.0	%	70-130
	1,2-Dibromo-3-Chloropropane	Lab Fort Blank Amt.	10.0	ug/l	



39 Spruce Street ° East Longmeadow, MA 01028 ° FAX 413/525-6405 ° TEL. 413/525-2332

**QC SUMMARY REPORT**

SAMPLE QC: Sample Results with Duplicates

BATCH QC: Lab fortified Blanks and Duplicates

Sample Matrix Spikes and Matrix Spike Duplicates

Standard Reference Materials and Duplicates

Method Blanks

Report Date: 5/30/2007

Lims Bat # : LIMT-06424

Page 9 of 11

QC Batch Number: GCMS/VOL-16942

Sample Id	Analysis	QC Analysis	Values	Units	Limits
LFBLANK-63479	1,2-Dibromo-3-Chloropropane	Lab Fort Blk. Found	9.0	ug/l	
		Lab Fort Blk. % Rec.	90.7	%	70-130
	1,2-Dibromoethane	Lab Fort Blank Amt.	10.00	ug/l	
		Lab Fort Blk. Found	10.24	ug/l	
	Tetrahydrofuran	Lab Fort Blk. % Rec.	102.40	%	70-130
		Lab Fort Blank Amt.	10.0	ug/l	
tert-Butyl Alcohol		Lab Fort Blk. Found	8.2	ug/l	
		Lab Fort Blk. % Rec.	82.3	%	70-130
		Lab Fort Blank Amt.	50.0	ug/l	
Diisopropyl Ether		Lab Fort Blk. Found	41.3	ug/l	
		Lab Fort Blk. % Rec.	82.7	%	40-160
		Lab Fort Blank Amt.	10.0	ug/l	
tert-Butylethyl Ether		Lab Fort Blk. Found	10.8	ug/l	
		Lab Fort Blk. % Rec.	108.8	%	70-130
		Lab Fort Blank Amt.	10.0	ug/l	
tert-Amylmethyl Ether		Lab Fort Blk. Found	10.2	ug/l	
		Lab Fort Blk. % Rec.	102.2	%	70-160
		Lab Fort Blank Amt.	10.0	ug/l	
		Lab Fort Blk. Found	9.8	ug/l	
		Lab Fort Blk. % Rec.	98.5	%	70-130



39 Spruce Street ° East Longmeadow, MA 01028 ° FAX 413/525-6405 ° TEL. 413/525-2332

### QC SUMMARY REPORT

SAMPLE QC: Sample Results with Duplicates  
Sample Matrix Spikes and Matrix Spike Duplicates

BATCH QC: Lab fortified Blanks and Duplicates  
Standard Reference Materials and Duplicates  
Method Blanks

Report Date: 5/30/2007

Lims Bat #: LIMT-06424

Page 10 of 11

#### NOTES:

QC Batch No. : GCMS/VOL-16942  
Sample ID : LFBLANK-63479  
Analysis : 1,1,1,2-Tetrachloroethane

LABORATORY FORTIFIED BLANK RECOVERY OUTSIDE OF CONTROL LIMITS. DATA VALIDATION IS NOT AFFECTED SINCE ALL RESULTS ARE "NOT DETECTED" FOR ALL SAMPLES IN THIS BATCH FOR THIS COMPOUND AND BIAS IS ON THE HIGH SIDE.

QC Batch No. : GCMS/VOL-16942  
Sample ID : LFBLANK-63479  
Analysis : Acetone

LABORATORY FORTIFIED BLANK RECOVERY OUTSIDE OF CONTROL LIMITS. ANY REPORTED RESULT FOR THIS COMPOUND IN THIS BATCH IS LIKELY TO BE BIASED ON THE LOW SIDE.

QC Batch No. : GCMS/VOL-16942  
Sample ID : LFBLANK-63479  
Analysis : Bromomethane

LABORATORY FORTIFIED BLANK RECOVERY OUTSIDE OF CONTROL LIMITS. DATA VALIDATION IS NOT AFFECTED SINCE ALL RESULTS ARE "NOT DETECTED" FOR ALL SAMPLES IN THIS BATCH FOR THIS COMPOUND AND BIAS IS ON THE HIGH SIDE.

QC Batch No. : GCMS/VOL-16942  
Sample ID : LFBLANK-63479  
Analysis : Carbon Tetrachloride

LABORATORY FORTIFIED BLANK RECOVERY OUTSIDE OF CONTROL LIMITS. DATA VALIDATION IS NOT AFFECTED SINCE ALL RESULTS ARE "NOT DETECTED" FOR ALL SAMPLES IN THIS BATCH FOR THIS COMPOUND AND BIAS IS ON THE HIGH SIDE.

QC Batch No. : GCMS/VOL-16942  
Sample ID : LFBLANK-63479  
Analysis : Chlorodibromomethane

LABORATORY FORTIFIED BLANK RECOVERY OUTSIDE OF CONTROL LIMITS. DATA VALIDATION IS NOT AFFECTED SINCE ALL RESULTS ARE "NOT DETECTED" FOR ALL SAMPLES IN THIS BATCH FOR THIS COMPOUND AND BIAS IS ON THE HIGH SIDE.



39 Spruce Street ° East Longmeadow, MA 01028 ° FAX 413/525-6405 ° TEL. 413/525-2332

### QC SUMMARY REPORT

SAMPLE QC: Sample Results with Duplicates

BATCH QC: Lab fortified Blanks and Duplicates

Sample Matrix Spikes and Matrix Spike Duplicates

Standard Reference Materials and Duplicates

Method Blanks

Report Date: 5/30/2007

Lims Bat #: LIMT-06424

Page 11 of 11

### QUALITY CONTROL DEFINITIONS AND ABBREVIATIONS

QC BATCH NUMBER	This is the number assigned to all samples analyzed together that would be subject to comparison with a particular set of Quality Control Data.
LIMITS	Upper and Lower Control Limits for the QC ANALYSIS Reported. All values normally would fall within these statistically determined limits, unless there is an unusual circumstance that would be documented in a NOTE appearing on the last page of the QC SUMMARY REPORT. Not all QC results will have Limits defined.
Sample Amount	Amount of analyte found in a sample.
Blank	Method Blank that has been taken through all the steps of the analysis.
LFBLANK	Laboratory Fortified Blank (a control sample)
STDADD	Standard Added (a laboratory control sample)
Matrix Spk Amt Added	Amount of analyte spiked into a sample
MS Amt Measured	Amount of analyte found including amount that was spiked
Matrix Spike % Rec.	% Recovery of spiked amount in sample.
Duplicate Value	The result from the Duplicate analysis of the sample.
Duplicate RPD	The Relative Percent Difference between two Duplicate Analyses.
Surrogate Recovery	The % Recovery for non-environmental compounds (surrogates) spiked into samples to determine the performance of the analytical methods.
Sur. Recovery (ELCD)	Surrogate Recovery on the Electrolytic Conductivity Detector.
Sur. Recovery (PID)	Surrogate Recovery on the Photoionization Detector.
Standard Measured	Amount measured for a laboratory control sample
Standard Amt Added	Known value for a laboratory control sample
Standard % Recovery	% recovered for a laboratory control sample with a known value.
Lab Fort Blank Amt	Laboratory Fortified Blank Amount Added
Lab Fort Blk. Found	Laboratory Fortified Blank Amount Found
Lab Fort Blk % Rec	Laboratory Fortified Blank % Recovered
Dup Lab Fort Bl Amt	Duplicate Laboratory Fortified Blank Amount Added
Dup Lab Fort Bl Fnd	Duplicate Laboratory Fortified Blank Amount Found
Dup Lab Fort Bl % Rec	Duplicate Laboratory Fortified Blank % Recovery
Lab Fort Blank Range	Laboratory Fortified Blank Range (Absolute value of difference between recoveries for Lab Fortified Blank and Lab Fortified Blank Duplicate).
Lab Fort Bl. Av. Rec.	Laboratory Fortified Blank Average Recovery
Duplicate Sample Amt	Sample Value for Duplicate used with Matrix Spike Duplicate
MSD Amount Added	Matrix Spike Duplicate Amount Added (Spiked)
MSD Amt Measured	Matrix Spike Duplicate Amount Measured
MSD % Recovery	Matrix Spike Duplicate % Recovery
MSD Range	Absolute difference between Matrix Spike and Matrix Spike Duplicate Recoveries



Phone: 413-525-2332  
 Fax: 413-525-6405  
 Email: info@contestlabs.com  
 www.contestlabs.com

**CHAIN OF CUSTODY RECORD**

39 SPRUCE ST, 2ND FLOOR  
 EAST LONGMEADOW, MA 01028

Company Name: LEK Inc.  
 Address: 300 Metro Center Blvd. #250  
Warwick RI 02886

Attention: Donna Pallister

Project Location: Springfield St. School  
 Sampled By: Walter Bonn / Chris Johnson

Proposal Provided? (For Billing purposes)  yes  no  
 State Form Required?  yes  no

Telephone: (401) 738-3887  
 Project # 081-12152-03  
 Client PO # \_\_\_\_\_

**DATA DELIVERY (check one):**

FAX  EMAIL  WEBSITE CLIENT  
 Fax #: \_\_\_\_\_  
 Email: Donna.Pallister@LEK.com  
 Format:  EXCEL  PDF  GIS KEY  
 OTHER \_\_\_\_\_

Field ID	Sample Description	Lab #	Start Date/Time	Stop Date/Time	Comp- osile	Grab	Matrix   Conc. Code   Code	ANALYSIS REQUESTED	
									# of container
									**Preservator
									Cont. Code
									Cont. Code
									**Cont. Code:
									A=amber glass
									G=glass
									P=plastic
									ST=sterile
									V=vial
									S=summary cert
									T=tearful bag
									O=Other
									Client
									Comments

Laboratory Comments: \_\_\_\_\_  
 Relinquished by: (signature) to ref signature Date/Time: 5/17/07 11:20  
 Received by: (signature) \_\_\_\_\_ Date/Time: 5/21/07 15:00  
 Relinquished by: (signature) Donna Pallister Date/Time: 5/21/07 19:00  
 Received by: (signature) \_\_\_\_\_ Date/Time: 5/22/07 17:35

**Turnaround \*\***

7-Day  
 10-Day  
 Other SH  
 RUSH \*

**Detection Limit Requirements**

Regulations? RIDE M GW-2  
 Data Enhancement Project/RCP?  Y  N  
 Special Requirements or D.L.s: \_\_\_\_\_

**Matrix Code:**

GW = groundwater  
 WW = wastewater  
 DW = drinking water  
 A = air  
 S = soil/solid  
 SL = sludge  
 O = other

**\*\*Preservation Codes:**

I = Iced  
 H = HCL  
 M = Methanol  
 N = Nitric Acid  
 S = Sulfuric Acid  
 B = Sodium bisulfate  
 O = Other  
 X = Na hydroxide  
 T = Na thiosulfate

\*\* TURNAROUND TIME STARTS AT 9:00 A.M. THE DAY AFTER SAMPLE RECEIPT UNLESS THERE ARE QUESTIONS ON YOUR CHAIN. IF THIS FORM IS NOT FILLED OUT COMPLETELY OR IS INCORRECT, TURNAROUND TIME WILL NOT START UNTIL ALL QUESTIONS ARE ANSWERED BY OUR CLIENT.  
 AIHA, NELAC & WBE/DBF Certified



www.contestlabs.com

39 Spruce Street  
East Longmeadow, MA  
Phone: 1-413-525-2332  
Fax: 1-413-525-6405

SAMPLE RECEIPT CHECKLIST

CLIENT NAME: LFR  
RECEIVED BY: VAF DATE: 5/22

1. Was chain of custody relinquished and signed?  YES  NO

2. Does Chain agree with samples?  YES  NO

If not, explain:

3. All Samples in good condition?  YES  NO

If not, explain:

4. Were samples received in compliance with Temperature 0-6 degrees C?  YES  NO Degrees: 40°C

5. Are there any dissolved samples for the lab to filter? YES   NO

Who was notified? \_\_\_\_\_ Date: \_\_\_\_\_ Time: \_\_\_\_\_

6. Are there any on hold samples? YES   NO STORED WHERE:

7. Are there any short holding time samples and who was notified? \_\_\_\_\_ Date: \_\_\_\_\_ Time: \_\_\_\_\_

8. Location where samples are stored: 2C

CONTAINERS SENT IN TO CON-TEST	# of container
1 liter amber	
500 ml amber	
250 ml amber (8oz. Amber)	
1 liter plastic	
500 ml plastic	
250 ml plastic	
40 ml vial—which kind—list below	10
Colisure bottle	
Dissolved oxygen bottle	
Flashpoint bottle	

CONTAINERS SENT TO CON-TEST	# of containers
Air Cassettes	
8 oz clear jar	
4 oz clear jar	
2 oz clear jar	
Plastic bag	
Encore	
Brass Sleeves	
Tubes	
Summa cans	
Other	2

Laboratory comments:

# of HCL Vial \_\_\_\_\_ # of Methanol vials \_\_\_\_\_ # of Sodium Bisulfate vials \_\_\_\_\_  
# of DI water(to be frozen) vials \_\_\_\_\_ Time and Date when frozen \_\_\_\_\_

Do all the samples have the correct pH levels?  YES  NO If no, please explain above



**Attachment B**  
**Soil Gas Graphs**



**Soil Gas Well WB1**  
**Fluctuation in Methane, Oxygen, and Carbon Dioxide Percentages over Time**  
**Springfield Street School Complex**  
**Providence, Rhode Island**

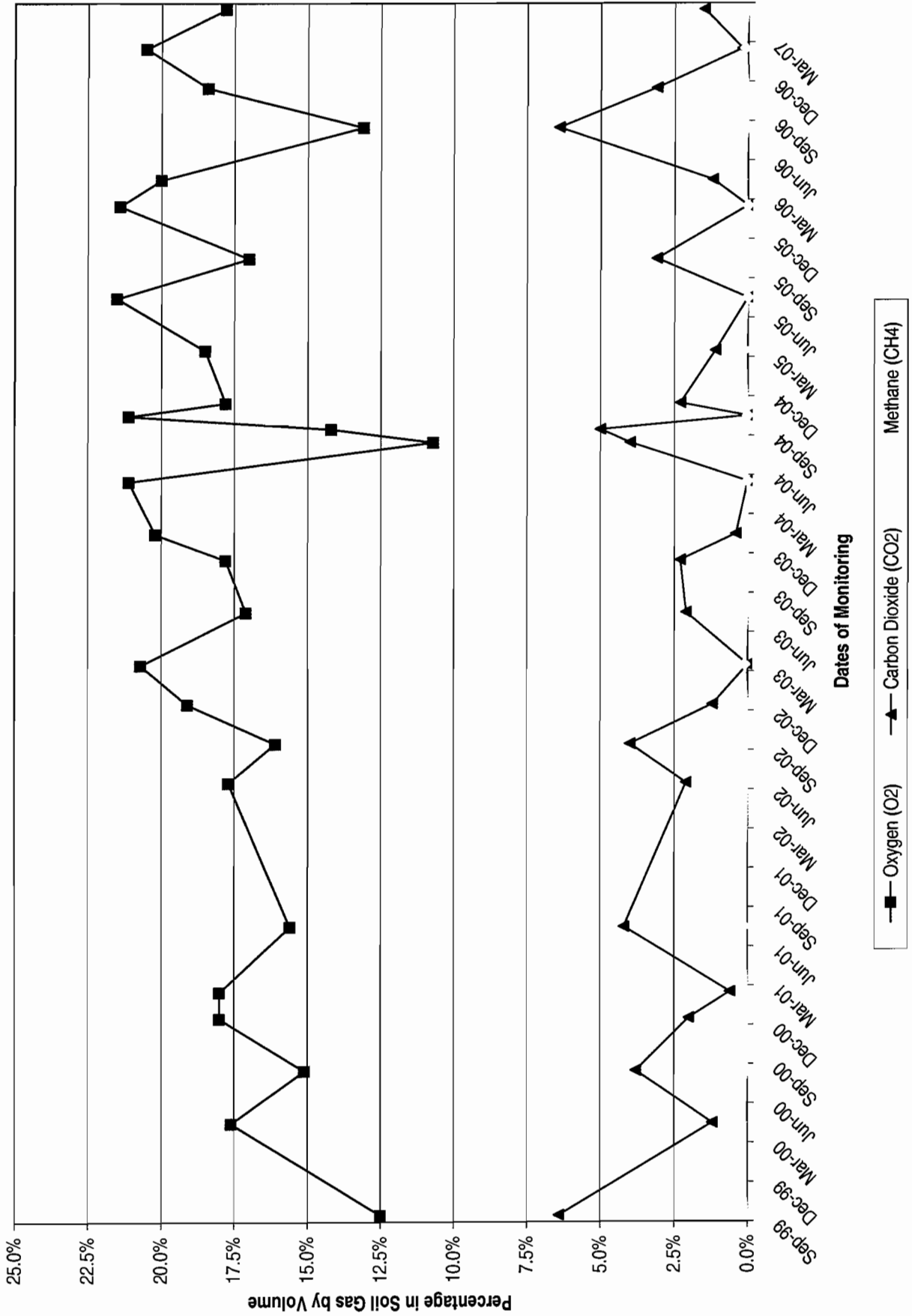

**Soil Gas Well WB7**  
**Fluctuation in Methane, Oxygen, and Carbon Dioxide Percentages over Time**  
**Springfield Street School Complex**  
**Providence, Rhode Island**

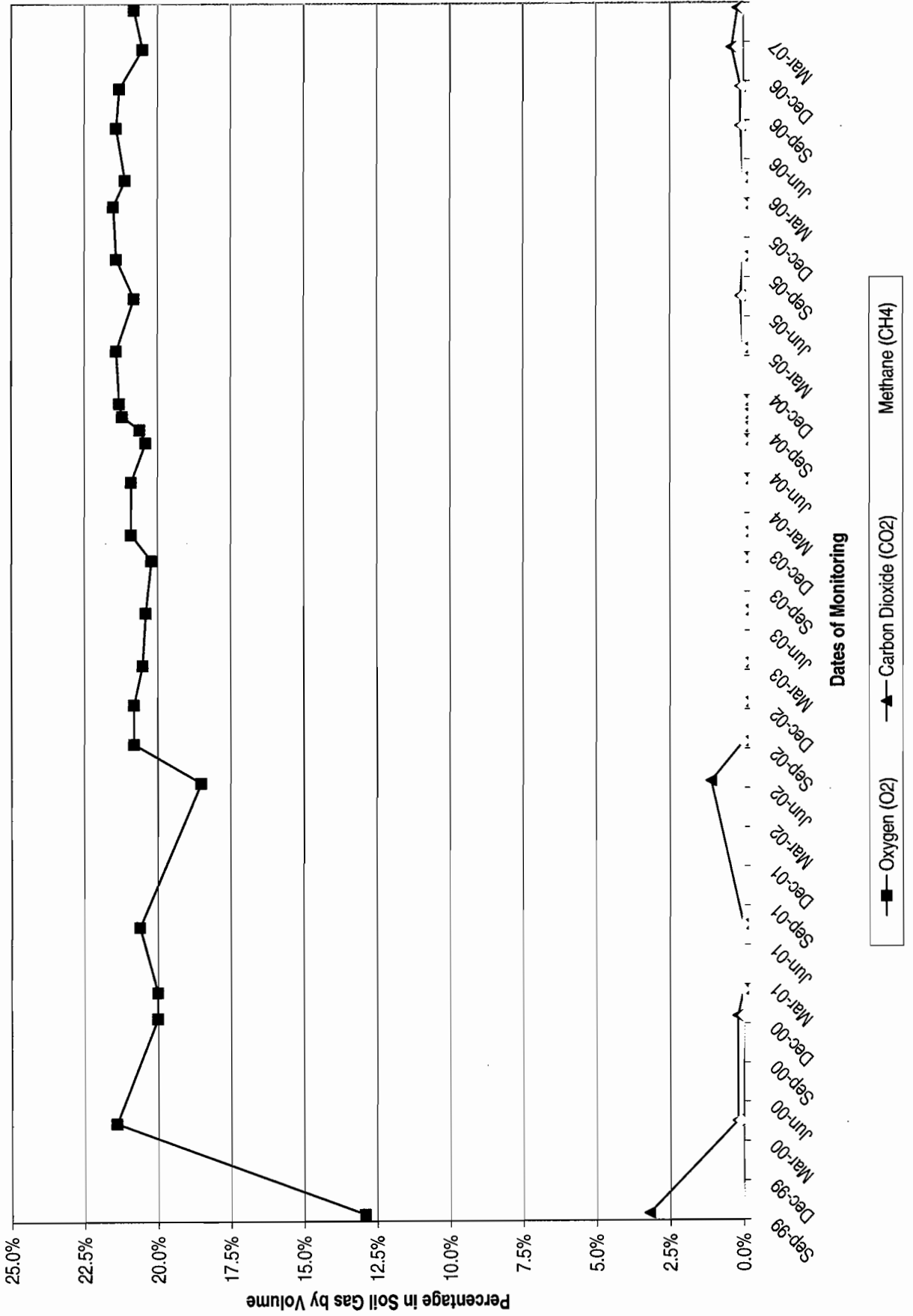

**Soil Gas Well WB15**  
**Fluctuation in Methane, Oxygen, and Carbon Dioxide Percentages over Time**  
**Springfield Street School Complex**  
**Providence, Rhode Island**

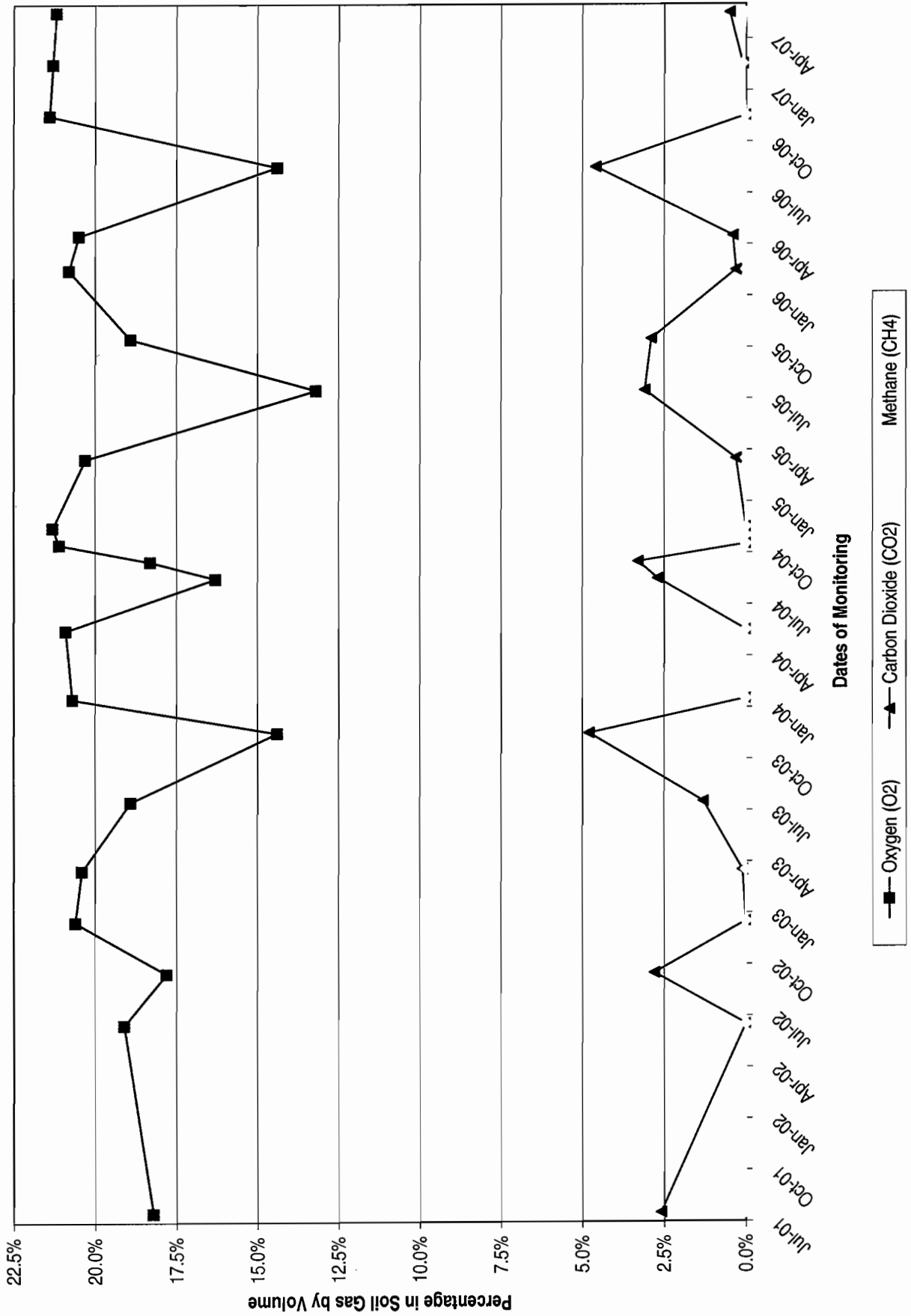

**Soil Gas Well MPL5**  
**Fluctuation in Methane, Oxygen, and Carbon Dioxide Percentages over Time**  
**Springfield Street School Complex**  
**Providence, Rhode Island**

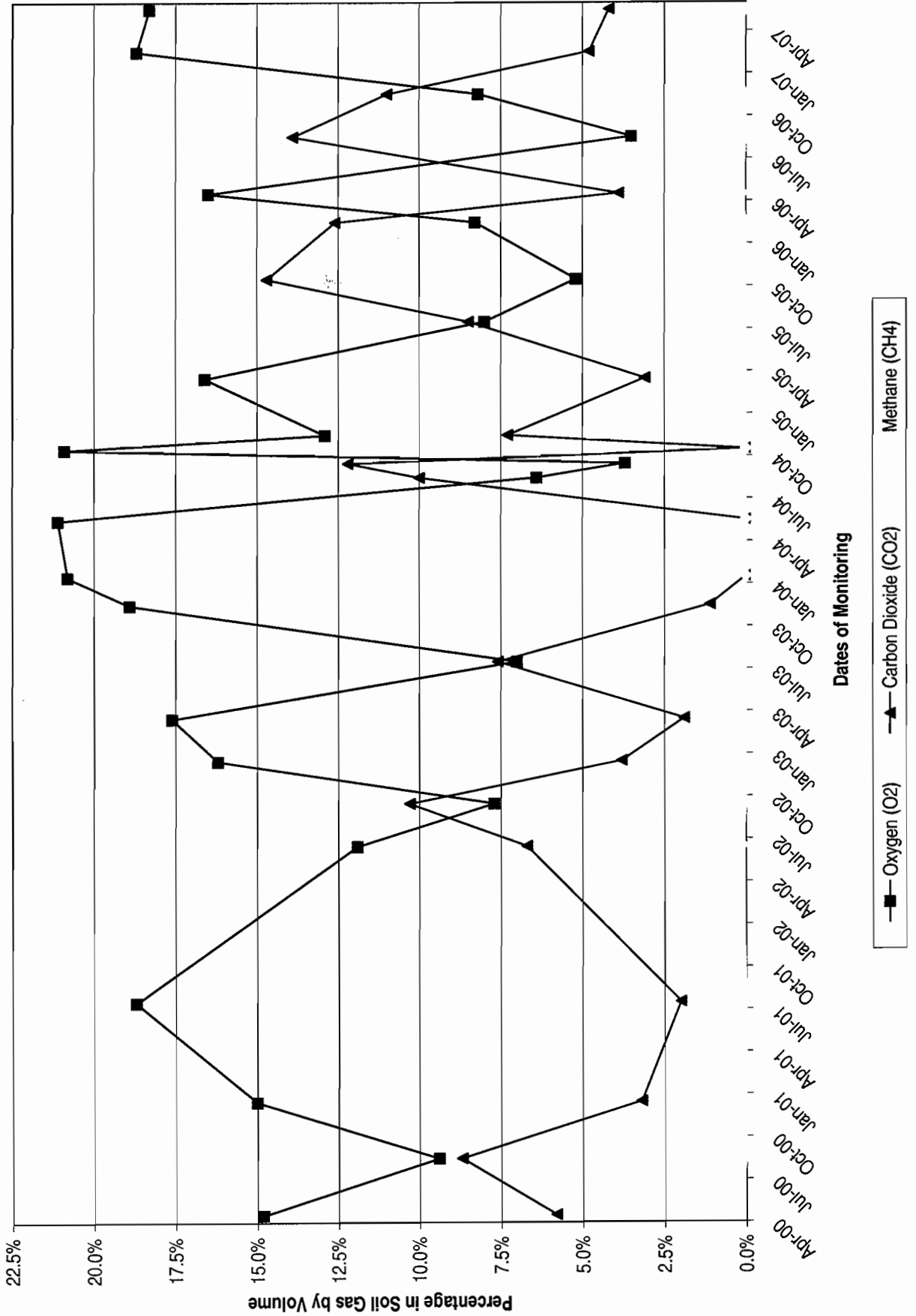

**Soil Gas Well MG2**  
**Fluctuation in Methane, Oxygen, and Carbon Dioxide Percentages over Time**  
**Springfield Street School Complex**  
**Providence, Rhode Island**

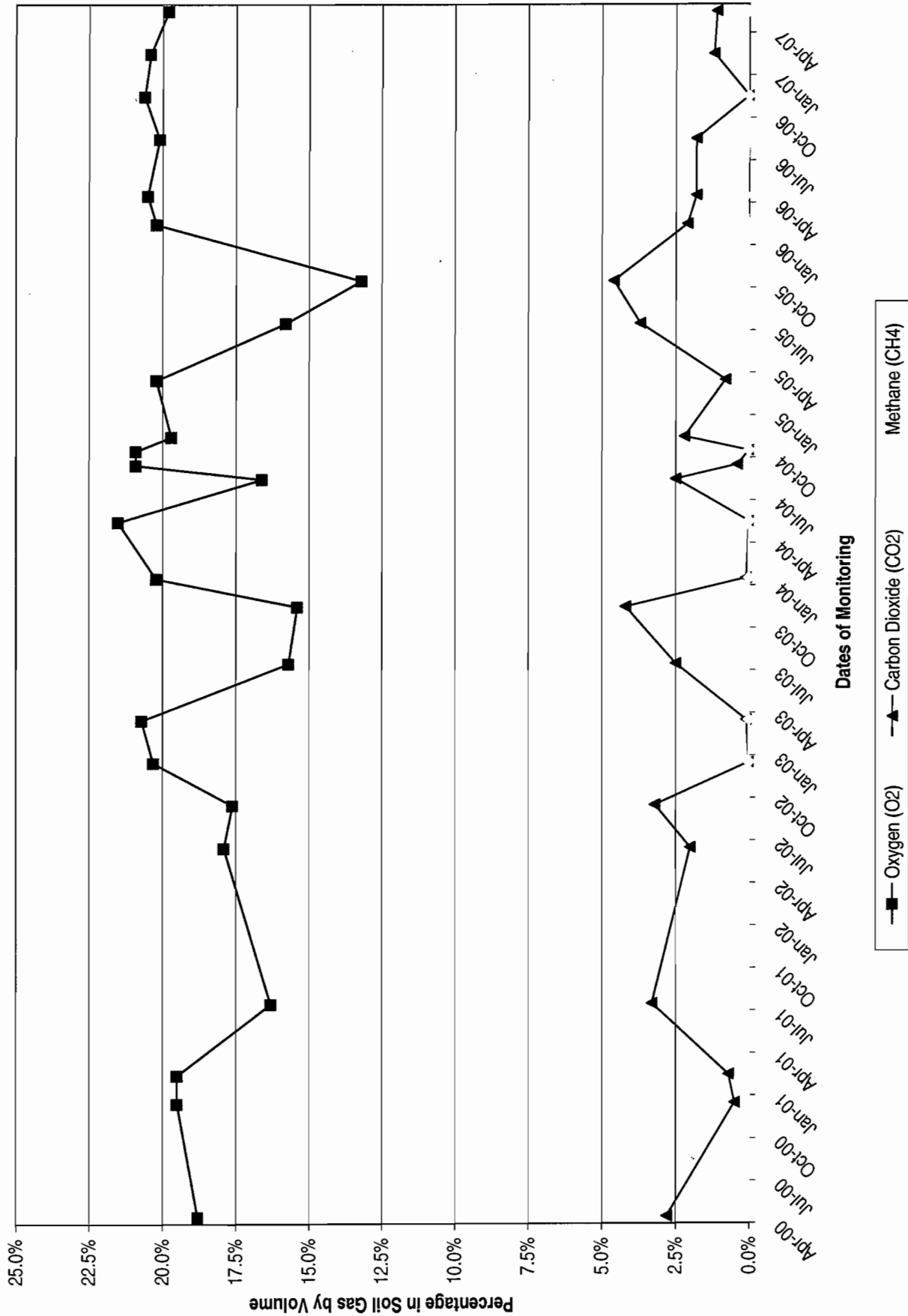

**Soil Gas Well EPL1**  
**Fluctuation in Methane, Oxygen, and Carbon Dioxide Percentages over Time**  
**Springfield Street School Complex**  
**Providence, Rhode Island**

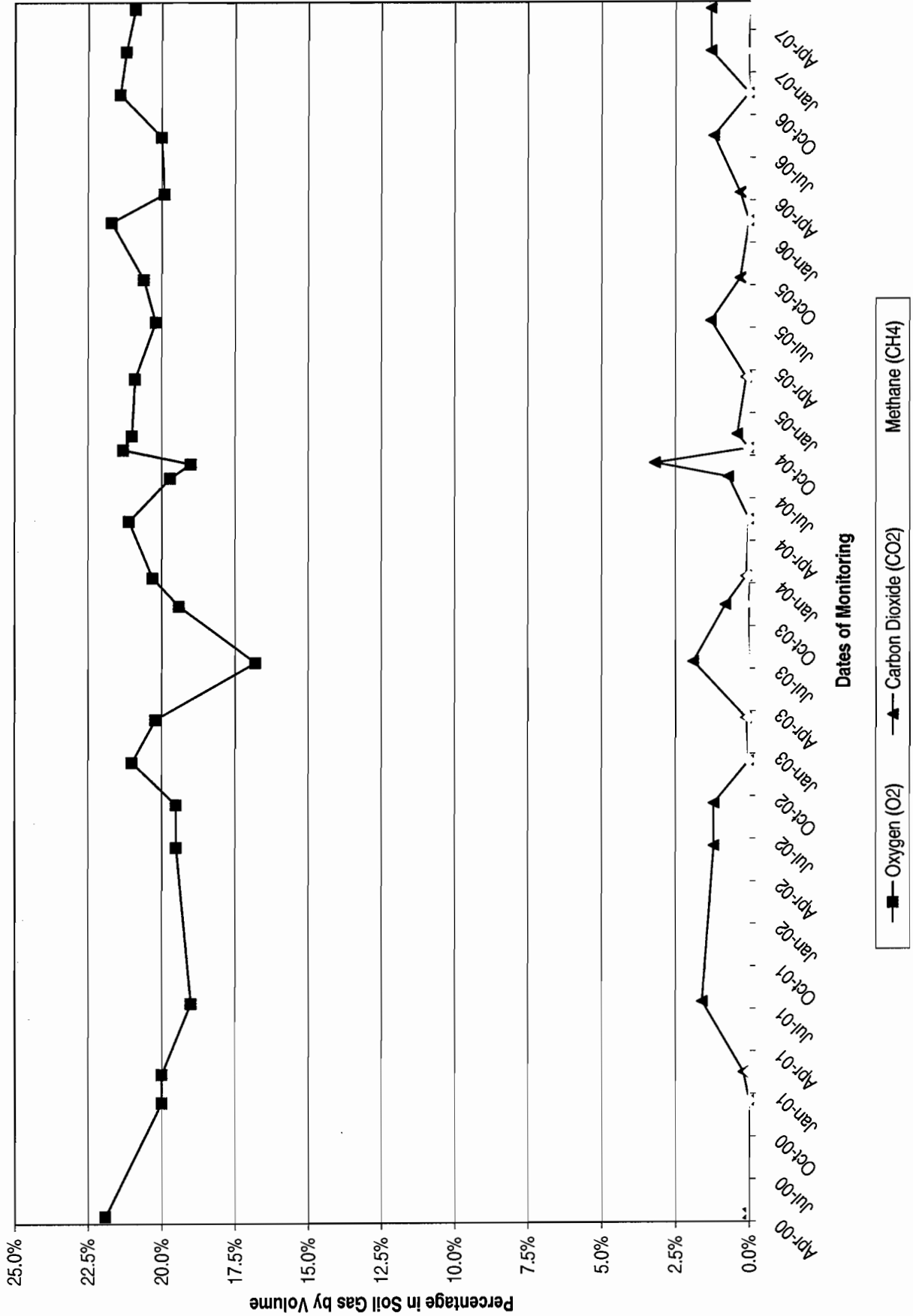

**Soil Gas Well EPL4**  
**Fluctuation in Methane, Oxygen, and Carbon Dioxide Percentages over Time**  
**Springfield Street School Complex**  
**Providence, Rhode Island**

